

B 1

CB450K1

CB450K2

INSTRUCTION 4 FOR USE OF PARTS LIST

DESCRIPTION OF PARTS LIST

CB450K1
CB450K2

1. Make-up of the Part Number

The following example is the definition of part number.

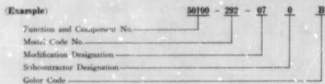

2. Abbreviations

The abbreviations used in this parts list are as follows.

ASSY.	Assembly
COMP.	Complete
loc.	local, original
22T	22 tree's

3. Dimensions

All dimensions are in millimeters except for the steel balls and washers.

Parts	Example	Interpretation
Bolt (Screw)	6x12	6 mm diameter, 12 mm length
Pin	8x14	8 mm diameter, 14 mm length
O-Ring	9.5x1.6	9.5 mm diameter, 1.6 mm thickness
Oil seal	14x24x5	14 mm inside diameter, 24 mm outside diameter, 5 mm thickness
Tube	5x135	5 mm inside diameter, 135 mm length

4. Quantity used

In the column "Reqt. No." is shown the quantity of parts used in the respective group.

5. Applicable Serial Number

If there is a production change to a part, the frame or the engine serial number to which this part become effective will be indicated in the "No. used on" column. However, in case the part is used from the initial serial number, its applicable serial number is not shown. The serial number for model is as follows.

CB450K1	Engine No. CB450E-3000001-
CB450K2	Engine No. CB450E-3000001-
CB450 PA II	Engine No. CB450E-3000001-
CB450K1	Frame No. CB450 -3000001-3000955
CB450K2	Frame No. CB450 -3000956-
CB450 PA II	Frame No. CB450 -3005534-

6. Color code

The following table indicates the color descriptions of the color codes which are listed in the text.

Color code	Color Description	Color code	Color Description
A	White	X J	Candy red
B	Black	X K	Candy blue
A Z	Candy blue green	X W	Chrome
CM	Can'ty ruby red	Z	Non sanding
C Q	Candy gold	A	Black (leather)

7. The part number described under the part description supersedes the part number ahead.

8. This Parts List is compiled as of April 30, 1976.

B 3

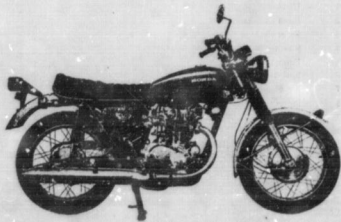
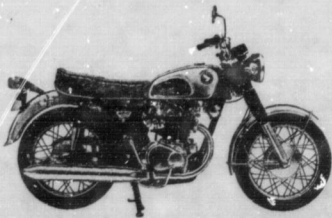
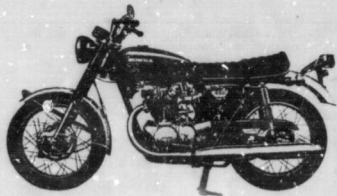
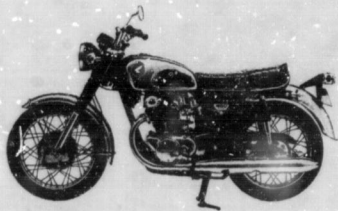

CB450 U.S.A. TYPE

PART NO. INDEX

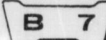

PART NO. INDEX

Part No.	Address No.	Part No.	Address No.	Part No.	Address No.	Part No.	Address No.	Part No.	Address No.	Part No.	Address No.
41105-292-670		81000 PARTS		88000 PARTS		60114-292-020	D 5	60481-292-000	C16	81255-292-003	D 9
41131-293-600R						60118-294-070	D 5	60482-294-000	C16		
41132-901-811						60119-293-000	E 0 2	60485-293-000	C16	81255-292-0-5	D11 9
41301-298-600R		81200-292-770	G 3	88110-240-000	D 5	60121-292-000	E 0 6	60481-299-000	C16	81255-992-005	D11
				88110-304-021	D 5	60123-292-000	E 0 8	60481-292-000	C16	81301-293-000	D 10
41301-298-600XJ		83000 PARTS		88120-735-000	D 5			60493-292-000	C16	81302-290-000	D 12
				88120-293-010	D 5	80123-292-780	D 0 8	60485-035-000	C16	81302-293-000	C 14
41301-298-600AK		83500-293-010A		88120-304-021	D 5	80124-292-000	D 0 6	60485-293-000	C16	81303-291-000	C 18
41301-298-600Z		83500-293-010Z		88120-395-300	D 5	80125-293-010	D 0 5	60512-293-000	C16	81304-703-000	D 8
41301-286-670AZ		83541-293-000A		88120-292-750	D 5	80127-293-000	D 0 8	60519-298-810	C16	81305-293-000	C 9
41301-286-670CX		83541-293-000Z		88122-295-000	D 5	80128-292-000	D 0 8	60515-298-810	C16	81305-293-000	C 9
41301-292-020AZ		83631-293-010		88126-292-300	D 5	80131-294-010	D 0 10	60521-292-000	C16	81307-293-0-0	C 8
				88130-292-751	D 5	80133-293-000	D 0 10	60523-293-000	C16	81308-273-000	C 9
41301-292-020R		84000 PARTS		88140-292-750	D 5	80154-298-670	F 1 1	60523-292-000	C16	81309-293-000	C 5
41301-292-020XJ				88151-298-000	D 5	80154-292-000	F 1 1	60528-292-000	C16	81310-292-000	C 5
				88152-292-000	D 5	80155-292-610	F 1 1	60528-292-303	C16	81314-220-000	C 6
41301-292-020XX		84101-292-751		88153-292-750	D 5	80155-292-010	F 1 3	60520-298-600	C16	81315-292-000	C 4
		84151-292-751		88155-292-780	D 5	80154-292-671	F 1 3	60532-292-000	C16	81316-292-000	C 9
41301-292-020YK		84152-292-751		88159-292-750A	D 5	80162-292-000	F 1 3	60536-292-303	C16		
		84701-292-020R		88163-292-750	D 5	80162-292-000	F 1 3	60535-292-000	C16		
41302-292-770A		84701-292-020Z		88166-292-750	D 5	80162-292-000	F 1 3	60543-293-000	C16	99000 PARTS	
41302-292-010		84701-292-020Z		88167-292-790	D 5	80165-292-000	F 1 3	60545-292-000	C16	99114-292-0380	D 3
41302-292-000		84701-292-600Z		88171-292-010	D 5	80165-292-000	F 1 3	60550-292-000	C16	99114-292-1300	D 4
41303-292-000		84701-292-610R		88172-292-770	D 5	80166-292-751	F 1 3	60555-293-000	C16	99124-292-0380	D 3
41304-292-000		84701-292-610Z				80167-300-000	F 1 3	60558-293-000	C16		
		84701-292-610Z		89000 PARTS		80169-292-751	F 1 3	60581-701-000	C16	99144-292-0380	D 3
		84701-292-610R		89010-292-600	F16	80167-300-000	F 1 3	60581-831-650	C16		
62000 PARTS		84701-292-750R		89011-293-000	F16	80167-300-000	F 1 3	60601-292-000	C16		
62501-292-750		84701-292-750Z		89020-293-000	F16	80171-292-000	F 1 3	60602-299-010	C16		
62501-292-810		84701-292-770A		89020-293-000	F16	80173-293-000	F 1 3	60603-200-000	C16		
		84705-292-000		89020-293-000	F16	80174-293-000	F 1 3	60604-292-000	C16		
				89021-293-000	F16	80174-293-000	F 1 3	60604-292-000	C16		
				89021-293-000	F16	80174-293-000	F 1 3	60605-293-000	C16		
77000 PARTS				89021-293-010	F16	80174-293-000	F 1 3	60607-293-000	C16		
77104-292-750				89021-293-010	F16	80174-293-000	F 1 3	60607-293-000	C16		
77200-292-020A		84706-296-000		89024-293-000	F16	80174-293-000	F 1 3	60607-293-000	C16		
77200-292-030A				89024-293-000	F16	80174-293-000	F 1 3	60607-293-000	C16		
77200-292-770A				89024-293-000	F16	80174-293-000	F 1 3	60607-293-000	C16		
77200-319-000A				89024-293-000	F16	80174-293-000	F 1 3	60607-293-000	C16		
77204-292-000				89024-293-000	F16	80174-293-000	F 1 3	60607-293-000	C16		
77205-292-000				89024-293-000	F16	80174-293-000	F 1 3	60607-293-000	C16		
77211-292-000		87000 PARTS		89024-293-000	F16	80174-293-000	F 1 3	60607-293-000	C16		
77211-292-000				89024-293-000	F16	80174-293-000	F 1 3	60607-293-000	C16		
77211-292-000				89024-293-000	F16	80174-293-000	F 1 3	60607-293-000	C16		
77211-292-000				89024-293-000	F16	80174-293-000	F 1 3	60607-293-000	C16		
77215-292-010A				89024-293-000	F16	80174-293-000	F 1 3	60607-293-000	C16		
77216-292-000				89024-293-000	F16	80174-293-000	F 1 3	60607-293-000	C16		
77230-292-000				89024-293-000	F16	80174-293-000	F 1 3	60607-293-000	C16		
				89024-293-000	F16	80174-293-000	F 1 3	60607-293-000	C16		
80000 PARTS				89024-293-000	F16	80174-293-000	F 1 3	60607-293-000	C16		
80100-292-010X				89024-293-000	F16	80174-293-000	F 1 3	60607-293-000	C16		
80100-292-010Z				89024-293-000	F16	80174-293-000	F 1 3	60607-293-000	C16		
80100-293-610X				89024-293-000	F16	80174-293-000	F 1 3	60607-293-000	C16		
80100-292-620X				89024-293-000	F16	80174-293-000	F 1 3	60607-293-000	C16		
80100-292-671X				89024-293-000	F16	80174-293-000	F 1 3	60607-293-000	C16		
80100-292-671Z				89024-293-000	F16	80174-293-000	F 1 3	60607-293-000	C16		
80100-292-750A				89024-293-000	F16	80174-293-000	F 1 3	60607-293-000	C16		
80102-292-670				89024-293-000	F16	80174-293-000	F 1 3	60607-293-000	C16		

CONTENTS

C 1

Ref. No.	Nomenclature	Address No.	Ref. No.	Nomenclature	Address No.
ENGINE GROUPS					
E - 1	Cylinder Head Cover	C 2, C 3	F - 15 (3)	Tail Light (Used in England)	F 6
E - 2	Cam Chain - Guide Roller	C 4	F - 15 (4)	Tail Light (Used in Germany & Sweden)	F 7
E - 7	Camshaft - Torsion Bar - Valve	C 5	F - 16	Wife Harness - Battery	F 8, F 9, F10
E - 4	Cyl. Air Head	C 6	F - 17	Main Switch - Stop	F11, F12
E - 5	Cylinder - Piston	C 7	F - 18	Frame	F13, F14, F15
E - 6	Right Crankcase Cover - Oil Filter	C 8	F - 19	Tool	F16
E - 7	Cutch - Oil Pump	C 9	F - 20	Optional Part	G 1
F - 8	Left Crankcase Cover - Drive Chain Cover	C10	F - 21	Handle (Police Type)	G 2
E - 9	Dynamo - Starting Motor	C11	F - 22	Seat Cushion (Police Type)	G 3
E - 10	Crankshaft	C12, C13	F - 23	Head Light - Standard (Police Type)	G 4
E - 11	Upper Crankcase	C14	F - 24	Bumper (Police Type)	G 5
E - 12	Under Crankcase	C15	F - 25	Patrol Light (Police Type)	G 6
E - 13	Transmission	C16	F - 21	Siren (Police Type)	G 7
E - 14	Shift Drum - Kick Starter	D 1, D 2			
E - 15	Right Carburetor (KEIHIN)	D 3			
E - 16	Left Carburetor (KEIHIN)	D 4			
FRAME GROUPS					
F - 1	Handle	D 5, D 6, D 7			
F - 2	Front Cushion	D 8, D 9			
F - 3	Front Cushion (Used in U.S.A.)	D10, D11			
F - 4	Steering Stem - Front Fender	D12, D13, D14			
F - 5	Front Wheel	D15, D16			
F - 6	Fuel Tank - Double Seat	E 1, E 2, E 3			
F - 7	Air Cleaner - Tool Box	E 4, E 5			
F - 8	Exhaust Muffler	E 6			
F - 9	Rear Wheel	E 7, E 8			
F - 10	Rear Cushion	E 9			
F - 11	Rear Fender - Rear Fork	E10, E11			
F - 1a	Speedometer	E12			
F - 13 (1)	Head Light (Used in U.S.A.)	E13			
F - 13 (2)	Head Light (Used in General & Australia)	E14			
F - 13 (3)	Head Light (Used in France)	E15			
F - 13 (4)	Head Light (Used in Germany, England & Sweden)	E16			
F - 14 (1)	Winker (Used in U.S.A., General, France, England & Australia)	F 1, F 2			
F - 14 (2)	Winker (Used in Germany & Sweden)	F 3			
F - 15 (1)	Tail Light (Used in U.S.A., France, General & Australia)	F 4			
F - 15 (2)	Tail Light (Used in U.S.A.)	F 5			

E-8 Left Crankcase Cover - Drive Chain Cover

C 10

E-8 Left Crankcase Cover - Drive Chain Cover

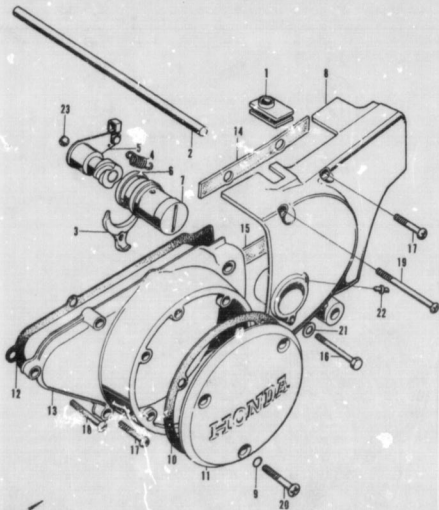

Ref. No.	Part No.	Description	Reqd. No. 13 1143 08 P4 II	No. Used on	
				From	To
1	22875-283-000	JOINT, clutch wire	1	1	
2	22850-292-030	ROD, clutch lifter	1	1	
3	22844-200-000	PIECE, clutch adjuster fitting	1	1	
4	22815-283-000	SPRING, clutch lever	1	1	
5	22810-283-000	THREAD, clutch lever	1	1	
6	91205-200-000	OIL-SEAL, 22x26x29x8	1	1	
7	22841-286-000	ADJUSTER, clutch	1	1	
8	11660-292-030	COVER, drive chain	1	1	
9	91201-283-000	O-RING, 5x2.4	3	3	
10	11681-283-000	GASKET, dynamo cover	1	1	
11	11431-283-000	COVER, dynamo (Superseded by 11431-319-000)	1	1	
	11431-319-000	COVER, dynamo	1	-	
12	11385-283-000	GASKET, left crankcase cover	1	1	
13	11341-282-000	COVER, left crankcase	1	1	
14	11682-319-000	GASKET A, drive chain cover	1	-	CB49E-302754
15	11-83-319-000	GASKET B, drive chain cover	1	-	CB49E-302754
16	93000-06045	BOLT, hex., 6x45	1	1	
17	93000-06054	SCREW, pan., 6x38	6	6	
18	93000-06036	SCREW, pan., 6x36	2	2	
19	93000-06063	SCREW, pan., 6x53	2	2	
20	93700-06045	SCREW oval, 6x45	3	3	
21	94101-06000	WASHER, plain, 6mm	1	1	
22	96201-30000	NIPPLE, grease	1	1	
23	96211-10000	BALL, steel, #10	1	1	

E-9 Dynamac Starting Motor

C 11

E-9 Dynamac Starting Motor

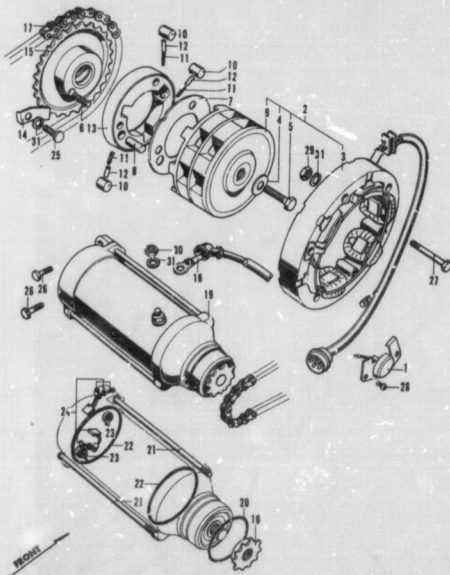

Ref. No.	Part No.	Description	Reqd. No.	No. Used on	
			18 1168 49 F1 II	From	To
1	30790-283-000	SWITCH ASSY, neutral	1	1	
2	31100-292-023	GENERATOR ASSY, A.C. rotor (KOKUSAN)	1	-	
3	31100-292-013	STATOR (KOKUSAN)	1	-	
4	31106-283-000	WASHER	1	-	-3003374
5	31104-283-000	BOLT, set	1	-	-3003374
	90014-286-000	BOLT, rotor set	1	1	CB40E-3003375
6	90091-292-000	SCREW, flat, 6x20	3	3	
7	28128-283-010	PLATE, starting clutch side	1	1	
8	90712-300-010	PIN, knock, 8x18	1	1	
9	31101-292-003	ROTOR (KOKUSAN)	1	-	
10	91193-289-000	ROLLER, 13.2x11.5	3	3	
11	28125-283-010	SPRING, starting clutch roller	3	3	
12	28126-292-001	CAP, starting clutch roller spring	3	3	
13	28120-292-000	OUTER, starting clutch	1	1	
14	28117-292-000	PLATE, starting sprocket setting	1	1	
15	28110-292-000	SPROCKET, starting (DK219, 27T)	1	1	
16	31202-300-154	SPROCKET, starting motor (DK218, 17T) (MITSUBA)	1	1	
17	28101-283-000	CHAIN, starting (DK219-28L) (DAIDO)	1	1	
18	32411-283-000	CABLE, starting motor	1	1	
19	31200-292-158	MOTOR ASSY, starting (MITSUBA)	1	1	
20	91309-283-000	O-RING, 42.5x2	1	1	
21	31276-292-158	BOLT, setting gear cover (MITSUBA)	2	2	
22	31266-292-158	O-RING (MITSUBA)	2	2	
23	31204-292-158	SPRING, carbon brush (MITSUBA)	2	2	
24	31201-292-158	BRUSH-SET, carbon (MITSUBA)	1	1	
25	90090-06017	BOLT, hex, 6x12	1	1	
26	90090-06020	BOLT, hex, 6x20	2	2	
27	90090-06036	BOLT, hex, 6x36	3	3	
28	90090-06010	SCREW, pan, 6x10	2	2	
29	94001-06000	NUT, hex, 6 mm	2	2	
30	94002-06000	NUT, thin, 6 mm	1	1	
31	94111-06000	WASHER, spring, 6 mm	5	5	
32	31100-292-071	GENERATOR ASSY, A.C. rotor	-	1	CB40E-3003389
33	31102-292-071	STATOR COMP.	-	1	CB40E-3003389
34	31101-292-070	ROTOR COMP.	-	1	CB40E-3003389

E-10 Crankshaft

C 12

E-10 Crankshaft

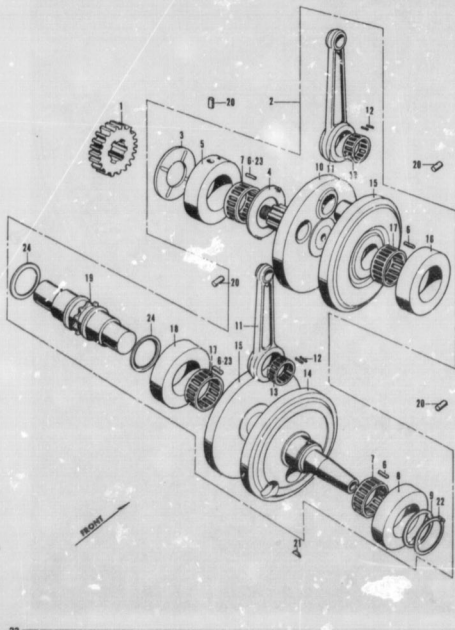

Ref. No.	Part No.	Description	Engl. No.		To Used on	
			11 210	28 F1 B	From	To
1	13611-290-010	GEAR, primary drive (2T)	1	1		
2	13000-290-671	CRANKSHAFT COMP.				
		(Superseded by 13000-290-304)				
	13000-290-304	CRANKSHAFT COMP.	1	-		-700918
		(Superseded by 13000-290-673 with 15450-292-000 & 15441-292-000)				
	13000-290-673	CRANKSHAFT COMP.	1	1	CB450E-3000619 - 310802	
	13000-290-674	CRANKSHAFT COMP.				
		(Superseded by 13000-292-676)				
	13000-292-676	CRANKSHAFT COMP.	1	1	CB450E-3710803	
3	90456-292-030	WASHER B, thrust, 25 mm	1	1		
4	90455-292-010	WASHER C, thrust, 32 mm	1	-		-3001175
	90455-292-020	WASHER C, thrust, 34 mm	1	1	CB450E-3004106	
5	13411-292-340	RACE, outer, right crank bearing	1	-		-3004115
	13411-292-360	RACE, outer, right crank bearing	1	1	CB450E-3004106	
6	91102-283-000	ROLLER, 5x13	64	-		-3000460
	91102-290-008	ROLLER, 5x13	64	-	CB450E-3000461 - 3004103	
		(Change to req'd No.)	64	34	CB450E-3004106	
7	13471-283-000	RETAINER, roller, main bearing	2	-		-3004105
	13473-290-000	RETAINER B, roller, main bearing	1	1	CB450E-3004106	
8	13421-292-310	RACE, outer, left crank bearing	1	-		-3004105
	13c11-290-330	RACE, outer left crank bearing	1	1	CB450E-3004106	
	90454-283-010	WASHER B, thrust, 32 mm	1	-		-3001175
	90454-292-000	WASHER B, thrust, 34 mm	1	1	CB450E-3004106 - 3000802	
	90454-292-010	WASHER B, thrust, 34 mm	1	1	CB450E-3108023	
10	13311-292-670	CRANKSHAFT, right	1	-		-3000818
	13311-290-671	CRANKSHAFT, right	1	-	CB-50E-3000619 - 3001125	
	96-672	CRANKSHAFT, right	1	-	CB450E-3001126 - 3004105	
	13311-292-675	CRANKSHAFT, right	1	1	CB450E-3004106	
11	13201-290-300	ROD, connecting				
		(Superseded by 13201-292-020)				
	13201-292-330	ROD, connecting	5	2		
12	91101-283-000	ROLLER, 1.9x12.5	44	44		
13	13211-283-000	RETAINER, roller, connecting rod	2	2		
14	13321-292-670	CRANKSHAFT, left	1	-		-3001125
	13321-292-671	CRANKSHAFT, left	1	-	CB450E-3001126 - 3004105	
	13321-292-673	CRANKSHAFT, left	1	1	CB450E-3004106	

E-10 Crankshaft

C 13

E-10 Crankshaft

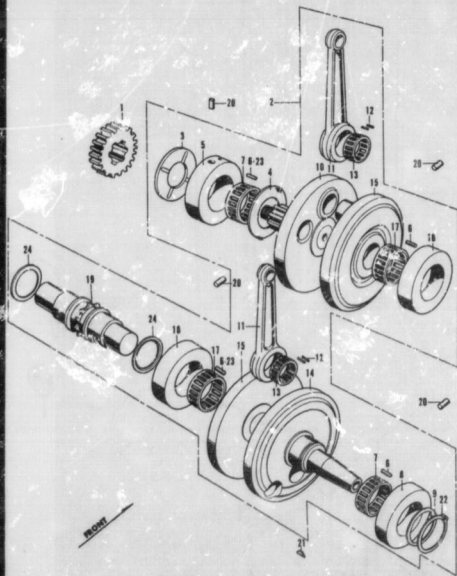

Ref. No.	Part No.	Description	Expl. No. 11 1123 08 14 II	No. Used on	
				From	To
15	1330-290-670	WEIGHT, center crank	2	-	~3001125
	1330-290-671	WEIGHT, center crank (Superseded by 1330-290-672)			
	1700-290-673	WEIGHT, center crank	2	2	Cb45E-3991135 ~ 3004105
	1330-290-674	WEIGHT, center crank	2	2	Cb45E-3004105
16	13431-290-310	RACE, outer CR. crank bearing	1	-	~3004105
	13431-290-310	RACE, outer CR. crank bearing	1	1	Cb45E-3004105
17	13481-290-000	RETAINER, roller, center bearing	2	-	~3004105
	13471-290-000	RETAINER, roller, main bearing	2	2	Cb45E-3 004105
18	13441-290-310	RACE, outer, CL. crank bearing	1	-	~3001105
	13441-290-310	RACE, outer, CL. crank bearing	1	1	Cb45E-3004105
19	13381-290-300	CRANKSHAFT, center (Superseded by 1331-290-320)			~3004105
	1301-290-310	CRANKSHAFT, center	1	-	~3004105
	13381-290-310	CRANKSHAFT, center	1	1	Cb45E-3004105
20	94002-0-100	PIN, knock, 6x10B	4	4	Cb45E ~3020124
	90713-319-000	PIN, right crank bear.-g. knock	1	-	Cb45E-3020125
21	94401-25140	KEY, woodruff, 25x14	1	1	
	94510-32000	CR-CLIP, external, 2mm	1	-	
	94510-34000	CR-CLIP, external, 4mm	1	1	
22	91103-290-000	ROLLER, 6x13	32	32	Cb45E-3004105
24	90483-290-000	WASHER D, thrust, 32mm	2	2	Cb45E-3004105

E-11 Upper Crankcase

C 14

E-11 Upper Crankcase

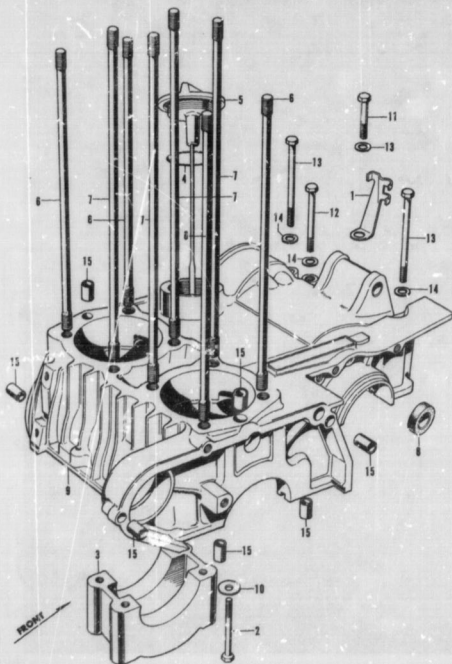

Ref. No.	Part No.	Description	Reqd. No. 12 1160 62 7131	No. Used on	
				From	To
1	3291-283-00	CLAMPER, dynamic cord	1	1	
2	9008-292-00	BOLT, hex, 8x71	4	4	
3	121-292-020	CAP, bearing, center	1	1	
4	91303-283-000	O-RING, 37.2x2.3	1	1	
5	15650-292-000	GAUGE, oil level	1	1	
6	90031-292-000	BOLT A, cylinder stud	4	4	
7	90032-292-000	BOLT B, cylinder stud	4	4	
8	91201-292-003	OIL-SEAL, 12x25x4.5 (ARAD)	1	1	
9	11100-292-080	CRANKCASE, upper	1	1	CB430E- -0000234
	11100-319-000	CRANKCASE, upper	-	-	CB430E-0000325
10	90401-822-000	WASHER, head, 8 mm	4	4	
11	92000-06040	BOLT, hex, 6x40	1	1	
12	92000-06063	BOLT, hex, 6x63	1	1	
13	92000-06080	BOLT, hex, 6x80	5	2	
14	94101-06000	WASHER, plain, 6 mm	4	4	
15	94301-10140	PIN, knock, 10x14A	6	6	

E-12 Under Crankcase

C 15

E-12 Under Crankcase

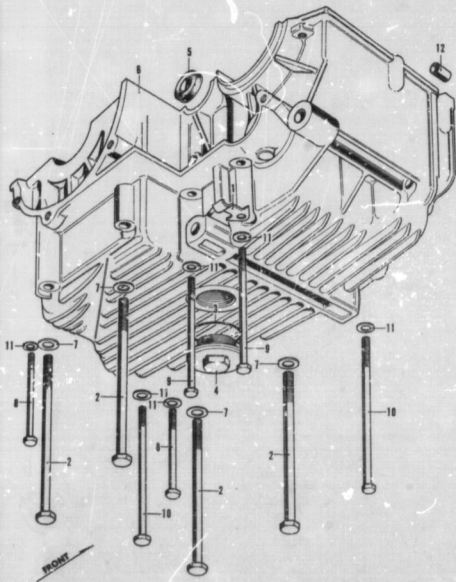

Ref. No.	Part No.	Description	Reqd. No. 11 1102 09 71 1	No. Used on	
				From	To
1	32911-283-000	CLAMP-ER, motor cable	1	1	
2	90985-292-000	BOLT, hex, 8x132	4	4	
3	91302-600-000	O-RING, 33.5x3	1	1	
4	90013-283-000	BOLT, drain, cock (Superseded by 90013-312-000)	1	1	
	90013-312-000	BOLT, drain, cock	1	-	
5	91201-292-000	OIL SEAL, 12x28x4.5 (ARAD)	1	1	
6	11200-292-070	CRANKCASE, lower	1	1	-3004195
	11200-292-080	CRANKCASE, lower	1	1	978-3004195
7	91615-822-000	WASHER, head, 8 mm.	4	4	
8	90000-00380	BOLT, hex, 6x80	3	3	
9	90000-00390	BOLT, hex, 6x90	2	2	
10	90000-02125	BOLT, hex, 6x125	2	2	
11	94101-06000	WASHER, plain, 6 mm.	7	7	
12	94301-10140	PIN, knock, 10x14/.	2	2	

E-13 Transmission

C 16

E-13 Transmission

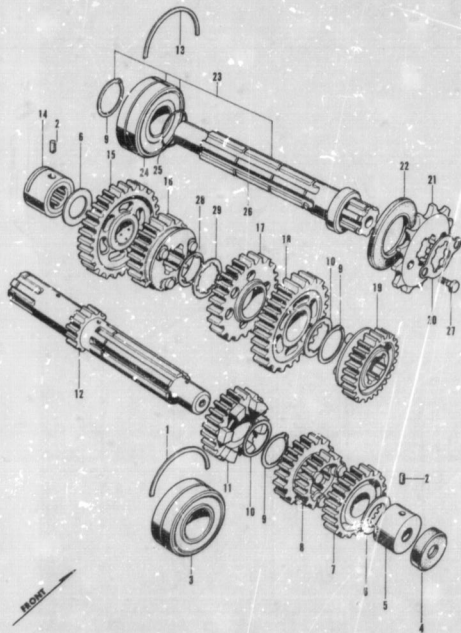

Ref. No.	Part No.	Description	Repl. No.	No. Used on	
			13 2168 08 14 0	From	To
1	13400-283-000	RD-G, bearing setting, 52 mm		1	1
2	24051-283-400	PIN, gear shift fork guide		2	2
3	91001-283-062	BEARING, ball, 52x115 (NACHI)		1	1
4	91200-292-070	OIL-SEAL, 4x34x8 (ARAI)		1	1
5	91200-292-076	OIL-SEAL, 8x34x8 (N.O.K.)		1	1
6	23031-292-000	BEARING, main shaft		1	1
7	90460-292-000	WASHER, thrust, 20 mm		2	2
8	23401-292-030	GEAR, 6th, main shaft (30T)		1	1
9	23431-292-000	GEAR, second third, main shaft (22T-36T)		1	1
10	90602-293-010	CIR-CLAI, 18 mm		4	4
11	90451-283-000	WASHER, thrust, 25 mm (Superseal by 90451-296-000)			
	90C1-286-000	WASHER A, thrust, 25 mm		3	3
12	23471-292-030	GEAR, fourth main shaft (29T)		1	1
13	23211-292-040	SHAFT, main transmission		1	1
14	13401-284-000	XING, bearing setting, 57 mm		1	1
15	23032-292-000	BEARING, counter shaft		1	1
16	23421-292-010	GEAR, first counter shaft (41T)		1	1
17	23481-292-030	GEAR, fourth counter shaft (29T)		1	1
18	23461-292-030	GEAR, third counter shaft (37T)		1	1
19	23441-292-040	GEAR, second counter shaft (36T)		1	1
20	23411-292-040	GEAR, first counter shaft (36T)		1	1
21	23011-292-040	GEAR, 6th counter shaft (27T)		1	1
22	23011-292-000	PLATE, drive sprocket: fixing		1	1
23	23804-222-000	SPROCKET, drive, (15T)		1	1
24	23803-292-010	SPROCKET, drive (Optional part 16T)		2	2
25	91200-283-010	OIL-SEAL, 33x57x7		1	1
26	23220-292-040	SHAFT COMP., counter transmission		1	1
27	23220-292-000	SHAFT COMP., counter transmission		1	1
28	91000-283-003	BEARING, special ball, 33x55 (NACHI)		1	1
29	91346-703-000	O-RING, 24.5 mm		1	1
30	20221-292-340	5.AFT., counter transmission		1	1
31	20221-292-300	SHAFT, counter transmission		1	1
32	90937-06012	BOLT, hex., 6x12		2	2
33	90462-286-000	WASHER, lock, 25 mm		1	1
34	90461-286-000	WASHER B, thrust, 25 mm		1	1

E-1 Cylinder Head Cover

C 2

E-1 Cylinder Head Cover

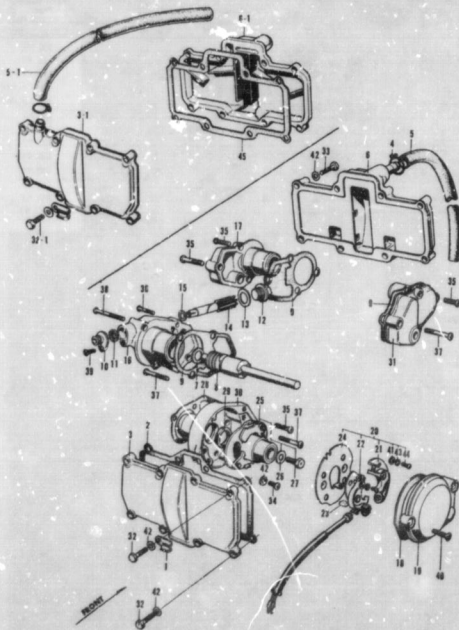

Ref. No.	Part No.	Description	Reqd. No.		No. Used on	
			11	1140	From	To
1	32901-283-002	CLAMP&X, point cord	1	1		
2	12393-283-010	GASK&T B, cylinder head cover	1	-		~3000542
		GASK&T B, cylinder head cover	1	1	CB450E-3002386	
3	12321-283-010	COVER B, cylinder head	1	-		~3000542
3-1	12321-292-000	COVER B ASSY, cylinder head (Superseded by 12321-292-030)	1	-		
	12321-292-030	COVER B, cylinder head	1	-	CB450E-3000543-3002386	
	12321-292-030	COVER B, cylinder head	1	1	C-443CE-3002386	
4	15772-292-010	CLIP, breather tube	1	1		
5	15761-292-010	TUBE, breather (Superseded by 15761-292-030)	1	-		~3000542
		TUBE, breather	1	1	CB450E-3002386-3002386	
5-1	15761-292-030	TUBE, breather	1	-	CB450E-3000543-3002386	
	15761-292-030	TUBE, breather	1	-	CB450E-3002327	
6	12311-302-030	COVER A COMP, cylinder head	1	-		~3000542
6-1	12311-292-303	COVER A, cylinder head	1	-	CB450E-3000543-3002386	
	12311-292-030	COVER A COMP, cylinder head	1	1	CB450E-3002386	
7	90453-283-000	WASHER, thrust, 10 mm	1	1		
8	12420-292-000	PINION, tachometer	1	1		
9	12394-283-000	GASK&T, cylinder head side cover	2	2		
10	12451-283-000	CAP A, tachometer	1	1		
11	91207-222-000	OIL-SEAL, 7x14.5x5	1	1		
12	90080-283-000	BOLT, sealing, 16 mm	1	1		
13	90443-283-000	WASHER, sealing, 16 mm	1	1		
14	12431-283-000	GEAR, tachometer	1	-		~3000257
	12431-292-000	GEAR, tachometer	1	1	CB450E-3000358	
15	90453-216-810	WASHER, thrust, 7 mm	1	-		~3000257
	90453-292-040	WASHER, thrust, 7 mm	1	1	CB450E-3000358	
16	12411-292-000	BOX, tachometer gear	1	-		~3000257
	12421-292-010	BOX, tachometer gear	1	1	CB450E-3000358	
17	12321-292-010	COVER, cylinder head right side	1	1		
18	30091-283-010	GASK&T, point cover	1	1		
19	30171-283-010	COVER, point	1	1		
20	30000-790-071	BREAK&R ASSY, contact (KOKUSAN)	1	1		
21	30035-292-003	BREAK&R, contact, right (KOKUSAN)	1	1		
22	77054-282-003	BREAK&R, contact, left (KOKUSAN)	1	1		
23	30355-292-000	FELT, oil (KOKUSAN)	1	1		

E-1 Cylinder Head Cover

C 3

E-1 Cylinder Head Cover

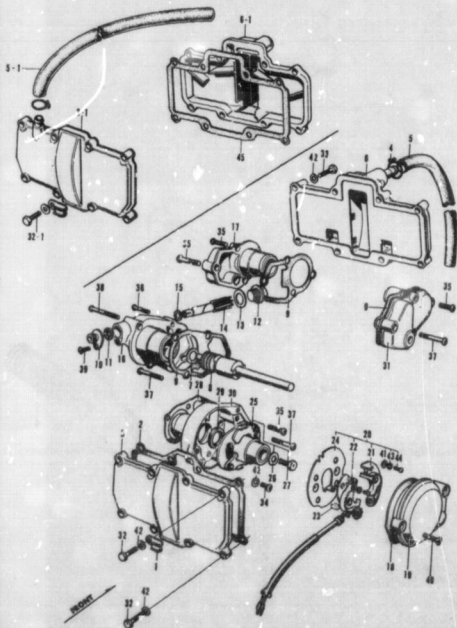

Qty. No.	Part No.	Description	Reqd. In 60 1808 OR 71 II	No. Used on	
				From	To
26	30261-283-003	PLATE, contact breaker base (KOKUBAN)	1	3	
26	30220-292-070	// ADVANCER ASSY, spark (KOKUBAN)	1	1	
26	90463-292-000	WASHER, setting, spark advancer	1	1	
27	90086-292-001	BOLT, setting, spark advancer	1	1	
28	30392-283-000	GASKET, point base	1	1	
29	91203-283-000	OIL-SEAL, 18x28x6 (ARA)			
		(Superseded by 91203-283-013)			
	91203-292-005	OIL-SEAL, 18x28x6 (N.O.K.)			
		(Superseded by 91203-292-015)			
	91203-283-013	OIL-SEAL, 18x28x6 (ARA)	1	1	
	91203-292-015	OIL-SEAL, 18x28x6 (N.O.K.)	1	1	
30	30361-292-000	BASE, point	1	1	
31	12341-292-000	COVER, cylinder head left side	1	1	
32	92900-00025	BOLT, hex, 6x25	8	-	
32-1	92900-00032	BOLT, hex, 6x22	8	8	
32	92900-00028	BOLT, hex, 6x28	8	8	
34	93000-00010	SCREW, pan, 6x10	2	2	
35	93000-00027	SCREW, pan, 6x22	8	8	
36	93000-00038	SCREW, pan, 6x26	1	1	
37	93000-00036	SCREW, pan, 6x36	2	2	
38	93000-00047	SCREW, pan, 6x40	1	1	
39	93000-00012-CA	SCREW, flat, 6x12	1	1	
40	93700-00025	SCREW, oval, 6x25	2	2	
41	94111-04000	WASHER, plain, 4 mm	4	4	
42	94101-00000	WASHER, plain, 6 mm	18	18	
43	94111-04050	WASHER, spring, 4 mm	4	4	
44	96000-64005-CA	SCREW, pan, hollow, 4x5	4	4	
45	12316-283-010	GASKET A, cylinder head cover	1	-	

CH40E-300543-300238

E-2 Cam Chain - Guide Roller

C 4

E-2 Cam Chain - Guide Roller

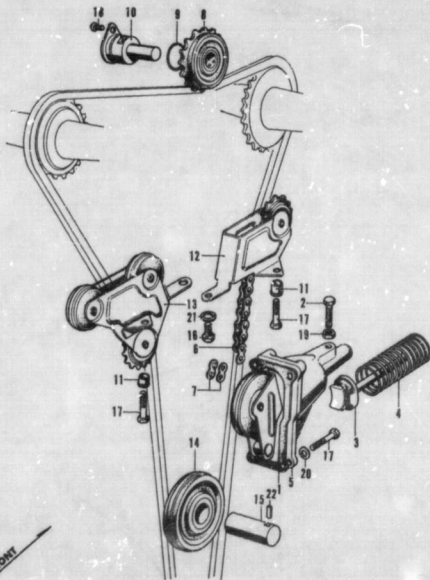

Ref. No.	Part No.	Description	Reqd. No. 21 2108 02 71 1	No. Used on	
				From	To
1	14591-283-000	GASKET, cam chain tensioner	1	1	
2	90909-250-000	BOLT, tensioner adjusting	1	1	
3	14550-283-000	BAR, push	1	1	
4	14541-283-000	SPRING, tensioner	1	1	
5	14590-292-000	TENSIONER, cam chain	1	1	
6	14401-283-000	CHAIN, cam (DK219-64L)	1	1	
7	14410-283-000	J'INT, cam chain (DK219)	1	1	
8	14540-283-000	ROLLER, cam chain guide	1	1	
9	91314-220-000	O-RING, 16.4x2.4	1	1	
10	14545-283-010	PIN A, cam chain guide roller	1	1	
11	14605-283-000	PIN, knock roller stay	4	4	
12	14650-292-000	ROLLER, rear cam chain guide	1	1	
13	14610-292-000	ROLLER, front cam chain guide	1	1	
14	14630-292-000	ROLLER B, cam chain guide	1	1	
15	14635-283-000	PIN B, cam chain guide roller	1	1	
16	93900-06016	BOLT, hex., 6x16	1	1	
17	93900-06025	BOLT, hex., 6x25	4	4	
18	93900-06010	SCREW, pan, 6x10	1	1	
19	94301-00000	NUT, hex., 6 mm	1	1	
20	94101-00000	WASHER, plain, 6 mm	4	4	
21	94111-00000	WASHER, spring, 6 mm	1	1	
22	94302-04080	PIN, knock, 4x80	1	1	

E-3 Camshaft · Torsion Bar · Valve

C 5

E-3 Camshaft · Torsion Bar · Valve

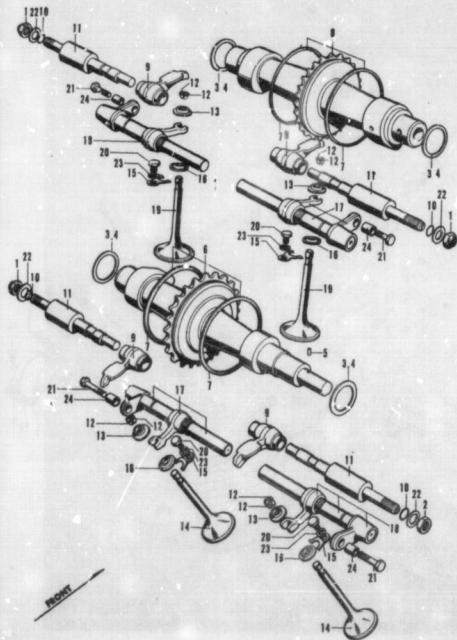

Ref. No.	Part No.	Description	Exp. No.	No. Used on	
			51 1143 25 Fl. 2	From	To
1	90011-283-000	NUT, lock, cam follower shaft	3	3	
2	90012-283-000	NUT B, lock, cam follower shaft	1	1	
3	14294-283-000	SPACER, camshaft (3.1 mm)	(8-2)		
4	14295-283-000	SPACER, camshaft (5.2 mm)	(8-2)		
5	90761-283-000	PIN, knock, 3x6.8	1	1	
6	14120-283-010	CAMSHAFT, exhaust	1	1	
7	14116-283-300	RING, cam chain damper	4	4	
8	14119-292-670	CAMSHAFT, inlet	1	1	
9	14431-292-010	FOLLOWER, cam	4	4	
10	91308-283-000	O-RING, 7.5x2.2	4	4	
11	14451-292-000	SHAFT, cam follower	4	4	
12	14791-292-000	COTTER, valve	8	8	
13	14771-283-305	RETAINER, valve spring	4	4	
14	14721-292-000	VALVE, exhaust	2	2	
	14721-292-010	VALVE, exhaust	2	2	
15	12293-283-010	STOPPER, valve guide	4	4	
					-3000448
					CB450E-3000449
16	14791-292-000	CAP, valve guide seal	4	4	
17	14760-292-000	SPRING B ASSY, torsion bar valve	2	2	
18	14760-292-000	SPRING A ASSY, torsion bar valve	2	2	
19	14711-292-000	VALVE, inlet	2	2	
20	93005-06012	BOLT, hex, 6x12	4	4	
21	93000-06028	BOLT, hex, 6x28	4	4	
22	94301-08300	WASHER, plain, 8 mm	4	4	
23	94311-06000	WASHER, spring, 6 mm	4	4	
24	94303-08120	PIN, knock, 8x12A	4	4	

E-4 Cylinder Head

C 6

E-4 Cylinder Head

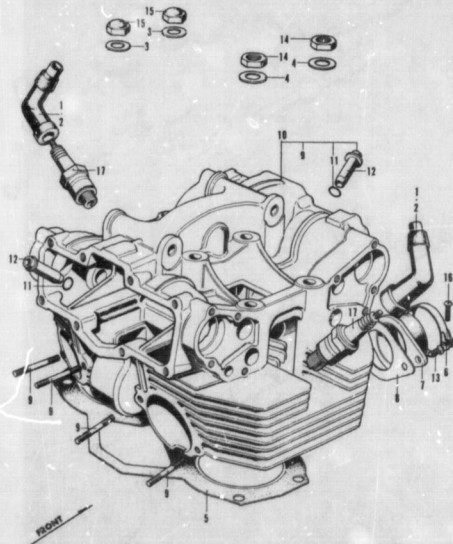

Ref. No.	Part No.	Description	Req. No. 17 1148 48 11 8	No. Used on	
				From	To
1	3070-292-000	CAP ASSY, noise suppressor	2	2	
2	3070-292-610	CAP ASSY, noise suppressor (Not used in U.S.A.)	2	2	
3	9044-283-000	WASHER, sealing, 10 mm	2	2	
4	9042-283-000	WASHER fl, sealing, 10 mm	6	6	
5	12281-283-0-0	GASKET, cylinder head	1	1	
6	16223-283-000	BAND, carburetor insulator	2	2	
7	16211-283-000	INSULATOR, carburetor	2	2	
8	16229-283-010	GASKET, carburetor insulator	2	2	
9	90041-283-000	BOLT, alignment stud, 6x51	4	-	
		(Superseded by 90061-286-305)			
	90061-286-305	BOLT, stud, 6x48	4	-	-3000535
	90061-286-000	BOLT, stud, 6x52	4	-	CB40E-3000536-3002257
	92770-08036-05	BOLT, stud, 8x56	4	4	CB40E-3002258
10	12200-292-050	HEAD ASSY, cylinder	1	-	-3000448
	12200-2-000	HEAD ASSY, cylinder (Sup. ver. by 12200-292-070)			
	12200-292-070	HEAD ASS Y, cylinder	1	1	CB40E-3000449-3002257
	12200-292-080	HEAD ASSY, cylinder	1	1	CB40E-3002258
11	12309-283-000	O-RING, 12x1	4	4	
12	12021-292-300	GUIDE, valve	4	4	
13	92005-06016	BOLT, hex., 6x16	4	4	
14	94001-10000	NUT, hex., 10 mm	6	6	
15	94021-10000	NUT, hex., cap, 10 mm	2	2	
16	93900-05016-0A	SCREW, pan, 5x16	2	2	
17	98079-54810	PLUG, sparking (P-4E)	2	2	
	98079-50910	PLUG, sparking (B-4E)	2	2	
	98079-67810	PLUG, sparking (B-7ES)	2	2	
	98079-50810	PLUG, sparking (B-8ES) (S.T.D.)	2	2	
	98079-50910	PLUG, sparking (B-9E)	2	2	
	98079-60810	PLUG, sparking (B-10E)	2	2	

E-5 Cylinder - Piston

C 7

E-5 Cylinder - Piston

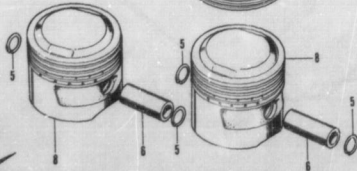
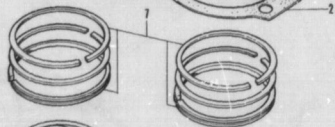
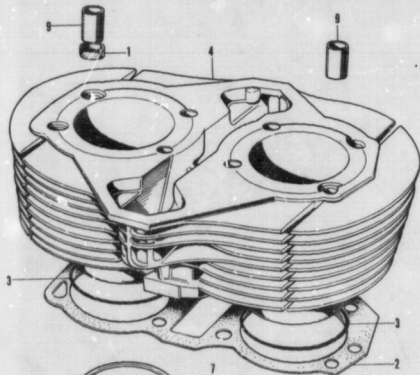

Ref. No.	Part No.	Description	Ref. No. 81 1149 68 14 11	No. Used on	
				From	To
1	1299-283-000	GASKET, cylinder stud	2	2	
2	12191-283-010	GASKET, cylinder	1	1	
3	91300-283-000	O-RING, 75.8 x 2	2	2	
4	12100-292-000	CYLINDER	1	1	
5	1311A-28, 0A0	piston pin	4	4	
6	13111-283-000	PIN, piston	2	2	
7	13011-292-000	RING-SET, piston (S.T.D.)	1	1	
	13021-292-000	RING-SET, piston (0.25)	1	1	
	13031-292-000	RING-SET, piston (0.50)	1	1	
	13041-292-000	RING-SET, piston (0.75)	1	1	
	13051-292-000	RING-SET, piston (1.00)	1	1	
8	13101-292-030	PISTON (S.T.D.)	2	2	
	13102-292-030	PISTON (0.25)	2	2	
	13103-292-030	PISTON (0.50)	2	2	
	13104-292-030	PISTON (0.75)	2	2	
	13105-292-030	PISTON (1.00)	2	2	
9	94301-12240	PIN A, knock, 12 x 24	3	3	

E-6 Right Crankcase Cover - Oil Filter

C 8

E-6 Right Crankcase Cover - Oil Filter

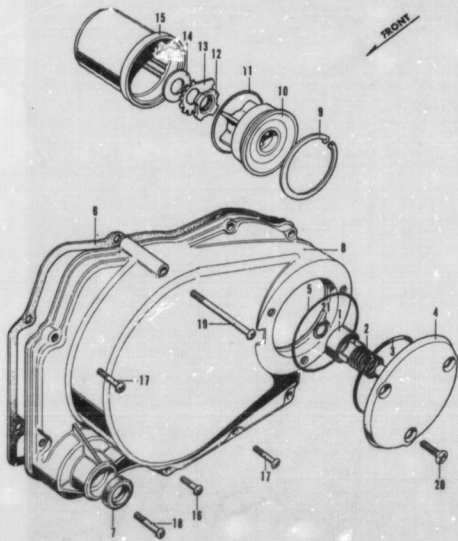

Ref. No.	Part No.	Description	Evol. No.		No. Used on	
			41 1348 08 P1 II	42 P1 II	Press	To
1	15894-292-00C	METAL, oil guide	1	1	*	
2	15905-292-000	SPRING, oil guide metal	1	1		
3	91305-283-000	O-RING, 58x2.4	1	1		
4	15481-292-010	COVER, oil filter	1	1		
5	15489-283-010	O-RING, 63 mm	1	1		
6	11394-292-000	GASKET, right crankcase cover	1	1		
7	91304-283-000	OIL-SEAL, 17x29x7	1	1		
8	11330-292-000	COVER, right crankcase	1	1		
9	90604-292-000	CIR-CLIP, internal, 43 mm	1	1		
10	15450-292-030	CAP, oil filter	1			-300018
	15450-292-030	(Superseded by 15450-292-040)				
	15450-292-040	CAP, oil filter	1	1		CB400E-300019
11	91310-292-000	O-RING, 41x2	1	1		
12	90231-292-000	NUT, lock, 16 mm	1	1		
13	90437-292-000	WASHER, lock, 16 mm	1	1		
14	90481-292-000	WASHER, lock, oil filter rotor	1	1		
15	15441-292-030	ROTOR, oil filter	1	-		-300018
	15441-292-030		1	1		CB400E-300019
16	93900-06035	SCREW, pan, 6x25	1	1		
17	93900-06038	SCREW, pan, 6x28	4	4		
18	93900-06074	SCREW, pan, 7x26	4	4		
19	93900-06075	SCREW, pan, 6x27	1	1		
20	93700-43050	SCREW, C-40, 6x30	3	3		
21	94510-10000	CIR-CLIP, external, 10 mm	1	1		

E-7 Clutch - Oil Pump

C 9

E-7 Clutch - Oil Pump

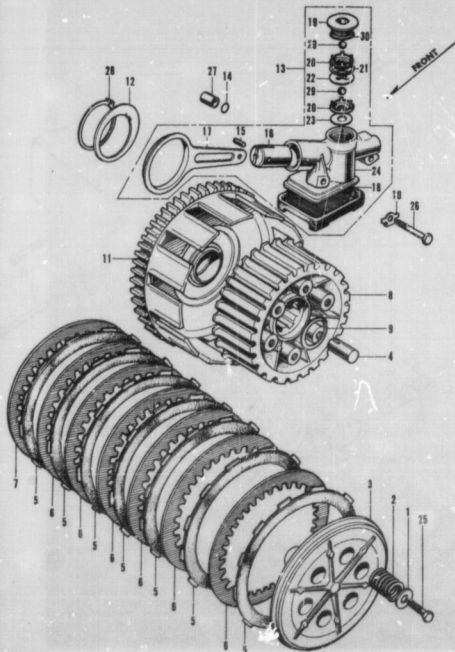

Ref. No.	Part No.	Description	Req'd. No. 41 1148 68 11 8	No. Used on	
				From	To
1	90481-250-000	WASHER, 6x19	4	-	-3000971
		WASHER, 6x19 (Change to req'd No.)	4	4	CB450E-3000972
2	22471-287-010	SPRING, clutch	6	-	-3000971
		SPRING, clutch	4	4	CB450E-3000972
3	22321-283-000	PLATE, clutch pressure	1	-	-3000971
		PLATE, clutch pressure	1	1	CB450E-3000972
4	22838-292-000	PIECE, clutch lifter joint	1	1	
5	22601-283-000	DISK, clutch friction	7	7	
6	22321-283-000	PLATE B, clutch	6	6	
7	22311-289-000	PLATE A, clutch	1	1	
8	22130-292-020	CENTER, clutch	1	-	-3000971
		CENTER, clutch	1	1	CB450E-3000972
9	90903-259-010	CIR-CLIP, 25 mm	1	1	
10	90433-283-000	WASHER, lock, 6 mm	2	2	
11	22100-292-040	OUTER, cl. (PVT)	1	1	
12	90404-252-000	WASHER, pump, rod side	1	1	
13	15300-282-010	PUMP ASS'Y., oil	1	1	
14	91307-283-000	O-RING, 8x1.5	1	1	
15	15210-292-000	PIN, oil pump plunger	1	1	
16	15273-292-010	PLUNGER, pump	1	1	
17	15205-292-000	ROD, pump	1	1	
18	15211-283-000	SCREEN, 6.5oz	1	1	
19	15213-292-010	BOLT, ball stopper, oil pump	1	1	
20	91015-292-000	O-RING, 17x2.5	1	1	
21	91014-292-010	SEAT, ball, oil pump	1	1	
22	91013-292-000	RING, rubber	1	1	
23	15212-292-000	STOPPER, ball, oil pump	1	1	
24	15216-292-000	SEAT, rubber	1	1	
25	15201-292-010	BODY, oil pump	1	1	
26	92000-0602E	BOLT, hex., 6x25	6	-	
		BOLT, hex., 6x25 (Change to req'd No.)	4	4	
27	92000-0602B	BOLT, hex., 6x28	2	2	
28	94301-08120	PIN, knock, 8x12A	1	1	
29	94510-20000	CIR-CLIP, ext./int., 32 mm	1	1	
30	96211-10000	BALL, steel, #10	2	2	

E-14 Shift Drum - Kick Starter

C 1

E-14 Shift Drum - Kick Starter

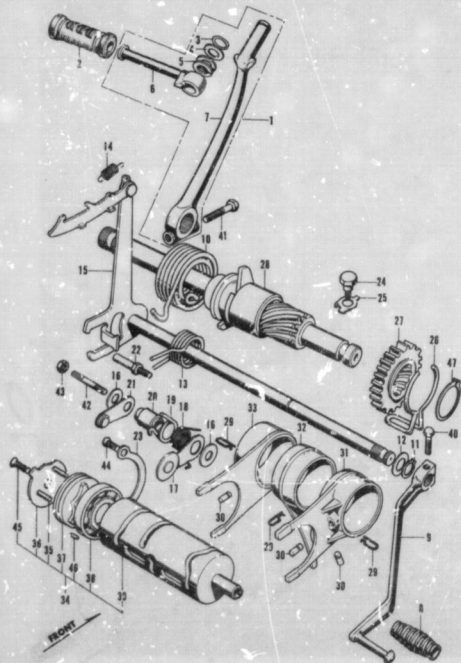

Ref. No.	Part No.	Description	Reqd. No. 19 4949 09 71 9	No. Used on	
				From	To
1	2830-292-000	ARM ASSY, kick starter	1	1	
2	2830-294-000	RUBBER, kick starter	1	1	
3	2846-221-020	RING, kick pedal stopper	1	1	
4	2836-221-020	WASHER, kick pedal	1	1	
5	2847-23 000	SPRING, kick pedal stopper	1	1	
6	2826-283-000	PEDAL, kick starter	1	1	
7	2826-292-000	ARM, kick starter	1	1	
8	24781-305-000	RUBBER, change pedal	1	1	
9	24701-293-000	PEDAL, gear change	1	1	
10	28261-292-000	SPRING, kick starter	1	1	
11	90603-300-000	SET-RING, 12 mm	1	1	
12	24621-300-000	STOPPER, gear shift spindle side	1	1	
13	24651-292-010	SPRING, gear shift return	1	1	
14	24641-292-000	SPRING, gear shift arm	1	1	
15	24610-292-030	SPINDLE, gear shift	1	1	
16	90463-292-010	WASHER, shift drum stopper	2	2	
17	24430-292-020	STOPPER, shift drum	1	1	
18	24435-292-010	SPRING, shift drum stopper	1	1	
19	24438-292-000	SPRING, shift drum neutral stopper	1	1	
20	24438-292-010	COLLAR, shift drum stopper	1	1	
21	24440-292-010	STOPPER, shift drum neutral	1	1	
22	24652-300-000	PIN, gear shift return spring	1	1	
23	24710-225-000	PLATE, bearing setting	1	1	
24	90081-283-000	BOLT, 8 mm	1	1	
25	90432-283-010	WASHER, lock, 8 mm	1	1	
26	35239-252-000	SPRING, friction	1	1	
27	28212-272-040	PINION, kick starter	1	1	
28	28250-292-010	SPINDLE, kick starter	1	1	
29	24263-028-000	CLIP, gear shift lock guide pin	1	1	
30	24261-292-000	PIN, gear shift lock guide	2	2	
31	24221-092-020	FORK, left gear shift	1	1	
32	24231-282-030	FORK, center gear shift	1	1	
33	24211-292-020	FORK, right gear shift	1	1	
34	24300-292-020	DRUM, gear shift	1	1	
35	24306-227-300	PIN, gear shift drum	4	4	

F-3 Front Cushion
(Used in U.S.A. & Sweden)

D 10

F-3 Front Cushion
(Used in U.S.A. & Sweden)

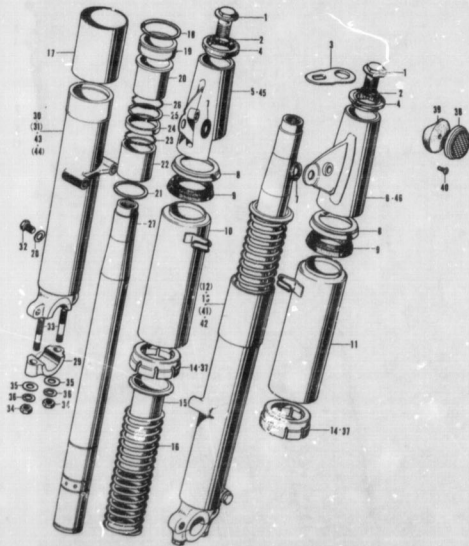

Ref. No.	Part No.	Description	Repl. No.	No. Used on	
			11 1140	From	To
			48	74 II	
1	50123-292-000	P.O.L.T. front fork	2	2	
2	91304-703-000	J-RING, 12 mm	2	2	
3	50126-292-670	KEEPER, helmet	1	-	
4	51041-292-410	CUSHION, fork cover upper	2	2	
5	51052-292-670B	COVER, right front fork (Black)	1	-	~300955
	51052-292-670C	COVER, right front fork (Non sanding)	1	-	~300955
	51052-292-671B	COVER, right fork (Black)	1	-	CB450 -300956~301074S
	51052-292-671Z	COVER, right fork (Non sanding)	1	-	CB450 -300956~301074S
	51052-292-672B	COVER, right front fork (Black)	1	-	CB450 -301074E
	51052-292-672Z	COVER, right front fork (Non sanding)	1	-	CB450 -301074E
	51052-292-672AZ	COVER, right front fork (Candy blue green)	1	-	CB450 -302159Z
	51052-292-672CM	COVER, right front fork (Candy ruby red)	1	-	CB450 -302159Z
	51052-292-672CQ	COVER, right front fork (Candy gold)	1	-	CB450 -302159Z
6	51006-292-670B	COVER, left front fork (Black)	1	-	~300955
	51006-292-670Z	COVER, left front fork (Non sanding)	1	-	~300955
	51006-292-671B	COVER, left front fork (Black)	1	-	CB450 -300956~301074S
	51006-292-671Z	COVER, left front fork (Non sanding)	1	-	CB450 -300956~301074S
	51006-292-672Z	COVER, left front fork (Non sanding)	1	-	CB450 -301074E
	51006-292-672AZ	COVER, left front fork (Candy blue green)	1	-	CB450 -302159Z
	51006-292-672CM	COVER, left front fork (Candy dly red)	1	-	CB450 -302159Z
	51006-292-672CQ	COVER, left front fork (Candy gold)	1	-	CB450 -302159Z
7	511-292-300	WASHER, rubber	2	2	
8	511-292-670	GUIDE, cushion	2	2	
9	51022-292-670	CUSHION, front cover lower	2	2	
10	51011-292-670B	COVER, right front fork lower (Black)	1	-	~300955
	51011-292-670Z	COVER, right front fork lower (Non sanding)	1	-	~300955
	51011-292-671B	COVER, right front fork lower (Black)	1	-	CB450 -300956
	51011-292-671Z	COVER, right front fork lower (Non sanding)	1	-	CB450 -300956
	51011-292-671A	COVER, right front fork lower (White)	1	-	CB450P -301540Q
	51011-292-671AZ	COVER, right front fork lower (Candy blue green)	1	-	CB450 -302159Z
	51511-292-671CM	COVER, right front fork lower (Candy ruby red)	1	-	CB450 -302159Z
	51011-292-671CQ	COVER, right front fork lower (Candy gold)	1	-	CB450 -302159Z
11	51015-292-670B	COVER, left front fork lower (Black)	1	-	~300955
	51015-292-670Z	COVER, left front fork lower (Non sanding)	1	-	~300955
	51015-292-671B	COVER, left front fork lower (Black)	1	-	CB450 -300956
	51015-292-671Z	COVER, left front fork lower (Non sanding)	1	-	CB450 -300956
	51015-292-671A	COVER, left front fork lower (White)	1	-	CB450P -301540Q
	51015-292-671AZ	COVER, left front fork lower (Candy blue green)	1	-	CB450 -302159Z
	51015-292-671CM	COVER, left front fork lower (Candy ruby red)	1	-	CB450 -302159Z
	51015-292-671CQ	COVER, left front fork lower (Candy gold)	1	-	CB450 -302159Z
12	51400-292-670	CUSHION ASSY., right front	1	-	
13	51300-292-670	CUSHION ASSY., left front	1	-	
14	51013-292-670	CAP, spring seat	2	2	
15	51013-292-000	SEAT, spring	2	2	

F-3 Front Cushion
(Used in U.S.A. & Sweden)

D 11

F-3 Front Cushion
(Used in U.S.A. & Sweden)

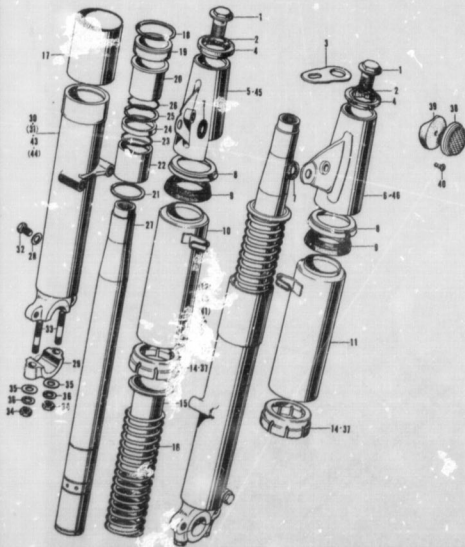

Ref. No.	Part No.	Description	Repl. No.		No. Used on	
			11 142	08 71 II	From	To
16	51401-292-010	SPRING, front cushion	2	2		
17	51402-292-670	COVER, spring	2	-		~3003319
	51402-292-671	COVER, spring	2	2	CB450	-000320
18	90601-292-000	CIR-CLIP, internal, 47 mm	2	2		
19	91255-292-003	OIL-SEAL, 354611 (ARAI)	2	2		
	91255-292-005	OIL-SEAL, 754611 (N.O.K.)	2	2		
20	51451-292-000	GUIDE, front fork pipe	2	2		
21	51445-273-000	RING, fork piston snap	2	2		
22	51442-292-000	PISTON, front fork	2	2		
23	51447-273-000	RING, piston stopper	2	2		
24	51443-273-000	VALVE, front damper	2	2		
25	51446-273-000	RING, fork valve stopper	2	2		
26	51444-273-000	RING, fork pipe stopper	2	2		
27	51410-292-000	PIPE, front fork	2	2		
28	90543-273-000	PACKING, drain cock	2	2		
29	51634-292-000	HOLDER, front axle	2	2		
30	51430-292-670	CASE, bottom, right front fork	1	-		
31	51520-292-670	CASE, bottom, left front fork	1	-		
32	92000-00010	BOLT, hex., 6 x 10	2	2		
33	92700-08049	BOLT, unid., 8 x 49	4	4		
34	94001-08000-05	NUT, hex., 8 mm	4	4		
35	94101-08000	WASHER, plate, 8 mm	4	4		
36	94111-08000	WASHER, spring, 8 mm	4	4		
37	95550-292-000	WASHER, spring seat	2	2	CB450	-000320
38	33741-286-670	REFLECTOR, front reflex (Used in U.S.A.)	2	-	CB450	-010746
39	33743-286-670	BASE, front reflex reflector (Used in U.S.A.)	2	-	CB450	-010746
40	93000-03006-05	SCREW, pa., 5 x 6 (Used in Sweden)	2	-		
41	51400-292-751A	CUSHION ASSY., right front (White)	-	1	CB450P	-015400
42	51500-292-751A	CUSHION ASSY., left front (White)	-	1	CB450P	-015400
43	51420-292-751A	CASE, right front fork bottom (White)	-	1	CB450P	-015400
44	51520-393-751A	CASE, left front fork bottom (White)	-	1	CB450P	-015400
45	51602-292-756A	COVER, right front fork (White)	-	1	CB450P	-015400
46	43808-292-756A	COVER, left front fork (White)	-	1	CB450P	-015400

Block No. F-3 is used on CB450 PA II from serial No. CB450P-3015400.

F-4 Steering Stem - Front Fender

D 12

F-4 Steering Stem - Front Fender

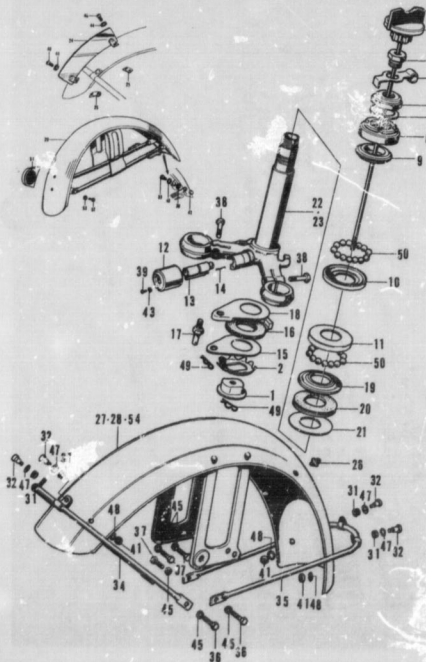

Ref. No.	Part No.	Description	Qty. No.		No. Used or	
			13 1108	8 13	From	To
1	52764-283-000	NUT, steering damper spring	1	1		
2	53763-216-000	SPRING, steering damper	1	1		
3	53740-292-010	KNOB, steering damper	1	1		
4	90131-268-010	BOLT, damper lock spring, set	1	1		
5	53765-283-000	SPRING, steering damper lock	1	1		
6	90084-283-010	Nut, steering stem	1	1		
7	90063-283-000	WASHER, steering stem	1	1		
8	63220-283-010	THREAD COMP., steering head top	1	1		
9	53211-268-305	RACE, steering top cone	1	1		
10	50001-268-305	RACE, steering top ball	1	1		
11	50002-268-305	RACE, steering bottom ball	1	1		
12	53215-230-600	COVER, handle lock case (Not used in Germany)	1	1		
13	50000-230-000	LOCK COMP., handle (Not used in Germany)	1	1		
14	53631-268-020	SPRING, handle lock (Not used in Germany)	1	1		
15	53762-268-010	PLATE B, steering damper	1	1		
16	53750-268-010	DISK, steering damper friction	1	-		~300818
17	53750-292-000	DISK, steering damper friction	1	1	CB40	~300818
18	90118-268-000	BOLT, friction disk anchor	1	1		
19	53761-268-020	PLATE A, steering damper	1	1		~300818
20	53761-292-000	PLATE A, steering damper	1	1	CB40	~300818
21	53212-250-305	RACE, steering bottom cone	1	1		
22	5312-250-000	DUST-SEAL, steering head	1	1		
23	53215-250-000	WASHER, steering head dust seal	1	1		
24	53200-292-000B	STEM COMP., steering (Black)	1	-		~300955
25	53200-292-000Z	STEM COMP., steering (Non sanding)	1	-		~300955
26	53200-292-090A	STEM COMP., steering (White)	1	-	OTOPAP	3008534 - 300855
27	53200-292-010B	STEM COMP., steering (Black)	1	-	CB40	3956
28	53200-292-010Z	STEM COMP., steering (Non sanding)	1	-	CB40	~300956
29	53200-292-010A	STEM COMP., steering (White)	1	-	CB40	300856
30	53200-303-010B	STEM COMP., steering (Black) (Used in Germany & Sweden)	1	-		
31	53200-292-000B (Ref. No. 22)	Part No. 53200-292-000B (Ref. No. 22) is used on all Sweden export models from serial No. CB40-300776.				
32	53200-230-010Z	STEM COMP., steering (Non sanding) (Used in Germany & Sweden)	1	-		
33	53200-292-000Z (Ref. No. 22)	Part No. 53200-292-000Z (Ref. No. 22) is used on all Sweden export models from serial No. CB40-300776.				

F-4 Steering Stem - Front Fender

D 13

F-4 Steering Stem - Front Fender

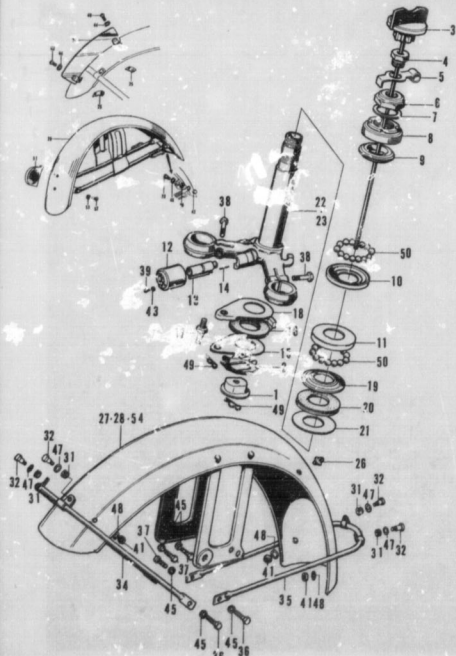

Ref. No.	Part No.	Description	Reqd. No. Ex 1448 08 11 I	No. Used on	
				From	To
	5200-292-611B	STEM COMP, assring (Black) (Used in Germany)	1	-	
	5200-92-6112	STEM COMP, assring (Non sanding) (Used in Germany)	1	-	
24	6731-283-00B	PLATE, front number (Black) (Used in England)	1	-	
25	61132-601-611	WASHER, numbr. plate setting (Used in England)	2	-	
26	6541-283-000	GROMMET	2	2	
27	61100-292-620XW	FENDER COMP, front (Chrome)	1	-	
	Part No. 61000-292-620XW (Ref. No. 29) is used on all Sweden export model from serial No. CB400-300754.				
	61100-292-620XW	FENDER COMP, front (Chrome)	1	-	
	Part No. 61100-292-620XW (Ref. No. 29) is used on all Sweden export models from serial No. CB400-300754.				
	61100-292-620A	FENDER COMP, front	1		CB450-301076
28	61100-292-620XW	FENDER COMP, front (Chrome) (Used in England)	1	-	
29	61100-292-670XW	FENDER COMP, front (Chrome) (Used in U.S.A.)	1		-300015
	61100-292-671XW	FENDER COMP, front (Chrome) (Used in U.S.A.)	1	-	CB450-301076
30	61105-292-670	RUBBER, fender cushion (Used in U.S.A.)	1	-	
31	84765-292-600	RUBBER, number bracket cushion	4	4	
32	90162-292-600	BOLT, front fender setting	4	4	
33	90162-292-670	BOLT, fender setting (Used in U.S.A.)	4	-	
34	61162-292-610	STAY A, front fender	1	1	
35	61160-292-610	STAY B, front fender	1	1	
36	90000-06012	BOLT, hex, 6x12	4	4	
37	92000-06016	NUT, hex, 6x16	3	3	
38	92000-10036-0A	BOLT, hex., 10x36	2	2	
39	93500-03008-0A	SCREW, pan, 3x8	1	1	
40	93500-04013-0B	SCREW, pan, 4x12	4	-	
41	94002-06000	NUT, thin, 6mm	4	4	
42	94021-06020	NUT, cap, 6mm	4	-	
43	94101-63000	WASHER, plain, 3mm	1	1	
44	94101-04000	WASHER, plain, 4mm	4	-	
45	94101-06000	WASHER, plain, 6mm	7	7	

F-4 Steering Stem - Front Fender

D 14

F-4 Steering Stem - Front Fender

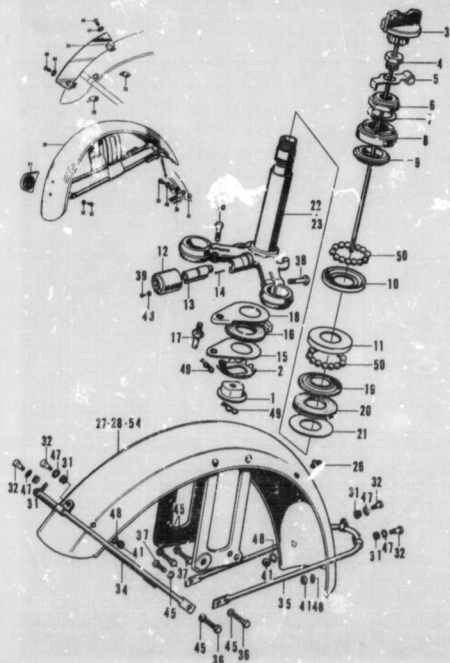

Ref. No.	Part No.	Description	Ref. No.		No. Used on	
			21 2428	48 21 8	From	To
46	94701-06000	WASHER, plain, 8 mm.....	4	-		
47	94101-06000	WASHER, p ² -in, 8 mm.....	4	4		
48	94111-06000	WASHER, spring, 6 mm.....	4	4		
49	94251-06000	PIN, lock, 6 mm.....	2	2		
50	96290-06000	BOLT, steel, 1/2".....	27	27		
51	32741-077-671	REFLECTOR ASSY., front reflex..... (Used in U.S.A.)	1	-	CB450	300616-301074
52	93901-34210	SCREW, tapping, f x 10.....	2	-		
53	94101-04000	WASHER, plain, 4 mm.....	2	-		
54	61100-252-770	FENDER COMP., front.....	1	-	CB40P	300634-301074

F-5 Front Wheel

D 15

F-5 Front Wheel

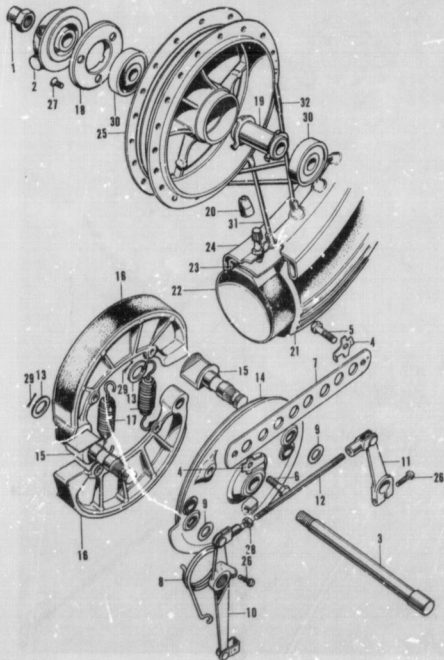

Ref. No.	Part No.	Description.	Repl. No. 14 1408 08 14 11	No. Used on	
				From	To
1	90305-283-000	NUT, front wheel axle		1	1
2	44900-283-000	BOX ASSY., speedometer gear		1	1
3	44301-283-000	AXLE, front wheel		1	1
4	90532-292-000	WASHER, tongue, 8 mm		2	2
5	90125-283-010	BOLT, front brake stopper arm		1	1
6	90126-292-000	BOLT, front brake stopper arm		1	1
7	45431-292-010	ARM, front brake stopper		1	1
8	45461-222-000	SPRING, brake arm		1	1
9	45134-250-000	DUST-ARM, front wheel		2	2
10	45410-283-010	ARM A, front brake		1	1
11	45420-268-010	ARM B, front brake		1	1
12	43423-268-000	ROD, rear brake		1	1
13	45106-222-300	WASHER, anchor pin		2	2
14	45100-283-000	PANEL COMP., front brake		1	1
15	45131-268-030	CAM, front brake		2	2
16	45120-283-000	SHOS COMP., front brake		2	2
17	45133-283-050	SPRING, brake shoe		2	2
18	44541-283-000	RETAINER, front wheel bear. v.		1	1
19	44620-283-000	COLLAR, front axle distance		1	1
20	44606-293-000	BALANCER, wheel (20 g)		(8-2)	
	44607-283-000	BALANCER, wheel (15 g)		(8-2)	
	44608-283-000	BALANCER, wheel (10 g)		(8-2)	
	44609-283-000	BALANCER, wheel (5 g)		(8-2)	
21	44711-283-003	TIRE, front wheel (3.25-18" DUNLOP)		1	1
	44711-292-014	TIRE, front wheel (3.25-18" DUNLOP)		1	1
22	44712-283-000	TUBE, wheel (2.25-18")		1	1
23	44713-283-000	FLAP, tire (18")		1	1
24	44705-283-000	RIM, front wheel (DAIDO)		1	1
25	44601-245-000	HUB COMP., front wheel (Superseded by 44601-292-000)			
	44601-292-000	HUB COMP., front wheel		1	1
	44601-292-010	HUB COMP., front wheel		-	-
26	70000-60020-03	BOLT, hex., 6 x 20		2	2
27	90600-06012	SCREW, flat, 6 x 12		2	2
28	94301-03020	NUT, hex., 6 mm		1	1
29	94201-25220	PIN, cotter, 25 mm		2	2

-300895

CB400 -300896

CB450 -302464

CB450 -302464

F-5 Front Wheel

D 16

F-5 Front Wheel

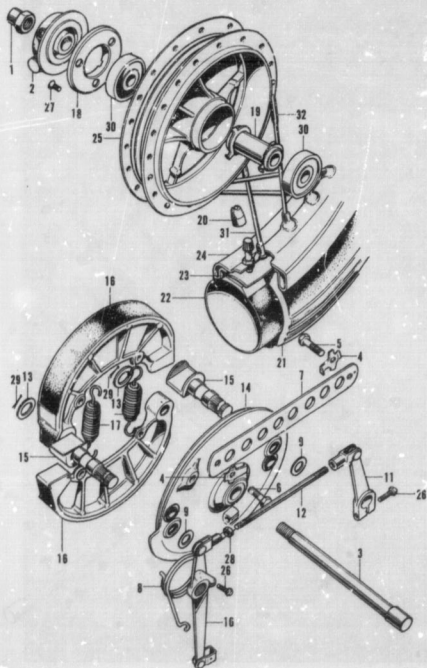

Ref. No.	Part No.	Description	Reqd. No.	Fin. Used in	
			11 1548	From	To
			68 F3 II		
30	96120-6000	BEARING, ball, 6302Z	2	2	
31	97518-5212A	SWB 9x14x6.5x84 (side)	20	20	
32	97366-5.1381	SWB 9x144x7.6x100 (Cut etc.)	20	20	

E-14 Shift Drum - Kick Starter

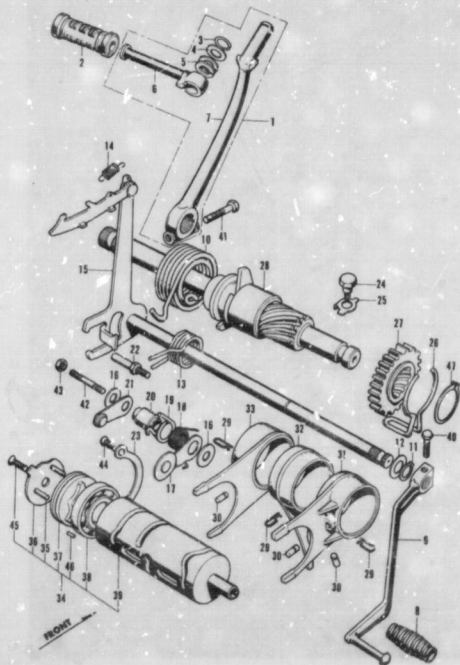

D 2

E-14 Shift Drum - Kick Starter

Ref. No.	Part No.	Description	Qty. Req. 11 1162 48 71 II	No. Used on	
				From	To
26	2405-25-340	PLATE, drum stopper cam	1	-	CB45E-300001-300303
	2405-26-350	FLANGE, drum stopper cam	1	1	CB45E-300431
27	2404-257-340	CENTER, drum gear shift	1	-	-307930
	2304-250-350	CENTER, drum gear shift	1	1	CB45E-300931
28	9101-234-300	BEARING, ball, 10004	1	1	
29	2401-250-330	DRUM, gear shift	1	1	
40	9000-0005-08	BOLT, hex, 6x25	1	1	
41	9000-0003-0A	BOLT, hex, 8x32	1	1	
42	9070-00045	BOLT, stud, 6x45	1	1	
43	9000-00012	SCREW, flat, 6x12	2	2	
44	9000-00040	SCREW, flat, 6x40	1	1	
45	9403-00000	NUT, hex, 6mm	1	1	
46	9403-04090	PIN, knock, 1/8x8	1	1	
47	97510-250-1	CIR-CLIP, general, 25mm	1	1	

E-15 Right Carburetor (KEIHIN)

D 3

E-15 Right Carburetor (KEIHIN)

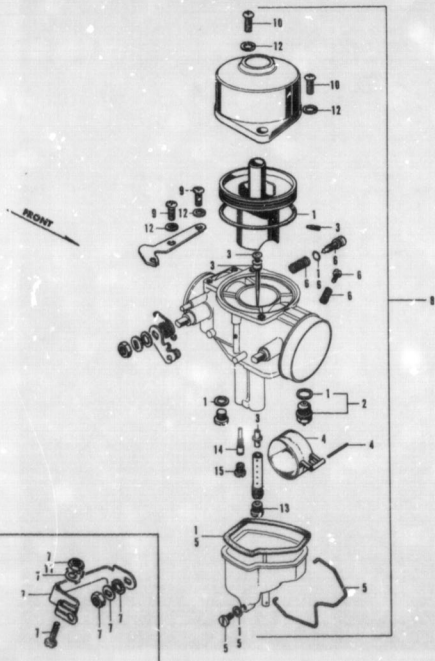

Ref. No.	Part No.	Description	Repl. No. 15 1508 08 11 2	No. Used on	
				From	To
1	16010-283-001	PACKING SET		1	1
2	16011-302-004	VALVE SET, float		1	1
3	16012-292-004	NEEDLE SET, jet		1	1
4	16013-283-004	FLOAT SET		1	1
5	10915-346-004	CHAMBER SET A, float		1	1
6	16016-02-004	SCREW SET A		1	1
7	16025-292-004	JOINT SET, connector		1	1
8	16101-292-014	R. CARBURETOR ASSY. (Superseded by 16101-292-024)		1	1
	16101-292-024	R. CARBURETOR ASSY.		1	1
9	93500-05010-0A	SCREW, pan, 5x10		2	2
10	93500-05016-0A	SCREW, pan, 5x16		2	2
11	94001-65000-015	NUT, hex., 5mm		1	1
12	94111-05000	WASHER, spring, 5mm		4	4
13	99114-292-1300	JET, main (#130)		1	1
14	99124-292-0380	JET, slow (#38)		1	1
15	99144-292-0380	JET, pilot (#38)		1	1

E-16 Left Carburetor (KEIHIN)

D 4

E-16 Left Carburetor (KEIHIN)

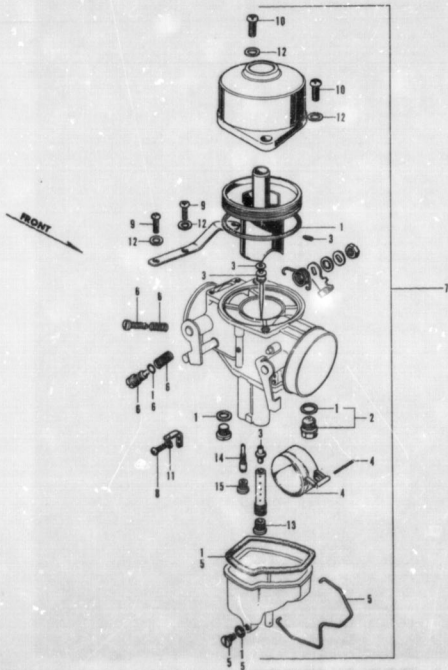

Ref. No.	Part No.	Description	Qty. No.		No. Used on	
			11	1140	F.	To
1	16010-263-004	PACKING SET	1	1		
2	16011-302-004	VALVE SET, float	1	1		
3	16012-292-004	NEEDLE SET, jet	1	1		
4	16013-263-004	FLOAT SET	1	1		
5	16015-346-004	CHAMBER SET A, float	1	1		
6	16016-292-004	SCREW SET A	1	1		
7	16102-292-014	L. CARBURETOR ASSY. (Superceded by 16102-292-024)	1	1		
	16102-292-024	L. CARBURETOR ASSY.	1	1		
8	93000-03005-0A	SCREW, pan, 3x5	1	1		
9	93000-05010-0A	SCREW, pan, 5x10	2	2		
10	93000-05016-0A	SCREW, pan, 5x16	2	2		
11	94111-03000	WASHER, spring, 2mm	1	1		
12	94111-05000	WASHER, spring, 5mm	4	4		
13	99114-252-1300	JET, main (#130)	1	1		
14	99124-292-0380	JET, slow (#38)	1	1		
15	99144-292-0380	JET, pilot (#38)	1	1		

F-1 Handle

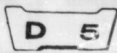

F-1 Handle

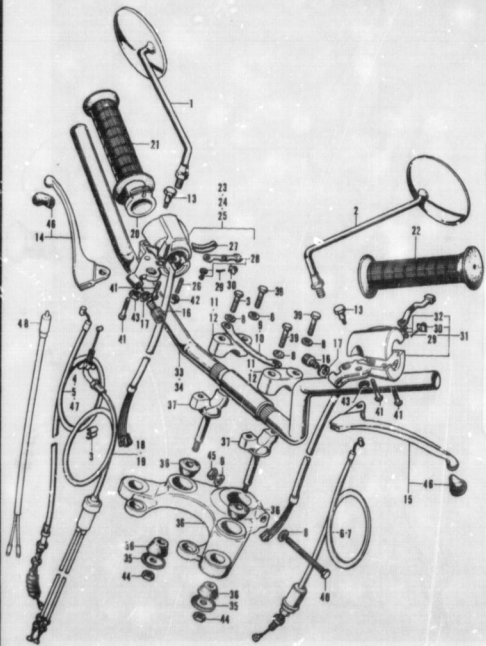

Ref. No.	Part No.	Description	Reqd. No. 13 2488 48 71 8	No. Used on	
				From	To
1	8010-240-000	MIRROR, right back	1	CB40	-3027309
	8010-304-021	MIRROR, right back	1	CB40	-3027310
2	80130-325-000	MIRROR, left back	1	CB40	-3027309
	80130-304-021	MIRROR, left back	1	CB40	-3027310
3	4545-270-000	CLIP, front brake wire	1	2	
4	45450-292-010	CABLE COMP., front brake	1	-	
<p>Part No. 45450-294-070 (Ref. No. 4) is used on all U.S.A. export models from serial No. CB450-3006016.</p>					
5	45450-292-600	CABLE COMP., front brake (Used in Germany, England & Sweden)	1	-	
<p>Part No. 45450-292-010 (Ref. No. 4) is used on all Sweden export models from serial No. CB450-3007754.</p>					
6	22870-292-000	CABLE COMP., clutch	1	-	
7	22870-292-600	CABLE COMP., clutch (Used in Germany, England & Sweden)	1	-	
<p>Part No. 22870-292-000 (Ref. No. 6) is used on all Sweden export models from serial No. CB450-3007754.</p>					
8	90556-283-000	WASHER, special, 6 mm	6	1	
9	53139-292-000	HOLDER, cable	1	-	
10	53139-292-610	HOLDER, cable (Used in Germany, England & Sweden)	1	-	
<p>Part No. 53139-292-000 (Ref. No. 9) is used on all Sweden export models from serial No. CB450-3007754.</p>					
11	53131-283-000	HOLDER, handle pipe	2	2	
12	53131-292-610	HOLDER, handle pipe (Used in Germany, England & Sweden)	2	-	
<p>Part No. 53131-283-000 (Ref. No. 11) is used on all Sweden export models from serial No. CB450-3007754.</p>					
13	90114-268-000	BOLT, handle lever pivot	2	2	
14	53175-216-670	LEVER, right steering handle			
<p>(Superseded by 53170-216-670)</p>					
	53170-216-670	LEVER COMP., right steering handle	2	-	-3006015
	53175-286-000	LEVER, right steering handle (Superseded by 53170-286-670)			
	53170-286-670	LEVER COMP., right steering handle	2	2	CB450-3006016
15	53178-216-670	LEVER, left steering handle (Superseded by 53190-216-670)			
	53190-216-670	LEVER COMP., left steering handle	2	-	-3006015
	53178-286-000	LEVER, left steering handle (Superseded by 53190-286-670)			
	53190-286-670	LEVER COMP., left steering handle	2	2	CB450-3006016
16	53190-248-000	BOLT, clutch wire adjusting	2	2	

F-1 Handle

D 6

F-1 Handle

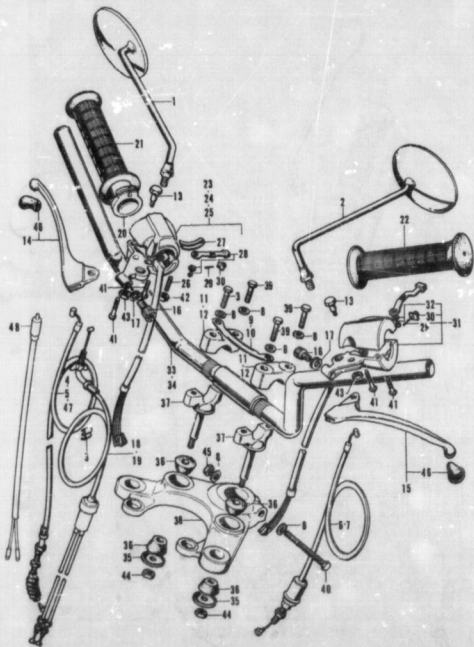

Ref. No.	Part No.	Description	No. Used on	
			15 1408 08 14 16	From To
17	90021-292-000	NUT, 5/16".....	2	2
18	17910-292-070	CABLE COMP., throttle.....	1	-
19	17910-292-600	CABLE COMP., throttle (Used in Germany, England & Sweden)	1	-
		Part No. 17910-292-670 (Ref. No. 18) is used on all Sweden export models from serial No. CB450-300794.		
20	53141-240-000	PIPE, throttle grip.....	1	-
21	53165-283-000	RUBBER, right grip.....	1	1
22	53166-283-000	RUBBER, left grip.....	1	1
23	35300-292-003	SWITCH ASSY., starter lighting (TOYO)..... (Used in General & Australia)	1	-
24	35300-292-600	SWITCH ASSY., starter lighting (Used in Germany, England, France & Sweden)	1	CB450 - -3021191
	35300-317-600	SWITCH ASSY., starter lighting.....	1	CB450 -3021192
25	35300-292-670	SWITCH ASSY., starter lighting (Used in U.S.A.).....	1	-
26	90124-292-000	SCREW, throttle grip adjusting.....	1	1
27	53163-205-010	ADJUSTER, throttle grip.....	1	1
28	35315-235-000	KNOB, lighting switch.....	1	-
29	35318-259-000	SPRING, horn button.....	2	-
30	35317-001-310	BUTTON, horn button push.....	2	-
31	35350-292-003	SWITCH ASSY., winker horn.....	1	-
32	35317-235-000	KNOB, horn switch.....	1	-
33	53100-292-010	PIPE, steering handle.....	1	-
34	53100-292-600	PIPE, steering handle (Used in Germany, England & Sweden)	1	-
		Part No. 53100-292-010 is used on all Sweden export models from serial No. 3007754.		
35	90935-292-000	WASHER, handle cushion.....	2	2
36	53133-283-010	RUBBER, handle cushion.....	4	4
	53133-237-080	RUBBER, handle cushion.....	4	CB450 -3021192
37	53133-292-010	HOLDER, under handle pipe.....	2	2
38	53230-292-010	BRIDGE, fork top.....	1	-
	53230-292-020	BRIDGE, fork top.....	1	CB450 -3009916 -3009955
	53230-292-030	BRIDGE, fork top.....	1	CB450 -3009956 -3021191
	53230-292-090	BRIDGE, fork top.....	1	CB450 -3021192
39	94300-08012-08	BOLT, hex., 5 x 32.....	4	4
40	93900-08074-08	BOLT, hex., 5 x 24.....	1	1
41	93900-26035-0A	SCREW, pan., 5 x 5.....	4	4
42	94001-05000-05	NUT, hex., 5 mm.....	1	1
43	94001-05000	NUT, hex., 5 mm.....	2	2

F-1 Handle

D 7

F-1 Handle

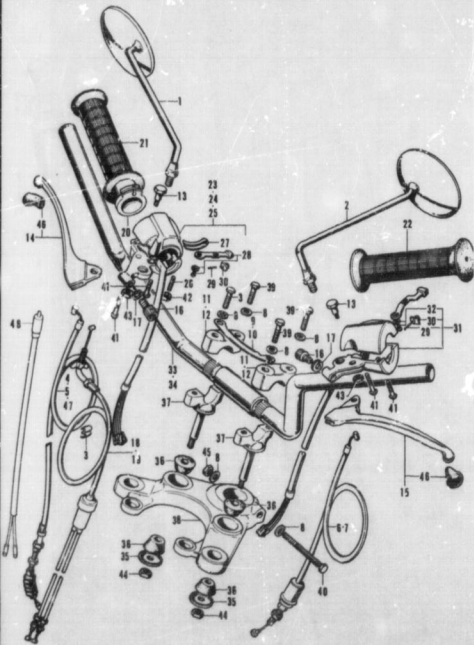

Ref. No.	Part No.	Description	Incl. No.		No. Used on	
			41	42	From	To
44	9401-0800-05	NUT, hex, 8 mm	2	2		
45	9401-0820-05	NUT, hex, 8 mm	1	1		
46	90010-16000	CAP, A-type, control lever	2	-		
	53180-286-000	CAP, control lever	2	2	CB450	-3006016
47	45450-254-670	CABLE COMP, front brake (Used in U.S.A.)	1	-	CB450	-3006016
48	35340-102-003	SW-TU1 COMP, front stop (Superseded by 35340-330-670)	1	-	CB450	-3024724
	35340-330-670	SWITCH COMP, front stop	1	-	CB450	-3024725

F-2 Front Cushion

D 8

F-2 Front Cushion

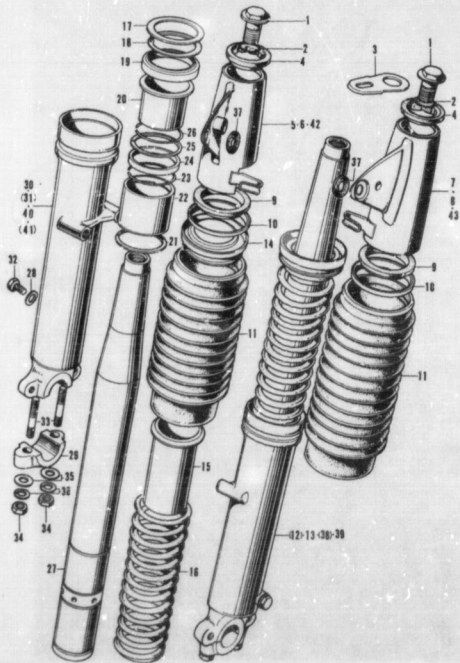

Ref. No.	Part No.	Description	Reqd. No.		No. Used on	
			13 1102	48 F1 II	From	To
1	90123-292-000	BOLT, front fork	2	-	CB430	-3021591
	90124-292-780	BOLT, front fork	2	-	CB430	-3021592
2	91304-292-400	O-RING, 12mm	2	2		
3	53126-292-670	KEEPER, helmet	1	-		
4	51601-292-010	CUSHION, fork cover upper	2	2		
5	51602-292-020B	COVER, right front fork (Black)	1	-		-3008955
	51602-292-020XJ	COVER, right front fork (Candy red)	1	-		-3008955
	51602-292-020DK	COVER, right front fork (Candy blue)	1	-		-3008955
	51602-292-020Z	COVER, right front fork (Non sandst.)	1	-		-3008955
	51602-292-020B	COVER, right front fork (Black)	1	-	CB430	-3008956-3021591
	51602-292-020XJ	COVER, right front fork (Candy red)	1	-	CB430	-3008956-3021591
	51602-292-020DK	COVER, right front fork (Candy blue)	1	-	CB430	-3008956
	51602-292-020Z	COVER, right front fork (Non sandst.)	1	-	CB430	-3008956
	51602-292-020CM	COVER, right front fork (Candy ruby red)	1	-	CB430	-3021592
	51602-292-020CQ	COVER, right front fork (Candy gold)	1	-	CB430	-3021592
6	51606-292-610B	(Discontinue sales)				
	51606-292-610CJ	(Discontinue sales)				
	51606-292-610DK	(Discontinue sales)				
	51606-292-610Z	(Discontinue sales)				
7	51606-292-020B	COVER, left front fork (Black)	1	-		-3008955
	51606-292-020XJ	COVER, left front fork (Candy red)	1	-		-3008955
	51606-292-020DK	COVER, left front fork (Candy blue)	1	-		-3008955
	51606-292-020Z	COVER, left front fork (Non sandst.)	1	-		-3008955
	51606-292-020B	COVER, left front fork (Black)	1	-	CB430	-3008956-3021591
	51606-292-020XJ	COVER, left front fork (Candy red)	1	-	CB430	-3008956-3021591
	51606-292-020DK	COVER, left front fork (Candy blue)	1	-	CB430	-3008956
	51606-292-020Z	COVER, left front fork (Non sandst.)	1	-	CB430	-3008956
	51606-292-020CM	COVER, left front fork (Candy ruby red)	1	-	CB430	-3021592
	51606-292-020CQ	COVER, left front fork (Candy gold)	1	-	CB430	-3021592
8	51606-292-610B	(Discontinue sales)				
	51606-292-610CJ	(Discontinue sales)				
	51606-292-610DK	(Discontinue sales)				
	51606-292-610Z	(Discontinue sales)				
9	51622-292-010	CUSHION, fork cover lower	2	2		
10	51625-292-300	PACKING, front fork rib	2	2		
11	51611-292-020	BOOT, front fork	2	2		
12	51640-292-010	CUSHION ASSY., right front	1	-		
13	51500-292-010	CUSHION ASSY., left front	1	-		
14	51613-292-010	CAP, spring seat	2	2		
15	51613-292-000	SEAT, spring	2	2		

F-2 Front Cushion

D 9

F-2 Front Cushion

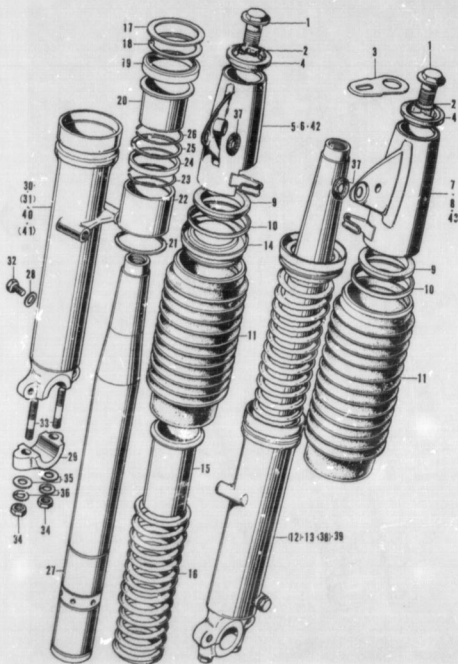

Ref. No.	Part No.	Description	Reqd. No. @ 11.00 @ 11.0	No. Used on	
				From	To
16	51401-292-010	SPRING, front cushion	2	2	
17	90900-292-000	WASHER, spring seat	2	2	
18	90001-292-000	CLIP, internal, 47 mm.	2	2	
19	51255-292-033	OIL-SEAL, 354611 (ARA1)	2	2	
	51255-292-005	OIL-SEAL, 354611 (N.O.K.)	2	2	
20	51401-292-000	GUIDE, from fork pipe	2	2	
21	51445-273-000	RING, front piston snap	2	2	
22	51443-292-000	PISTON, front fork	2	2	
23	51447-273-000	RING, piston stopper	2	2	
24	51443-273-000	VALVE, front damper	2	2	
25	51446-273-000	RING, fork valve stopper	2	2	
26	51444-273-000	RING, fork pipe stopper	2	2	
27	51410-292-000	PIPE, front fork	2	2	
28	90543-273-000	PACKING, drain cock	2	2	
29	51634-292-000	HOLDER, front axle	2	2	
30	51430-292-010	CASE, bottom, right front fork	1	-	
31	51320-292-010	CASE, bottom, left front fork	1	-	
32	92000-06010	BOLT, hex., 6 x 10	2	2	
33	92700-08040	BOLT, stud, 8 x 49	4	4	
34	94001-06000-05	NUT, hex., 8 mm.	4	4	
35	94101-06000	WASHER, plain, 8 mm.	4	4	
36	94111-06000	WASHER, spring, 8 mm.	4	4	
37	51920-292-300	WASHER, rubber	2	2	
38	51405-292-750	CUSHION ASSY., right front	-	1	CB450P-3008534-3015399
39	51500-292-720	CUSHION ASSY., left front	-	1	CB450P-3008534-3015399
40	51430-292-730	CASE, right front fork bottom	-	1	CB450P-3008534-3015399
41	51520-292-750	CASE, left front fork bottom	-	1	CB450P-3008534-3015399
42	51600-292-752A	COVER, right front fork (White)	-	1	CB450P-3008534-3015399
43	51600-292-752A	COVER, left front fork (White)	-	1	CB450P-3008534-3015399

* Front cushion under F-3 block for U.S.A. model are commonly used on the model for Sweden from serial No. CB450-3007/54.

* Block No. F-3 is applied from CB400 PA II, serial No. CB400-3015400.

F-6 Fuel Tank - Double Seat

E 1

F-6 Fuel Tank - Double Seat

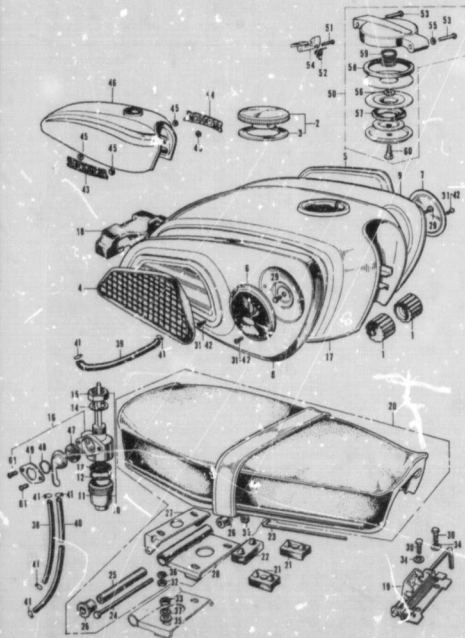

Ref. No.	Part No.	Description	Reqd. No. 18 8808 OF 1A 10	No. Used on	
				From	To
1	17611-283-070	CUSHION, front, fuel tank	1	1	
2	17630-292-030	CAP COMP., fuel filler	1	1	CB450 - -3021591
3	17632-259-000	PACKING, fuel filler cap	1	1	CB450 - -3021591
4	17661-293-000	RUBBER, right knee grip	1	1	CB450 - -3021591
		Deleted from serial No. CB450-300956 for U.S.A. export model.			
5	17662-293-000	RUBBER, left knee grip	1	1	CB450 - -3021591
		Deleted from serial No. CB450-300956 for U.S.A. export model.			
6	87121-292-000	EMBLEM, right fuel tank	1	-	-3004997
		(Superseded by 87121-292-010 with 87122-292-010 & 93700-03006-02 (4 pcs.))			
	87121-292-010	EMBLEM, right fuel tank	1	1	CB450 -3004998 -3010645
		(Superseded by 87121-292-020 with 93900-03006-02 (2 pcs.))			
		Part No. 87121-292-070 (Ref. No. 43) is used on U.S.A. export models from serial No. CB450-300956.			
	87121-292-020	EMBLEM, right fuel tank	1	1	CB450 -3010646 -3021591
	87121-292-700	EMBLEM, fuel tank (Used in Sweden)	2	-	CB450 -3001983 -3021591
7	87122-292-000	EMBLEM, left fuel tank	1	-	-3004997
		(Superseded by 87122-292-010 with 07171-292-010 & 93700-03006-02 (4 pcs.))			
	87122-292-010	EMBLEM, left fuel tank	1	1	CB450 -3004998 -3010645
		(Superseded by 87122-292-020 with 93900-03006-02 (2 pcs.))			
		Part No. 87122-292-070 (Ref. No. 43) is used on all U.S.A. export models from serial No. CB450-300956.			
	87122-292-020	EMBLEM, left fuel tank	1	1	CB450 -3010646 -3021591
8	17640-292-000	COVER, right side	1	1	CB450 - -3021591
		Deleted from serial No. CB450-300956 for U.S.A. export model.			
9	17620-292-000	COVER, left side	1	1	CB450 - -3021591
		Deleted from serial No. CB450-300956 for U.S.A. export model.			
10	16960-292-300	COCK ASSY., fuel (KEHIN)	1	1	
11	16962-283-000	CUP, fuel strainer (KEHIN)	1	1	
12	16930-283-000	PACKING, cock (KEHIN)	2	1	
13	16954-283-000	SCREEN (KEHIN)	1	1	
14	16956-283-000	PACKING, joint nut (KEHIN)	1	1	
15	90300-208-000	NUT, joint	1	1	
16	16961-283-300	BODY-SET, cock (KEHIN)	1	1	

F-11 Rear Fender - Rear Fork

E 10

F-11 Rear Fender - Rear Fork

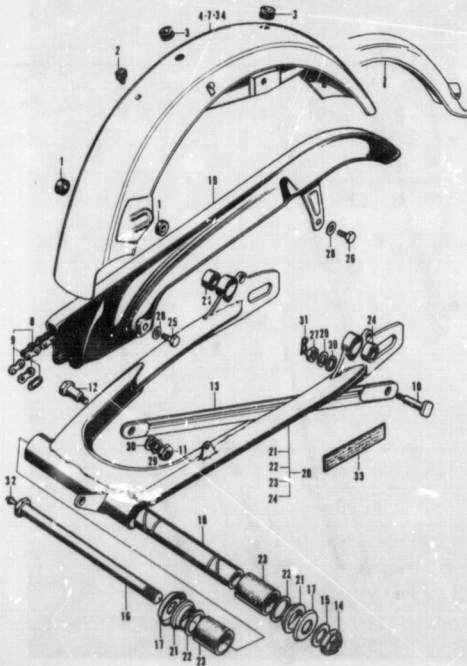

Ref. No.	Part No.	Description	Repl. No. 23 2141 28 74 II	No. Used on	
				From	To
1	17911-011-000	CUSHION, front fuel tank		2	2
2	32985-292-000	GROMMET, wire cord		1	1
3	32983-011-000	GROMMET, wire cord		2	2
4	80100-292-0103XW	FENDER COMP., rear (Chrome) (Used in England, General & Australia)		1	-
	80100-292-0102	FENDER COMP., rear (Non sanding) (Used in England, General & Australia)		1	-
5	80100-292-0103XW	FENDER COMP., rear (Chrome) (Used in Germany & Sweden)		1	-
	Part No. 80100-292-071XW (Ref. No. 7) is used on all Sweden export models from serial No. CB450-300754.				
6	80100-292-0203XW	FENDER COMP., rear (Chrome) (Used in France)		1	-
7	80100-292-071XW	FENDER COMP., rear (Chrome) (Used in U.S.A.)		1	-
	80100-292-0712	FENDER COMP., rear (Non sanding) (Used in U.S.A.)		1	-
8	05030-292-010	CHAIN, drive (DK308HT-92L, DAIDO)	1	1	CB450 - - -3017627
	05030-292-011	CHAIN, drive (DK308HT-92L, DAIDO)	1	1	CB450 -3017628 -3027309
	05030-292-005	CHAIN, drive (DH1508DS-92 LINK)	1	1	CB450 -3027310
9	05031-292-013	JOINT, drive chain (DK308HT, DAIDO)	1	1	- - -3010971
	05031-292-023	JOINT, drive chain (DH 30HT, DAIDO)	1	1	CB450 -3010972 -3017627
	05031-300-003	JOINT, drive chain (DH 30HT, DAIDO)	1	1	CB450 -3017628 -3028670
	05031-300-013	JOINT, drive chain	1	1	CB450 -3024671 -3027309
	05031-300-131	JOINT, drive chain	1	1	CB450 -3027310
10	90127-283-000	BOLT, rear brake panel stopper		1	1
11	90049-001-000	NUT, self lock, 8 mm		1	1
					-3021394
12	90133-283-000	BOLT, rear brake stopper arm		1	1
					-3021395
13	43431-292-000	ARL, rear brake stopper		1	1
14	90064-309-000	NUT, self lock, 14 mm		1	1
15	90026-308-000	WASHER, rear fork pivot bolt		1	1
16	90121-292-000	BOLT, rear fork pivot		1	1
17	52144-283-010	CAP, rear fork dust seal		2	2
18	52143-292-000	COLLAR, rear fork center		1	1
19	05010-292-000B	CASE, drive chain (Black)		1	-
			CB450 -	-	-3021393
	05010-292-000KX	CASE, drive chain (Candy red)		1	-
			CB450 -	-	-3021392
	05010-292-000KK	CASE, drive chain (Candy blue)		1	-
	05010-292-000Z	CASE, drive chain (Non sanding)		1	-
	05010-292-000A	CASE, drive chain (White)		1	-
			CB450 -3078534		
20	52100-292-000B	FORK COMP., rear (Black)		1	-
	52100-292-000Z	FORK COMP., rear (Non sanding)		1	-
	52100-292-000A	FORK COMP., rear (White)		1	-

F-11 Rear Fender - Rear Fork

E 11

F-11 Rear fender - Rear Fork

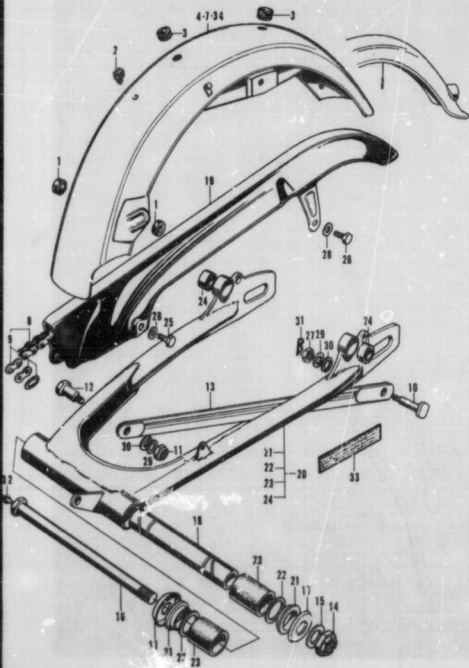

Ref. No.	Part No.	Description	Q'ty. Req'd		No. Used on	
			21	22	From	To
21	52109-283-300	BUSH, rear fork thrust	2	2		
22	52145-283-000	KING, rear fork fork	2	2		
23	52108-292-300	BUSH, rear fork pivot	2	2		
24	45548-208-000	BUSH, rear cushion under rubber	2	2		
25	92900-06012	BOLT, hex, 6x12	2	2		
26	93000-06016	BOLT, hex, 6x16	1	1		
27	94001-08000-05	NUT, hex, 8 mm	1	1		
28	94101-06000	WASHER, plain, 6 mm	2	2		
29	94101-08000	WASHER, plain, 8 mm	2	2		
30	94111-10000	<i>KAYE</i> spring, 10 mm	2	2		
31	94111-08000	17° lock, 8 mm	1	1		
32	94111-08000	NUT, plain, 4.5 mm	1	1		
33	87504-078-070	MARK, muffler caution	1	1		
34	80100-292-700A	ENDER COMP, rear (White)	1	1		

C54507-300834

F-12 Speedotachometer

E 12

F-12 Speedotachometer

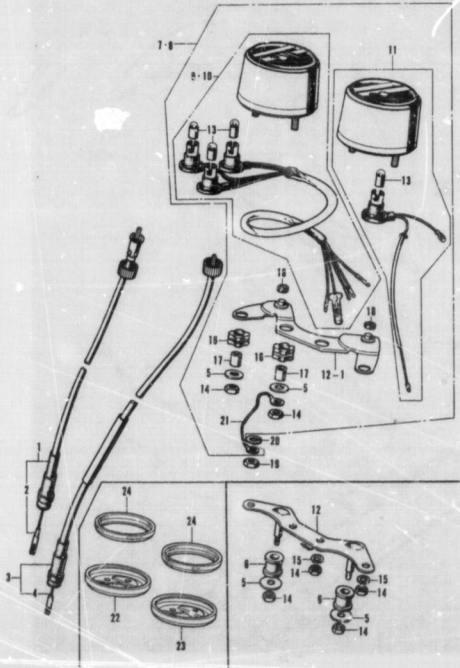

Ref. No.	Part No.	Description	Ref. No.		No. Used on	
			11	12	From	To
1	44830-292-030	CABLE ASSY, speedometer	1	-		
2	44831-292-030	INNER, speedometer cable	1	-		
3	37260-292-030	CABLE ASSY, tachometer	1	-		
4	37261-292-030	INNER, tachometer cable	1	-		
5	90045-292-000	WASHER, 6.5x30	1	-		-3000915
		WASHER, 6.5x30 (Change to req'd No.)	4	-	CB450	-3000916
6	53255-292-010	RUBBER, speedometer stay cushion	2	-		-3000915
7	37260-292-018	SPEED-TACHOMETER ASSY. (KM)	1	-		-3000915
		<i>Superseded by 37260-292-038 with ACC. 30-292-361 (1 pc.), 94001-00000-05 (7 pcs.), 94101-00000 (2 pcs.) & 94111-00000 (2 pcs.)</i>				
		<i>(Used in France & General NIPPON SEIKI)</i>				
	37260-292-038	SPEED-TACHOMETER ASSY. (KM)	1	-	CB450	-3000916
8	37260-292-671	SPEED TACHOMETER ASSY. (MILE)	1	-		-3000915
		<i>Superseded by 37260-292-672 with ACC. 30-292-361 (1 pc.), 94001-00000-02 (2 pcs.), 94101-00000 (2 pcs.) & 94111-00000 (2 pcs.)</i>				
		<i>(Used in France & General NIPPON SEIKI)</i>				
	37260-292-672	SPEED TACHOMETER ASSY. (MILE)	1	-	CB450	-3000916
		<i>Part No. 37260-292-658 (Ref. No. 7-1) is used on all Suzuki export models from serial No. CB450-300754.</i>				
9	37260-292-011	SPEEDOMETER ASSY. (KM)	1	-		-3000915
		<i>Used in France & General NIPPON SEIKI</i>				
	37260-292-038	SPEEDOMETER ASSY. (KM)	1	-	CB450	-3000916-3021591
	37260-329-080	SPEEDOMETER ASSY. (KM)	1	-	CB450	-3021592
	37260-292-671	SPEEDOMETER ASSY. (MILE)	1	-		-3000915
	37260-292-672	SPEEDOMETER ASSY. (MILE)	1	-	CB450	-3000916-3021591
		<i>Part No. 37260-292-658 (Ref. No. 9-1) is used on all Suzuki export models from serial No. CB450-300754.</i>				
	37260-329-670	SPEEDOMETER (MILE)	1	-	CB450	-3021592
11	37240-292-018	TACHOMETER ASSY. (NIPPON SEIKI)	1	-		-3000915
	37240-292-038	TACHOMETER ASSY. (NIPPON SEIKI)	1	-	CB450	-3000916-3021591
	37240-329-000	TACHOMETER ASSY. (NIPPON SEIKI)	1	-	CB450	-3021592
12	37211-292-000B	PLATE, speedometer setting (Black)	1	-		-3000915
	37211-292-010A	PLATE, speedometer setting (Black)	1	-	CB450	-3000916-3021591
	37211-329-670	PLATE, meter set	1	-	CB450	-3021592
13	36905-259-000	BULK, dash (12/30)	4	-		
14	94001-00000	NUT, hex., 8 mm	4	-		
15	94111-00000	WASHER, spring, 8 mm	4	-		
16	7742-292-000	RUBBER, speed-meter cushion	4	-	CB450	-3000916-3021591
	37243-292-000	COLLAR, speedometer set	4	-	CB450	-3000916-3021591
	37243-307-670	COLLAR, tachometer set	4	-	CB450	-3021592
18	37244-292-000	RUBBER, speedometer set	2	-	CB450	-3000916-3021591
	37244-307-670	RUBBER, speedometer set	4	-	CB450	-3021592
19	94001-00000-05	NUT, hex., 8 mm	2	-		
20	94111-00000	WASHER, plain, 8 mm	2	-		
21	37208-292-000	CORD, meter grounding	2	-	CB450	-3000916
22	37212-307-670	RING SET, right meter	1	-	CB450	-3021592
23	37213-307-670	RING SET, left meter	1	-	CB450	-3021592
24	37242-307-670	CUSHION, meter	1	-	CB450	-3021592

F-13 (1) Head Light
(Used in U.S.A.)

E 13

F-13 (1) Head Light
(Used in U.S.A.)

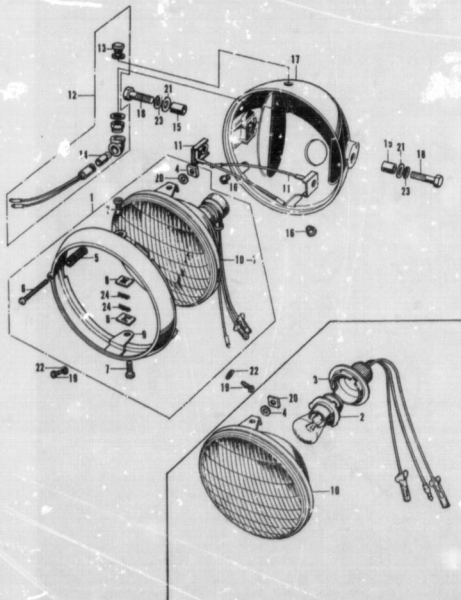

Ref. No.	Part No.	Description	QTY		Part No.	To
			From	To		
1	33100-292-673	LIGHT ASSY., head.....	1	-		-300957
	33100-292-674	LIGHT ASSY., head.....	1	-	CB40	-300958
2	34901-292-005	BULB, head light (12V 35/25W) (Superseded by 34901-292-670)				
	34901-292-670	BULB, head light (12V 35/25W)	1	-		-300957
3	33130-292-670	SOCKET, head light.....	1	-		-300957
4	33117-292-003	NUT, beam adjust (STANLEY)	1	-		-300957
5	33107-292-023	SPRING, beam adjust (STANLEY)	1	-		
6	33193-292-003	SCREW, beam adjust (STANLEY)	1	-		
7	33125-292-670	SCREW, unit holder.....	1	-		
8	33128-200-090	NUT, unit holder.....	1	-		
9	33101-292-671	RIM, head light.....	1	-		
10	33130-292-672	UNIT, head light.....	1	-		-300957
10-1	33120-292-673	UNIT, head light (Sealed beam)	1	-	CB40	-300958
11	61300-292-600	WASHER, head light case.....	2	-		
12	37550-292-610	LAMP ASSY., beam pilot.....	1	-		
13	37501-292-000	LENS, beam pilot.....	1	-		
14	34902-299-000	BULB, dash (12V 3W)	1	-		
15	61302-292-000	COLLAR, head light case.....	2	-		
16	61304-292-600	COLLAR, head light sense.....	2	-		
17	61301-272-030B	CASE, head light (Black)	1	-		
	61301-292-030XJ	CASE, head light (Candy red)	1	-		-300956
	61301-292-030XK	CASE, head light (Candy blue)	1	-		
	61301-292-030AZ	CASE, head light (Candy blue green)	1	-	CB40	-300956
18	52900-10025-6B	BOLT, hex., 10x25.....	2	-		
19	53900-05016-6B	SCREW, pan, 5x16.....	2	-		
20	94101-04300	WASHER, plain, 4 mm.....	1	-		
21	94101-10300	WASHER, plain, 10 mm.....	2	-		
22	94111-05300	WASHER, spring, 5 mm.....	2	-		
23	94111-10300	WASHER, spring, 10 mm.....	2	-		
24	94251-05000	PIN, lock, 5 mm.....	2	-		

F-13 (2) Head Light
(Used in General & Australia)

E 14

F-13 (2) Head Light
(Used in General & Australia)

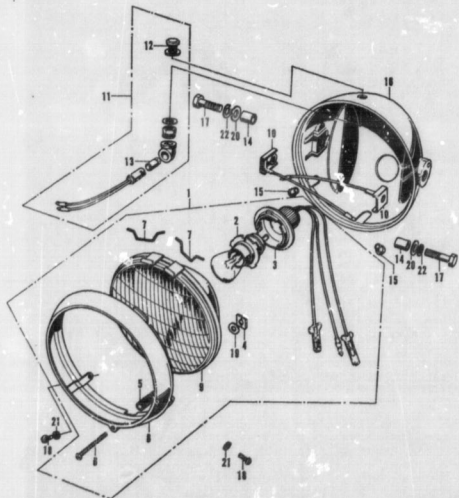

Ref. No.	Part No.	Description	Part No.		No. Used on	
			11 1348	08 14 11	From	To
1	33100-2F2-003	LIGHT ASSY, head (STANLEY)	1	-		
2	34801-292-003	BULB, head light (1FV 35/25W)				
		(Superseded by 34801-292-070)				
	34901-292-070	BULB, head light (1FV 35/25W)	1	-		
3	33130-292-003	SOCKET, head light (STANLEY)	1	-		
4	33117-292-003	NUT, beam adjusting (STANLEY)	1	-		
5	33107-200-002	SPRING, beam adjusting (STANLEY)	1	-		
6	33103-292-003	SCREW, beam adjusting (STANLEY)	1	-		
7	33108-292-003	SPRING, unit holder (STANLEY)	2	-		
8	33101-292-003	RIM, head light (STANLEY)	1	-		
9	33120-292-003	UNIT, head light (STANLEY)	1	-		
10	61303-292-000	WASHER, head light case	2	-		
11	37550-292-010	LAMP ASSY, beam pilot	1	-		
12	37561-292-000	LENS, beam pilot	1	-		
13	34802-289-000	BULB, dash (1FV3W)	1	-		
14	61302-292-000	COLLAR, head light case	2	-		
15	61304-251-000	COLLAR, head light setting	2	-		
16	61301-292-003B	CASE, head light (Black)	1	-		
	61301-292-003KJ	CASE, head light (Candy red)	1	-		
	61301-292-003DK	CASE, head light (Candy blue)	1	-		
	61301-292-003AZ	CASE, head light (Candy blue green)				
17	93000-10025-08	BOLT, hex, 10x25	2	-		
18	93000-60016-08	SCREW, pan, 6x16	2	-		
19	94101-04000	WASHER, plain, 4 mm	1	-		
20	94101-10300	WASHER, plain, 10 mm	2	-		
21	94111-06300	WASHER, spring, 6 mm	2	-		
22	94111-10000	WASHER, spring, 10 mm	2	-		

-300850

CB450 -300856

F-13 (3) Head Light
(Used in France)

E 15

F-13 (3) Head Light
(Used in France)

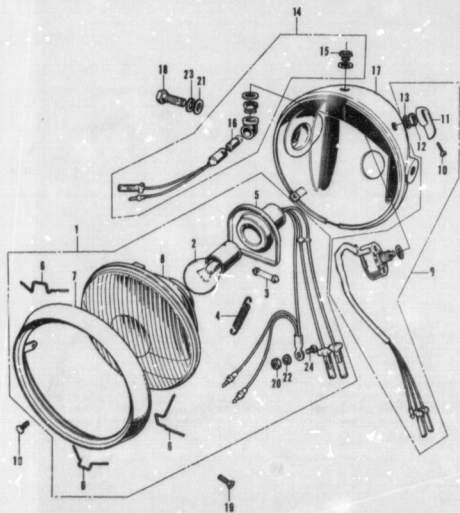

Ref. No.	Part No.	Description	Resp. No.		No. Used on	
			41 1108	48 F1 B	Front	To
1	31100-286-621	LIGHT ASSY., head (Superseded by 33100-286-622)				
	33100-286-622	LIGHT ASSY., head (12V36/36W)	1			
2		BULB, head light (12V 36/36W) (To be locally purchased in France)	1			
3		BULB, parking light (12V 4W) (To be locally purchased in France)	1			
4	33115-863-621	SPRING, socket holder	1			
5	33130-286-621	SOCKET, head light (Superseded by 33130-286-622)				
	33130-286-622	SOCKET, head light	1			
6	33108-268-000	SPRING, head light	3			
7	33101-286-621	RIM, head light	1			
8	33130-286-621	UNIT, head light	1			
9	35150-230-621	SWITCH ASSY., lighting	1			
10	35154-308-000	BOLT, lighting switch	1			
11	35151-308-000	KNOB, lighting switch	1			
12	35152-308-000	NUT, lighting switch	1			
13	35153-308-000	WASHER, lighting switch setting	1			
14	37500-286-003	LAMP ASSY., beam pilot (STANLEY)	1			
15	37561-644-670	LENS, beam pilot	1			
16	34002-259-000	BULB, dash (12V3W)	1			
17	61301-286-600B	CASE, head light (Black)	1			
	61301-286-600X	CASE, head light (Candy red)	1			
	61301-286-600XR	CASE, head light (Candy blue)	1			
	61301-286-600Z	CASE, head light (Non sanding)	1			
18	92000-10005-0B	BOLT, hex., 10x25	2			
19	92700-05010-0B	SCREW, oval, 5x10	2			
20	94001-03000-05	NUT, hex., 3mm	1			
21	94101-10200	WASHER, plain, 10mm	2			
22	94111-03000	WASHER, spr.-g., 3mm	1			
23	94111-10000	WASHER, spring, 10mm	2			
24	96600-03005-1A	BOLT, slot-d., 3x6	1			

F-13 (4) Head Light
(Used in Germany, England & Sweden)

E 16

F-13 (4) Head Light
(Used in Germany, England & Sweden)

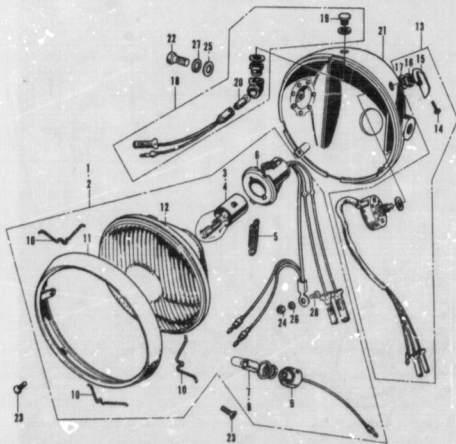

Ref. No.	Part No.	Description	Qty. in		No. Used on	
			13	14	From	To
1	33100-286-601	LIGHT ASSY, head (Used in England).....	1	-		
2	33100-286-611	LIGHT ASSY, head, (Used in Germany & Sweden).....	1	-		
3	34901-269-611	BULB, head light (12V 35/25W) (Used in England).....	1	-		
4	BULB, head light (12V 35/25W) (To be locally purchased in Germany & Sweden).....	1	-			
5	33115-283-601	SPRING, socket holder.....	1	-		
6	33130-286-611	SOCKET, head light.....	1	-		
7	34902-269-610	BULB, dash (12V 4W) (Used in England).....	1	-		
8	BULB, dash (12V 4W) (To be locally purchased in Germany & Sweden).....	1	-			
9	33170-286-611	SOCKET, parking.....	1	-		
10	33106-268-000	SPRING, head light.....	3	-		
11	33101-283-601	RIM, head light.....	1	-		
12	33120-283-601	UNIT, head light.....	1	-		
13	35190-230-621	SWITCH ASSY., lighting.....	1	-	CB400	-3021591
14	35154-268-000	BOLT, lighting switch.....	1	-	CB400	-3021591
15	35151-268-000	KNOB, lighting switch.....	1	-	CB400	-3021591
16	35152-268-000	NUT, lighting switch.....	1	-	CB400	-3021591
17	25153-269-000	WASHER, lighting switch setting.....	1	-	CB400	-3021591
18	27560-286-003	LAMP ASSY., beam pilot (STANLEY).....	1	-		
19	37551-044-070	LENS, beam pilot.....	1	-		
20	34902-269-000	BULB, dash (12V 5W).....	1	-		
21	61301-286-600B	CASE, head light (Black).....	1	-	CB400	-3071591
	61301-286-600XJ	CASE, head light (Candy red).....	1	-	CB400	-3071591
	61301-286-600XX	CASE, head light (Candy blue).....	1	-	CB400	-3021591
	61301-286-600Z	CASE, head light (Non standard).....	1	-	CB400	-3021591
	61301-286-670AZ	CASE, head light (Candy blue green).....	1	-	CB400	-3021592
	61301-286-670CM	CASE, head light (Candy ruby red).....	1	-	CB400	-3021592
	61301-286-670CQ	CASE, head light (Candy gold).....	1	-	CB400	-3021592
22	93000-10025-0B	BOLT, hex., 10x25.....	2	-		
23	87700-00010-0B	SCREW, oval, 5x10.....	2	-		
24	94001-00001-0S	NUT, hex., 3 mm.....	1	-		
25	94101-10200	WASHER, plain, 10 mm.....	2	-		
26	94111-00000	WASHER, spring, 3 mm.....	1	-		
27	94111-10000	WASHER, spring, 10 mm.....	2	-		
28	95500-00000-0A	BOLT, slotted, 3x6.....	1	-		

F-6 Fuel Tank - Double Seat

E 2

F-6 Fuel Tank - Double Seat

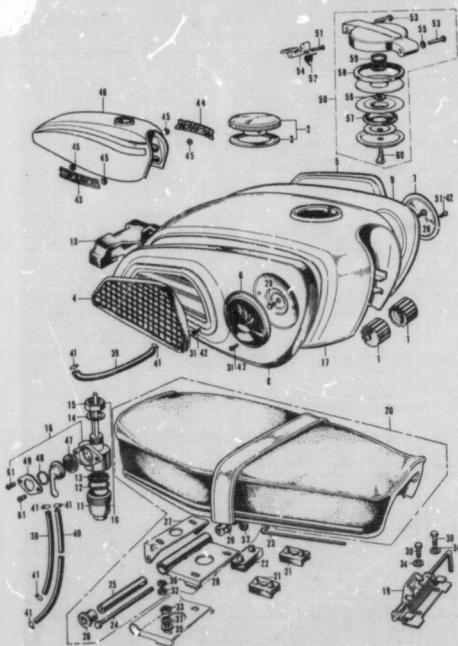

Part No.	Part No.	Description	Ref. No.		No. Used on	
			17	18	From	To
17	17000-292-030B	TANK COMP., fuel (Black)	1	-	-	-3021591
	17000-292-030AZ	TANK COMP., fuel (Candy blue green)	1	-	-	-3021591
	17000-292-030XJ	TANK COMP., fuel (Candy red)	1	-	-	-3021591
	17000-292-030XK	TANK COMP., fuel (Candy blue)	1	-	-	-3021591
	17000-292-030Z	TANK COMP., fuel (Non sanding)	1	-	-	-3021591
	17000-319-6201A	TANK COMP., fuel (White)	1	-	CB40P-300671	
	17000-319-672AZ	TANK COMP., fuel (Candy blue green)	1	-	CB40	-3021592
	17000-319-672CM	TANK COMP., fuel (Candy ruby red)	1	-	CB40	-3021592
	17000-319-672CQ	TANK COMP., fuel (Candy gold)	1	-	CB40	-3021592
18	13613-292-000	CUSHION, rear fuel tank	1	1		
19	77200-292-000	CATCH ASSY., seat	1	1		
20	77200-292-030A	SEAT COMP., double (Black)	1	-	-	-3008955
	77200-292-030B	SEAT COMP., double (Black)	1	-	CB40	-3008955-3021591
	77200-319-000A	SEAT COMP., double (Black)	2	-	CB40	-3021592
21	77204-292-000	RUBBER, seat setting	2	-		
22	77205-292-000	RUBBER B, seat setting	1	-		
23	77216-292-000	BAR, seat stopper	1	-		
24	90101-292-000	BOLT, seat hinge	1	-		
25	77212-292-000	COLLAR, seat hinge	1	-		
26	77213-292-000	RUBBER, seat hinge	2	-		
27	77214-292-000B	PLATE, seat hinge (Black)	1	-		
28	77215-292-010B	BRACKET, seat (Black)	1	-		
29	93000-00006	BOLT, hex., 6x6	2	2		
30	93000-00012	BOLT, hex., 6x12	2	2		
31	93000-03006-6B	SCREW, pan., 3x8	4	-		
31-1	93700-0306-1-6F	SCREW, oval, 3x6	4	4		
31-2	93000-03006-6F	SCREW, pan., 3x6	4	4		
32	94001-00000	NUT, hex., 6 mm	2	-		
33	94001-00000	NUT, hex., 8 mm	2	-		
34	94101-00000	WASHER, plain, 6 mm	2	2		
35	94101-00000	WASHER, plain, 8 mm	2	-		
36	94111-00000	WASHER, spring, 6 mm	2	-		
37	94111-00000	WASHER, spring, 8 mm	2	-		
38	90001-50110	TUBE, fuel, 5x110	1	1		
39	90001-50220	TUBE, fuel, 5x220	1	1		
40	90001-50320	TUBE, fuel, 5x320	1	1		

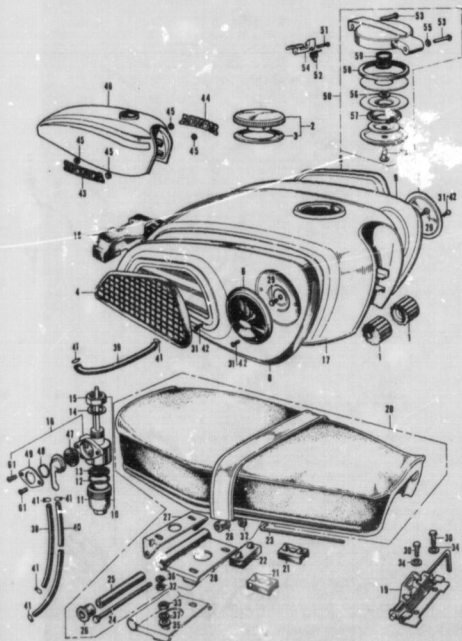

Ref. No.	Part No.	Description	Qty.	Ref. No. 18 1288 OR P 11	No. Used on	
					From	To
41	80002-00000	CLIP, fuel tube, 5/8	6	6		
42	80780-03006-0F	SCREW, oval, 3x6 (Used in Sweden)	4	-		
43	87121-292-670	EMBLEM, right fuel tank (Used in U.S.A.)	1	-	CB450	-000856
	87121-319-670	EMBLEM, right fuel tank	1	-	CB450	-3021592
44	87122-292-670	EMBLEM, left fuel tank (Used in U.S.A.)	2	-	CB450	-000856
	87122-319-670	EMBLEM, left fuel tank	1	-	CB450	-3021592
45	87311-616-000	NUT, rear attachment clamp (Used in U.S.A.)	4	-	CB450	-000856
		(Used in Euro. Gen. 128806, General export: Sweden, A-128806)	4	-	CB450	-3021592
46	17500-292-670XH	TANK COMP., fuel (Candy orange) (Used in U.S.A.)	1	-	CB450	-000856
	17500-292-670XJ	TANK COMP., fuel (Candy red) (Used in U.S.A.)	1	-	CB450	-000856
	17500-292-670AZ	TANK COMP., fuel (Candy blue green)	1	-	CB450	-000856
47	16953-283-000	PACKING, cock lever	1	1		
48	16955-816-004	SPRING, cock lever	1	1		
49	15961-298-000	PLATE, lever setting	1	1		
50	17510-300-163	CAP, fuel filler	1	-	CB450	-3021592
51	17513-300-300	PIN, fuel filter cap check	1	-	CB450	-3021592
52	17515-300-300	SPRING, cap check	1	-	CB450	-3021592
53	17516-500-300	PIN, fuel filter cap	2	-	CB450	-3021592
54	1717-300-300	CHECK, fuel filter cap	1	-	CB450	-3021592
55	17520-300-300	WASHER, fuel filter cap friction	1	-	CB450	-3021592
56	17523-300-000	WASHER, plain	1	-	CB450	-3021592
57	17524-300-000	SEPARATE A, top	1	-	CB450	-3021592
58	17525-300-000	PACKING, fuel filter cap	1	-	CB450	-3021592
59	17526-300-000	SPRING, SEAT	1	-	CB450	-3021592
60	80147-300-000	SCREW	1	-	CB450	-3021592
61	80560-03006-0F	SCREW, pan, 3x6	2	2	CB450	-3021592

F-7 Air Cleaner - Tool Box

E 4

F-7 Air Cleaner - Tool Box

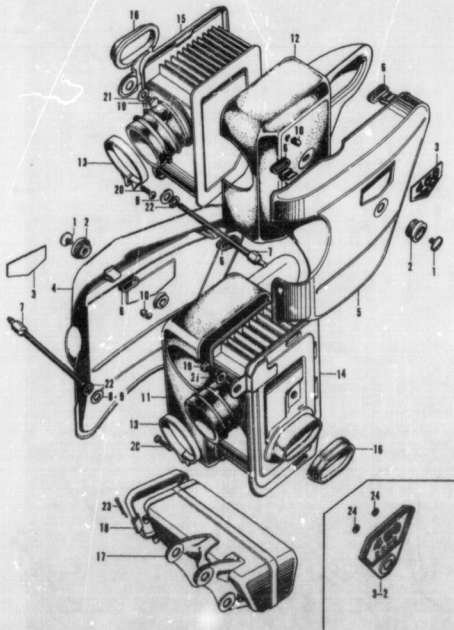

Ref. No.	Part No.	Description	Req. No. of Pkgs	No. Used on	
				From	To
1	90113-292-000	BOLT, air cleaner setting	2	2	CB450-300433
2	17245-292-000	GROMMET B, air cleaner case	2	-	-700432
	17245-292-000	GROMMET B, air cleaner case	2	3	CB450-300433
3	87130-292-010	EMBLEM, air cleaner case (Superseded by 87130 294-000)	-	-	-
	87130-294-000	EMBLEM, air cleaner case	2	2	-3008955
3-2	87130-294-010	EMBLEM, air cleaner case	2	2	CB450-3008956
4	17231-292-000B	CASE, right air cleaner (Black)	1	-	-3008955
	17231-292-000JK	CASE, right air cleaner (Candy red)	1	-	-3008955
	17231-292-000KK	CASE, right air cleaner (Candy blue)	1	-	-3008955
	17231-292-000Z	CASE, right air cleaner (Non sanding)	1	-	-3008955
	17231-292-000A	CASE, right air cleaner (White)	-	1	CB450P-3008574-3008955
4-1	17231-292-040XJ	CASE, right air cleaner (Candy orange)	1	-	CB450-3008956
	17231-292-040XK	CASE, right air cleaner (Candy red)	1	-	CB450-3008956-3021191
	17231-292-040AZ	CASE, right air cleaner (Candy blue green)	1	-	CB450-3008956
	17231-292-040Z	CASE, right air cleaner (Non sanding)	1	-	CB450-3008956
	17231-292-040A	CASE, right air cleaner (White)	-	1	CB450P-3008956
	17231-292-040CM	CASE, right air cleaner (Candy ruby red)	1	-	CB450-3021192
	17231-292-040CQ	CASE, right air cleaner (Candy gold)	1	-	CB450-3021192
5	17231-292-000B	CASE, left air cleaner (Black)	1	-	-3008955
	17231-292-000JK	CASE, left air cleaner (Candy red)	1	-	-3008955
	17231-292-000KK	CASE, left air cleaner (Candy blue)	1	-	-3008955
	17231-292-000Z	CASE, left air cleaner (Non sanding)	1	-	-3008955
	17231-292-000A	CASE, left air cleaner (White)	-	1	CB450P-3008574-3008955
	17231-292-040XJ	CASE, left air cleaner (Candy orange)	1	-	CB450-3008956
	17231-292-040XK	CASE, left air cleaner (Candy red)	1	-	CB450-3008956-3021191
	17231-292-040AZ	CASE, left air cleaner (Candy blue green)	1	-	CB450-3008956
	17231-2-2-040Z	CASE, left air cleaner (Non sanding)	1	-	CB450-3008955
	17231-292-040A	CASE, left air cleaner (White)	-	1	CB450P-3008955
	17231-292-040CM	CASE, left air cleaner (Candy ruby red)	1	-	CB450-3021192
	17231-292-040CQ	CASE, left air cleaner (Candy gold)	1	-	CB450-3021192
6	17247-292-010	GROMMET A, air cleaner	4	4	-
7	90110-292-000	BOLT, right air cleaner setting	1	-	-300432
	90110-292-000	BOLT, right air cleaner setting	2	2	CB450-300433
8	90834-292-303	WASHER, air cleaner setting	1	-	-300432
9	90465-293-000	WASHER, air cleaner setting	2	2	-
10	17257-293-000	RUBBER, air cleaner shock proof	2	2	-

F-7 Air Cleaner - Tool Box

E 5

F-7 Air Cleaner - Tool Box

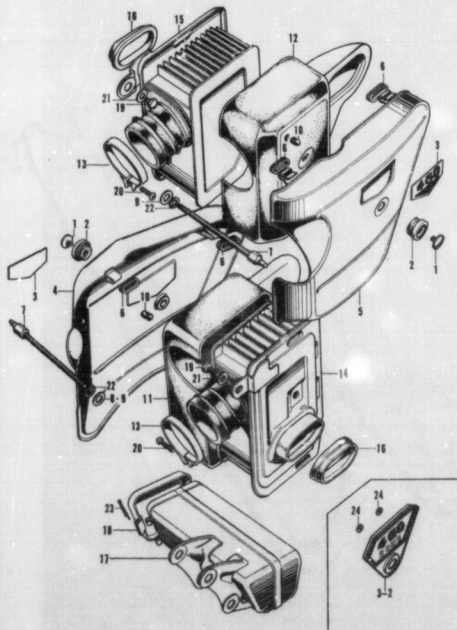

Ref. No.	Part No.	Description	Repl. No.		No. Used on	
			15 1148	28 71 11	From	To
11	17214-283-000	COVER, right air cleaner	1	1		
12	17313-282-000	COVER, left air cleaner	1	1		
13	17255-283-010	BAND, air cleaner connecting tube	2	2		
14	17211-292-014	ELEMENT, right air cleaner	1	1		
15	17311-092-014	ELEMENT, left air cleaner	1	1		
16	17213-292-000	TUBE, air cleaner joint	2	2		
17	83500-283-010B	BOX COMP., tool (Black)	1	-		CB400P-3008534
	83500-283-010Z	BOX COMP., tool (Non sanding)	1	-		
	83500-283-010A	BOX COMP., tool (White)	-	1		CB400P-3008534
18	83541-283-000B	CAP, tool box (Black)	1	-		
	83541-283-000Z	CAP, tool box (Non sanding)	1	-		
	83541-283-000A	CAP, tool box (White)	-	1		CB400P-3008534
19	92900-06010	BOLT, hex., 6x10	2	2		
20	93500-06016-0A	SCREW, pan, 5x16	2	2		
21	94101-06000	WASHER, plain, 6 mm	2	2		
22	94111-06000	WASHER, spring, 6 mm	2	2		
23	94301-02500	PIN, cotter, 2.5 mm	1	1		
24	90313-512-000	NUT, push, round type, 3 mm	4	4		CB400-3008506

F-8 Exhaust Muffler

E 6

F-8 Exhaust Muffler

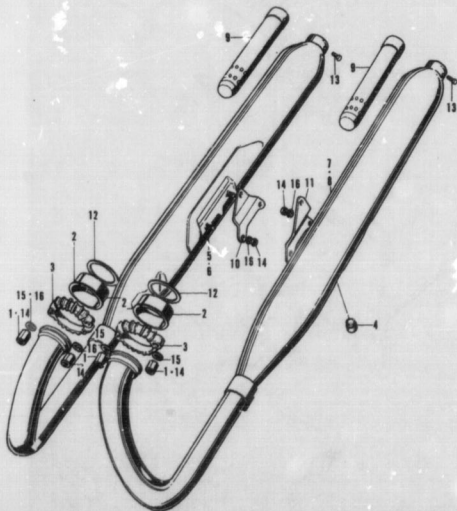

Ref. No.	Part No.	Description	Req'd. No.		No. Used on	
			13 1548	48 P1 8	From	To
1	90311-283-000	NUT, exhaust pipe joint	4	-		300293
2	18293-283-010	COLLAR, exhaust pipe joint	4	4		
3	18231-283-010	JOINT, exhaust pipe				
		(Superseded by 18231-292-000)				
	18231-292-000	JOINT, exhaust pipe	2	-		
	18231-292-010	JOINT, exhaust pipe	2	2	CB450 -3002254 -3013079	
	18231-292-020	JOINT, exhaust pipe	2	2	CB450 -3013090	
4	50643-283-000	RUBBER, side stand stopper	1	1		
5	18300-292-000	MUFFLER COMP., right exhaust	1	1		
6	18300-292-010	MUFFLER COMP., right exhaust (Used in Germany, France & Sweden)	1	-		
		Part No. 18300-292-000 (Ref. No. 5) is used on all Sweden export models from serial No. CB450-3007754 to CB450-3014899.				
7	18400-292-000	MUFFLER COMP., left exhaust	1	1		
8	18400-292-010	MUFFLER COMP., left exhaust (Used in Germany, France & Sweden)	1	-		
		Part No. 18400-292-000 (Ref. No. 7) is used on all Sweden export models from serial No. CB450-3007754 to CB450-3014899.				
9	18311-283-010	PIPE, exhaust diffuser (Used in Germany, France & Sweden)	2	-		
		Deleted from serial 14, CB450-3007754 to CB450-3014899 for Sweden export model.				
10	18303-292-000	BRACKET, right muffler	1	1		
11	18304-292-000	BRACKET, left muffler	1	1		
12	18291-283-010	GASKET, exhaust pipe	2	2		
13	92000-06010-02	BOLT, hex., 6x10	2	2		
14	94001-08000-05	NUT, hex., 8 mm	4	4		
		NUT, hex., 8 mm (Change to req'd No.)	8	8		
15	94111-08000	WASHER, spring, 6 mm	2	2		
16	94111-08000	WASHER, spring, 8 mm	4	4		
		WASHER, spring, 8 mm (Change to req'd No.)	8	8		

F-9 Rear Wheel

E 7

F-9 Rear Wheel

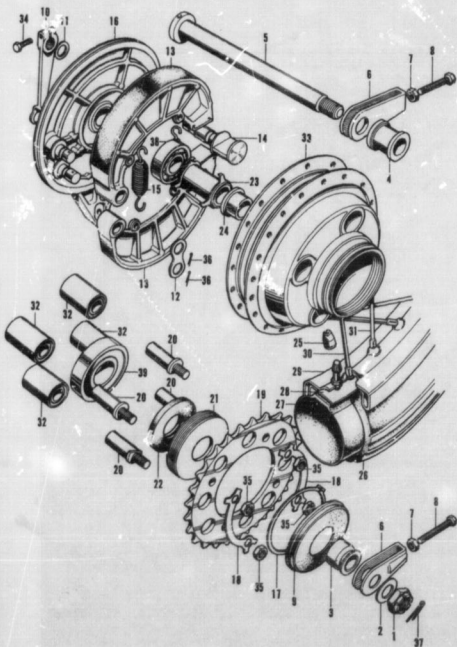

Ref. No.	Part No.	Description	Repl. No.		No. Used on	
			14 1148	48 71 II	From	To
1	90906-208-000	NUT, rear axle	1	1		
2	90823-202-000	WASHER, 18.5x34	1	1		
3	42111-283-000	COLLAR, rear wheel side	1	1		
4	42513-202-000	COLLAR, rear brake panel side	1	1		
5	42001-202-000	AXLE, rear wheel	1	1		
6	40832-283-010	ADJUSTER, drive chain	2	2		
7	90907-283-000	NUT, chain adjuster	2	2		
8	90119-283-000	BOLT, chain adjuster	2	2		
9	43633-283-000	CAP, bearing retainer	1	1		
10	43411-283-000	ARM, rear brake	1	1		
11	45134-250-000	DUST-SEAL, rear brake	1	1		
12	41106-225-300	WASHER, rear brake anchor pin	1	1		
13	41310-283-000	SHOE COMP., rear brake	2	2		
14	41141-216-000	CAM, rear brake	1	1		
15	41351-283-000	SPRING, brake shoe	2	2		
16	43100-283-000	PANEL COMP., rear brake	1	1		
17	90969-283-000	CIR-CLIP, 7.8 mm	1	1		
18	90623-283-000	WASHER, tongue, 10 mm	1	1		
19	41301-283-000	SPROCKET, final driven (S.T.D. 36T)	1	1		
	41301-283-810	SPROCKET, final driven (Optional parts 34T)	1	-		
	41301-283-830	SPROCKET, final driven (Optional parts 36T)	1	-		
	41301-283-830	SPROCKET, final driven (Optional parts 38T)	1	-		
	41301-283-840	SPROCKET, final driven (Optional parts 39T)	1	-		
	41301-283-850	SPROCKET, final driven (Optional parts 37T)	1	-		
	41301-283-890	SPROCKET, final driven (Optional parts 32T)	1	-		
	41301-283-870	SPROCKET, final driven (32T) (Used in Germany, France & Sweden)	1	-		
	Part No. 41301-283-000 is used on all Sweden export models from serial No. CB450-300754.					
20	90128-202-000	BOLT, driven sprocket fixing	4	4		
21	41231-283-000	RETAINER, rear wheel bearing	1	1		
22	90753-283-000	OIL-SEAL, 34059	1	1		
23	42009-202-000	COLLAR, rear axle distance	1	1		
24	42025 203-000	COLLAR B, rear axle distance	1	1		

F-9 Rear Wheel

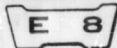

F-9 Rear Wheel

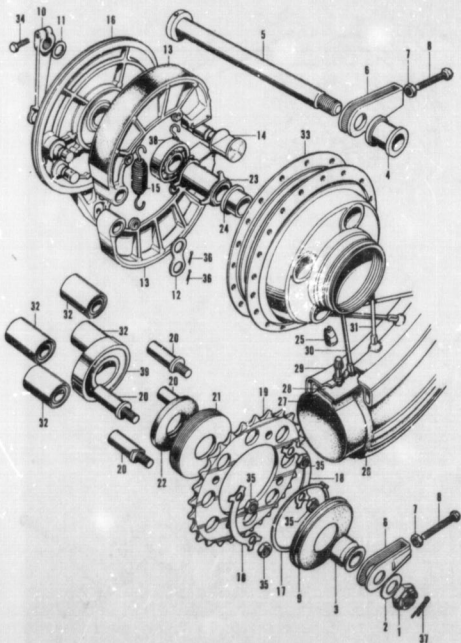

Ref. No.	Part No.	Description	Reqd. Qty.	No. Used on	
			11 1100 48 71 g	From	To
25	4407-283-000	BALANCER, wheel (2lg)		0-2	
	4407-283-000	BALANCER, wheel (1lg)		0-2	
	4408-283-007	BALANCER, wheel (1lg)		0-2	
	4409-283-000	BALANCER, wheel (lg)		0-2	
26	42711-292-014	TIRE, rear wheel (3.50-18" DUNLOP) (Sup-eded by 42711-292-014)			
	42711-292-014	TIRE, rear wheel (3.50-18" DUNLOP) (Superseded by 42711-292-014)			
	42711-292-014	TIRE, rear wheel (3.50-18" DUNLOP) (Superseded by 42711-292-014)			
	42711-292-044	TIRE, rear wheel (3.50-18" DUNLOP) 1 1			
27	42713-283-000	TUBE, rear wheel (3.50-18") 1 1			
28	44713-283-000	FLAP, tire (18") 1 1			
29	42701-283-003	RIM, rear wheel (DAIDO) 1 1			
30	43601-283-000	SPOKE A, rear (Inside) 20 20			
31	43604-283-000	SPOKE B, rear (Out side) 20 20			
32	41241-283-010	BUSH, rear wheel damper 4 4			
33	43602-292-000	HUB COMP., rear wheel 1 1	CB450	-	-3024649
	43602-292-010	HUB COMP., rear wheel 1 -			CB450-3024641
34	93000-06520-08	BOLT, hex, 6x20 1 1			
35	94003-10000-05	NUT, thin, 10 mm 4 -			
35-1	90310-286-000	NUT, driven sprocket 4 4			
36	94001-04200	PIN, outer, 2.5 mm 2 2			
37	94201-42000	PIN, outer, 4.0 mm 1 1			
37	96120-63040	BEARING, ball, 6304G 1 1			
38	96120-63090	BEARING, ball, 6309G 1 1			

F-10 Rear Cushion

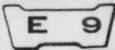

F-10 Rear Cushion

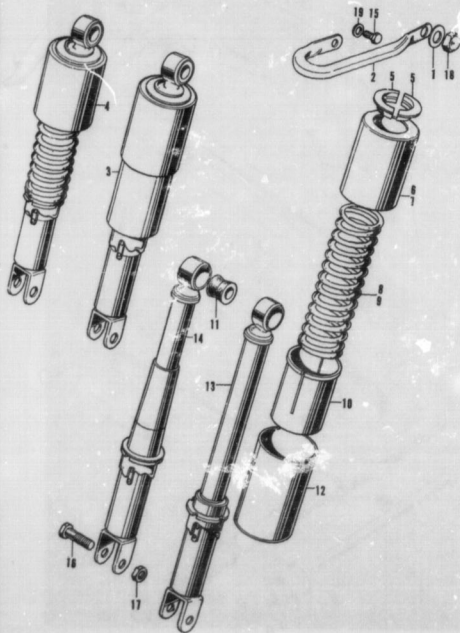

Ref. No.	Part No.	Description	Repl. No. 13 14 00 05 11 2	No. Used on	
				From	To
1	90521-292-000	WASHER, 10.3 mm	2	2	
2	30316-292-000	GRIP, cyl.	1	-	
3	5180-292-010B	CUSHION ASSY., rear (Black)	2	-	CB450 - ~3021591
	52400-292-010XK	CUSHION ASSY., rear (Candy red)	2	-	CB450 - ~3021591
	52400-292-010XK	CUSHION ASSY., rear (Candy blue)	2	-	CB450 - ~3021591
	52400-292-010A	CUSHION ASSY., rear (White)	2	-	CB450P-3008534
4	52400-292-670XW	CUSHION ASSY., rear (Chrome) (Used in U.S.A.)	2	-	
	52400-292-670XW	CUSHION ASSY., rear (Chrome) (Used in Australia, General export, Germany, England, France, Sweden)	2	-	CB450 -3021592
5	52424-292-000	STOPPER, spring rear	4	4	
6	52421-292-000B	CASE, rear cushion upper (Black)	2	-	CB450 - ~3021591
	52421-292-000JK	CASE, rear cushion upper (Candy red)	2	-	CB450 - ~3021591
	52421-292-000XK	CASE, rear cushion upper (Candy blue)	2	-	CB450 - ~3021591
	52421-292-000Z	CASE, rear cushion upper (Non sanding)	2	-	CB450 - ~3021591
	52421-292-000A	CASE, rear cushion upper (White) (Used in U.S.A.)	2	-	
7	52421-292-670XW	CASE, rear cushion upper (Chrome) (Used in U.S.A.)	2	-	
	52421-292-670XW	CASE, rear cushion upper (Chrome) (Used in Australia, Gen. port, Germany, England, France, Sweden)	2	-	CB450 -3021592
8	52401-292-000	SPRING, rear cushion	2	2	CB450 - ~3021591
9	52401-292-670	SPRING, rear cushion (Used in U.S.A.)	2	-	
	52401-292-670	SPRING, rear cushion (Used in U.S.A.) (Used in Australia, General export, Germany, England, France, Sweden)	2	-	CB450 -3021592
10	52405-292-000	GUIDE, rear cushion spring	2	2	CB450 - ~3021591
11	52484-292-000	RUBBER, joint	2	2	
12	52436-292-000	CASE, rear cushion bottom	2	2	CB450 - ~3021591
13	52419-292-0C3	DAMPER ASSY., rear	2	2	CB450 - ~3021591
	52419-292-0C3	DAMPER ASSY., rear (Used in Australia, General export, Germany, England, France, Sweden)	2	2	CB450 -3021592
14	52410-292-670	DAMPER ASSY., rear (Used in U.S.A.)	2	-	
15	92000-09016	BOLT, hex., 6 x 10	1	-	
16	93300-10036-0B	BOLT, hex., 10 x 36	2	2	
17	94302-10000-6S	NUT, thin, 10 mm	2	2	
18	94302-10030-6S	NUT, cap, 10 mm	2	2	
19	94101-00000	WASHER, plain, 6 mm	1	-	

F-14 (1) Winker
(Used in U.S.A., General, France, England & Australia)

F 1

F-14 (1) Winker
(Used in U.S.A., General, France, England & Australia)

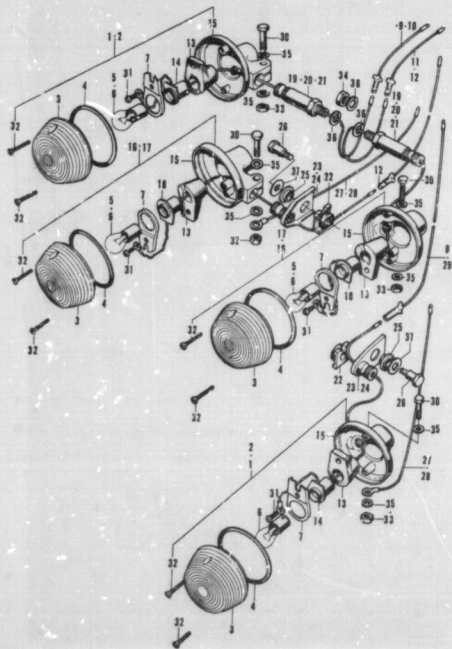

Ref. No.	Part No.	Description	Ref. No.		No. Used on	
			21 148	29 71 1	From	To
1	33400-292-003	WINKER ASSY., right (STANLEY) (Used in General, France & Australia)	2	-		
2	33400-292-070	WINKER ASSY., right (Used in U.S.A. & England)	2	2		
3	33400-292-071	LENS, winker	4	4		
4	33443-292-071	PACKING, winker lens	4	4		
5	34005-298-071	BULB, winker (11V SW) (Used in U.S.A. & England)	4	4		
6	34005-294-000	BULB, winker (11V 10W) (Used in General, France & Australia)	4	-		
7	33407-294-070	HOLDER, winker socket	4	4		
8	33410-292-090	SUB CORD, right front winker (Used in Australia as right rear winker sub cord.)	1	-		
9	33410-292-770	SUB CORD, right front winker	-	1	CB450P-300634	
10	33410-292-650	SUB CORD, right 'front winker (Used in Australia)	1	-	CB450 -3011904	
11	33460-292-770	SUB CORD, left front winker	-	1	CB450P-300634	
12	33460-292-650	SUB CORD, left front winker (Used in Australia)	2	-	CB450 -3011904	
13	33408-294-000	CUSHION, winker rubber	4	4		
14	33403-292-003	SOCKET COMP., right winker (STANLEY)	2	2		
15	33401-712-003	BASE, winker (STANLEY)	4	4		
16	33450-292-003	WINKER ASSY., left (STANLEY) (Used in General, France & Australia)	2	2		
17	33450-292-070	WINKER ASSY., left (Used in U.S.A. & England)	2	2		
18	33453-292-003	SOCKET COMP., left winker	2	2		
19	90154-298-070	BOLT, light case setting (Used in U.S.A.)	2	2		
20	90154-292-000	BOLT, light case setting (Used in General, England & France)	2	-		
21	90154-292-610	BOLT, front winker setting (Used in Australia)	2	-	CB450 -3011904	
22	33908-292-020	RUBBER, rear winker mount	2	2		
23	33607-292-000B	STAY, rear winker (Black)	2	-		
	3377-25-000A	STAY, rear winker (White)	-	2	CB450P-300634	
24	34007-292-650B	STAY, rear winker (Black) (Used in Australia)	2	-	CB450 -3011904	
25	33959-292-000	RUBBER B, rear winker mount	2	2		
26	90155-270-010	BOLT, rear winker set	2	2		
27	33603-292-400	CORD, rear winker earth (Not used in Australia)	2	2		
28	33603-292-650	CORD, rear winker earth (Used in Australia)	2	2	CB450 -3011904	

F-16 Wire Harness - Battery

F 10

F-16 Wire Harness - Battery

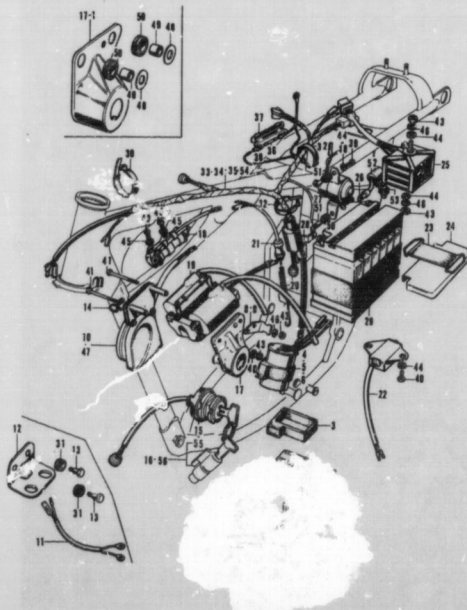

Ref. No.	Ptn. No.	Description	Q'ty Used as	
			From	To
28-1	9200-06020	BOLT, hex., 6x20	2	2
29	9200-06012	BOLT, hex., 6x12	2	2
41	9200-06080	BOLT, hex., 6x80	2	-
41-1	9200-06090	BOLT, hex., 6x90	2	2
42	9200-09008-0A	SCREW, pan., 5x8	2	2
43	9401-06000	NUT, hex., 6 mm	4	4
44	94101-06000	WASHER, plain, 6 mm	6	6
		WASHER, plain, 6mm (Change to req'd No.)	4	4
45	94111-05000	WASHER, spring, 5 mm	2	2
46	94111-06000	WASHER, spring, 6 mm	4	4
47	30100-286-620	HORN ASSY, (Used in Fence)	1	-
48	90681-701-000	WASHER, 18 mm	2	-
		WASHER, 18 mm (Change to req'd No.)	4	4
49	84796-286-000	COLLAR, stanchion bracket set	2	2
50	84795-292-000	RUBBER, stanchion bracket cushion	2	-
		RUBBER, stanchion bracket cushion (Change to req'd No.)	4	4
51	35851-292-010	COLLAR, starter magnetic switch set	2	2
52	31468-268-100	COVER, battery terminal	1	1
53	32411-253-300	COVER, starting motor terminal	3	3
54	32100-292 753	HARNES, wire	-	1
55	30100-280-751	SWITCH ASSY, combination	-	1
56	30010-292-751	SWITCH KIT, combination	-	1

CB400 -3003134-3006375

CB400 -3006376

CB400 -3003134

3480 -3003134-3006375

CB400 -3006376

CB400 -3006376

CB400 -3006376

CB400 -3006376

CB400P-3006571

CB400P-3006571

CB400P-3006571

CB400P-3006571

F-17 Main Stand - Step

F 11

F-17 Main Stand - Step

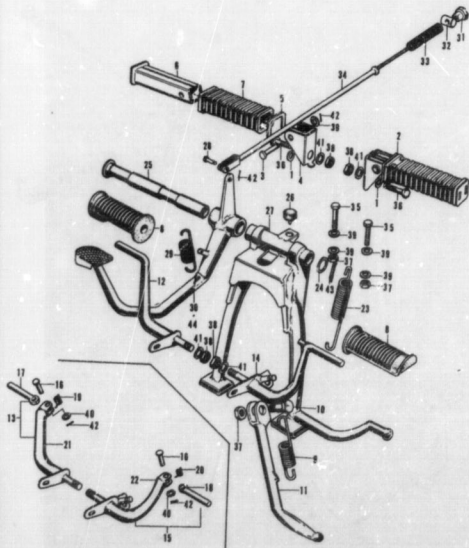

Ref. No.	Part No.	Description	Reqd. No. 18 2108 28 21 9	No. Used on	
				From	To
1	90638-283-303	WASHER, pillow step	2	-	
2	50710-282-000	STEP ASSY, pillow step	2	-	
3	50714-283-010	PIN, pillow step	2	-	
4	50711-282-000	BRACKET, pillow step	2	-	
5	50712-024-000	WASHER, pillow step	2	-	
6	50715-283-000	BAR, pillow step	2	-	
7	50705-024-000	RUBBER, pillow step	1	-	
8	50661-283-010	RUBBER, step	2	2	
9	50543-273-000	SPRING, side stand (Superseded by 50543-286-000)			
	50543-286-000	SPRING, side stand	1	1	
10	90108-283-000	SCREW, side stand pivot	1	1	
11	50830-283-670	BAR, side stand	1	1	
	50830-283-000B	STEP ASSY, right (Black)	1	-	-3004170
	50830-282-010B	STEP ASSY, right (Black)	1	-	CB450 -3004171
	Part No. 50930-282-671B (Ref. No. 13-1) is used on all Sweden export models from serial No. CB450-3007745.				
	50830-282-670B	STEP ASSY, right (Black) (Used in U.S.A.)	1	-	-3004170
	50830-282-671B	STEP ASSY, right (Black) (Used in U.S.A.)	1	-	CB450 -3004171
	50830-282-671A	STEP ASSY, right (White)	-	1	CB450P-3008534
14	50640-282-000B	STEP ASSY, left (Black)	1	-	-3004170
	50640-282-010B	STEP ASSY, left (Black)	1	-	CB450 -3004171
	Part No. 50640-282-671 (Ref. No. 15-1) is used on all Sweden export models from serial No. CB450-3007745.				
	50640-282-670B	STEP ASSY, left (Black) (Used in U.S.A.)	1	-	-3004170
	50640-282-671B	STEP ASSY, left (Black) (Used in U.S.A.)	1	-	CB450 -3004171
	50640-282-671A	STEP ASSY, left (White)	-	1	CB450P-3008534
16	50693-033-000	PIN, step bar joint (Used in U.S.A.)	2	2	
17	50616-283-020B	ARM, right step (Black) (Used in U.S.A.)	1	-	
	50616-283-020A	ARM, right step (White)	-	1	CB450P-3008534
18	50643-283-020B	ARM, left step (Black) (Used in U.S.A.)	1	-	
	50643-283-020A	ARM, left step (White)	-	1	CB450P-3008534
19	50617-283-000	SPRING, right step return (Used in U.S.A.)	1	1	
20	50644-233-000	SPRING, left step return (Used in U.S.A.)	1	1	

F-17 Main Stand - Step

F 12

F-17 Main Stand - Step

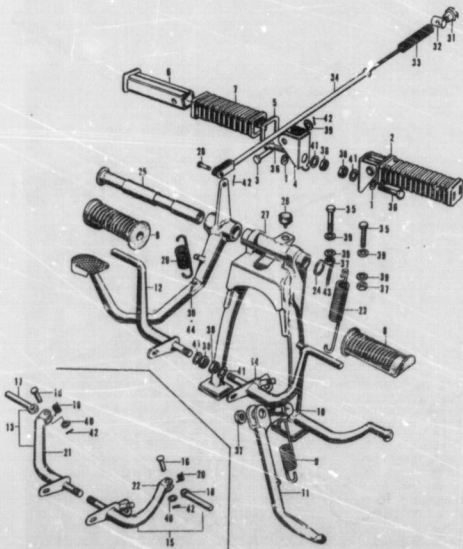

Part No.	Part No.	Description	Part No.		No. Used on
			24	25	
21	50638-292-670B	BAR, right step (Black)	1	-	-3004170
	50638-292-671B	BAR, right step (Black)	1	-	CB450 -3004171
22	50648-292-670B	BAR, left step (Black)	1	-	-3004170
	50648-292-671B	BAR, left step (Black)	1	-	CB450 -3004171
23	50622-283-000	SPRING, main stand			
	(Superseded by 50622-292-000)				
	50629-292-000	SPRING, main stand	1	-	-3003360
	50322-292-015	SPRING, main stand	1	1	CB450 -3003364
24	90512-283-000	WASHER, 19 mm	1	1	
25	50636-292-000	PIPE, main stand pivot	1	1	
26	50624-011-000	RUBBER, main stand stopper	1	1	
27	50550-292-000B	STAND, main (Black)	1	-	
	50550-292-000A	STAND main (White)	-	1	CB450P-3005534
28	43471-292-000	PIN, brake rod joint			
	(Superseded by 43471-292-010)				
	43471-292-010	PIN, brake rod joint	1	1	
29	46514-283-050	SPRING, brake pedal	1	1	
30	46500-292-040	PEDAL COMP., brake	1	-	
31	43486-292-000	NUT, rear brake adjusting	1	1	
32	43483-292-000	JOINT, rear brake arm	1	1	
33	43472-212-000	SPRING, rear brake arm	1	1	
34	43461-292-010	ROD, rear brake	1	-	-3001321
	43461-292-020	ROD, rear brake	1	1	CB450 -3001322
35	92000-06040	BOLT, hex., 6x40	2	2	
36	92000-10036-6A	BOLT, hex., 10x36	2	2	
37	94001-06000	NUT, hex., 6 mm	2	2	
38	94001-10000-05	NUT, hex., 10 mm	5	3	
39	94101-06000	WASHER, plain, 6 mm	6	4	
40	94101-08000	WASHER, plain, 8 mm	2	2	
41	94111-10000	WASHER, split, 10 mm	4	2	
42	94201-16150	PIN, split, 1.6 mm	5	3	
43	94201-12250	PIN, split, 2.5 mm	1	1	
44	46000-292-750	PEDAL, rear brake	-	1	CB450P-3009534

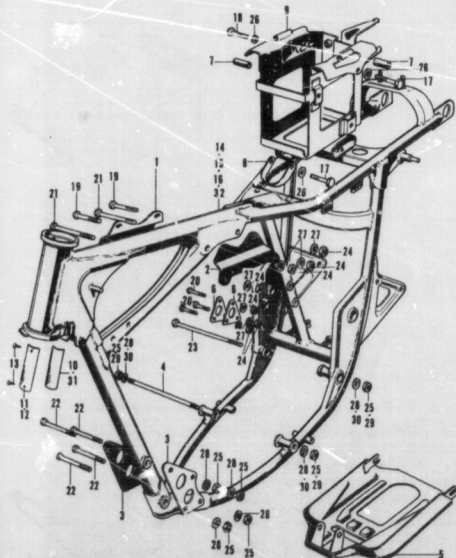

Ref. No.	Part No.	Description	Mand. No.		No. Used on	
			18 1808	08 F1 II	From	To
1	50354-292-010P	PLATE, right upper engine hanger (Black)	1	-		
	50354-292-010Z	PLATE, right upper engine hanger (Non sanding)	1	-		
	50354-292-010A	PLATE, right upper engine hanger (White)	1	-	CB450P-300834	
2	50355-292-010P	PLATE, left upper engine hanger (Black)	1	-		
	50355-292-010Z	PLATE, left upper engine hanger (Non sanding)	1	-		
	50355-292-010A	PLATE, left upper engine hanger (White)	1	-	CB450P-300834	
3	50351-293-010B	PLATE, front engine hanger (Black)	2	-		
	50351-293-010Z	PLATE, front engine hanger (Non sanding)	2	-		
	50351-293-010A	PLATE, front engine hanger (White)	2	-		
4	50106-292-000	BOLT, engine hanger (10 mm)	1	-		-3004170
	50106-292-010	BOLT, engine hanger (17 mm)	1	1	CB450 -3004171	
5	50351-294-030B	PLATE, skid (Black) (Optional parts)	1	-		-2004170
	50351-294-030B	PLATE, skid (Black) (Optional parts)	1	1	CB450 -3004171	
6	50356-293-000B	PLATE, rear engine hanger (Black)	2	-		
	50356-293-000Z	PLATE, rear engine hanger (Non sanding)	2	-		
	50356-293-000A	PLATE, rear engine hanger (White)	2	-	CB450 -3004171	
7	50328-292-010	COLLAR, battery box	2	2		
8	50327-3-2-000B	STAY, battery box lower (Black)	1	-		
	50327-292-000A	STAY, battery box lower (White)	1	-	CB450P-300834	
9	50325-292-322B	BOX, battery (Black)	1	-		
	50325-292-322A	BOX, battery (White)	1	-	CB450P-300834	
10	87125-041-080	PLATE, name	1	1		
		Part No. 87121-296-070 (Ref. No. 29) is used on U.S.A. export models from serial No. CB450-3009238.				
11	87501-293-610	PLATE, registered number (Used in Germany & Sweden)	2	-		-3001323
	51901-292-610	PLATE, registered number (Used in Germany & Sweden)	1	-		
12	87501-293-620	PLATE, registered number (Used in France)	1	-		
13	90841-071-000	SCREW, rivet, 1.5x5 (Used in Germany, France & Sweden)	2	-		
14	50100-292-070B	BODY COMP., frame (Black)	1	-		-3003363
		(Superseded by 50100-292-080B with 50522-292-010)				
	50100-292-070Z	BODY COMP., frame (Non sanding)	1	-		-3003363
		(Superseded by 50100-292-080Z with 50522-292-010)				
	50100-292-080B	BODY COMP., frame (Black)	1	-	CB450 -3003364 -3004179	

F18 Frame

F 14

F-18 Frame

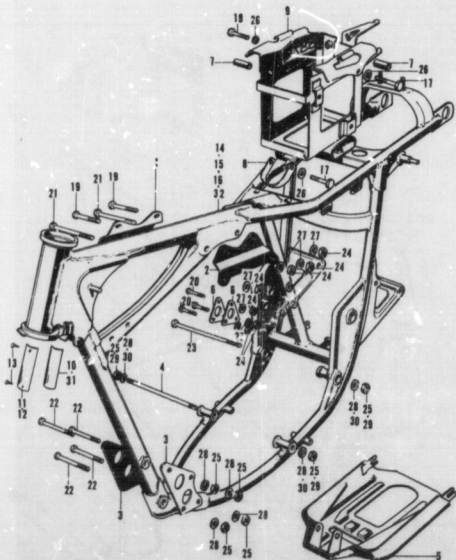

Ref. No.	Part No.	Description	Repl. No. 18 19 20 F18	No. Used on	
				From	To
	50100-292-060Z	BODY COMP., (Non sanding)	1	-	CB450-3003364-3004170
	50100-292-067B	BODY COMP., frame (Black)	1	-	CB450-3004171-3008955
	50100-292-060Z	BODY COMP., (Non sanding)	1	-	CB450-3004171-3008955
	50100-292-100B	BODY COMP., frame (Black)	1	-	CB450-3008956
	50100-292-100Z	BODY COMP., frame (Non sanding)	1	-	CB450-4008956
18	50100-292-610B	BODY COMP., fr. w. (Black) (Used in Germany & Sweden)	1	-	-3003363
	(Superseded by 50100-292-611B with 50622-292-610)				
	50100-292-610Z	BODY COMP., frame (Non sanding)	1	-	-3003363
	(Used in Germany & Sweden)				
	(Superseded by 50100-292-611Z with 50622-292-610)				
	50100-292-611B	BODY COMP., frame (Black) (Used in Germany & Sweden)	1	-	CB450-3C3364-3004170
	50100-292-611Z	BODY COMP., frame (Non sanding)	1	-	CB450-3003364-3004170
	(Used in Germany & Sweden)				
	50100-292-612B	BODY COMP., frame (Black) (Used in Germany & Sweden)	1	-	CB450-3004171-3008955
	Part No. 50100-292-090B (Ref. No. 14-2) is used on all Sweden export models from serial No. CB450-3007765.				
	50100-292-612Z	BODY COMP., frame (Non sanding)	1	-	CB450-3004171-3008955
	Part No. 50100-292-090Z (Ref. No. 14-2) is used on all Sweden export models from serial No. CB450-3007765.				
	50100-292-613B	BODY COMP., frame (Black) (Used in France)	1	-	CB450-3008956
	50100-292-613Z	BODY COMP., frame (Non sanding)	1	-	CB450-3008956
	(Used in France)				
18	50100-292-620B	BODY COMP., frame (Black)	1	-	-3003363
	(Used in France)				
	50100-292-620Z	BODY COMP., frame (Non sanding)	1	-	-3003363
	(Used in France)				
	50100-292-621B	BODY COMP., frame (Black)	1	-	CB450-3003364-3004170
	(Used in France)				
	50100-292-621Z	BODY COMP., frame (Non sanding)	1	-	CB450-3003364-3004170
	(Used in France)				
	50100-292-622B	BODY COMP., frame (Black)	1	-	CB450-3004171-3008955
	(Used in France)				
	50100-292-622Z	BODY COMP., frame (Non sanding)	1	-	CB450-3004171-3008955
	(Used in France)				
	50100-292-623B	BODY COMP., frame (Black)	1	-	CB450-2308956
	(Used in France)				
	50100-292-623Z	BODY COMP., frame (Non sanding)	1	-	CB450-3008956
	(Used in France)				
17	92900-00040	BOLT, hex., 6x45	2	2	
18	92900-00045	BOLT, hex., 6x45	1	1	
19	92900-08067-0A	BOLT, hex., 8x57	2	2	
20	97900-08070-0A	BOLT, hex., 8x70	2	2	

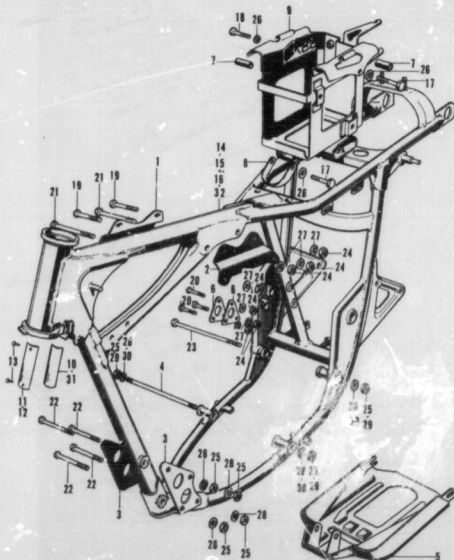

Ref. No.	Part No.	Description	Req'd. No.	No. Used on	
			11 F18	From	To
21	92200-G-087-G1	BOLT, hex, 8x87	2	2	
22	92300-10090-0A	BOLT, hex, 10x90	4	2	
23	92300-10275-0A	BOLT, hex, 10x275	1	-	
	92300-12275-0A	BOLT, hex, 12x275	1	1	
24	94001-08000-0S	NUT, hex, 8 mm	7	7	
25	94001-10000-0S	NUT, hex, 10 mm	7	-	
		NUT, hex, 10 mm (Change to req'd No.)	4	4	
26	94101-06000	WASHER, plain, 6 mm	3	3	
27	94111-08000	WASHER, spring, 8 mm	7	7	
28	94111-10000	WASHER, spring, 10 mm	8	-	
		WASHER, spring, 10 mm (Change to req'd No.)	4	4	
29	94002-12000-0S	NUT, thin, 12 mm	3	3	
30	94111-12000	WASHER, spring 12mm	4	4	
31	87131-286-070	LABEL, safety (Used in U.S.A.)	1	1	CB-30 -3008508
32	50300-292-770A	BODY COMP., frame (White)	-	1	CB405P-3008504 - 3008950
	90150-292-771A	BODY COMP., frame (White)	-	1	CB405P-307696

F-19 Tool

F 16

F-19 Tool

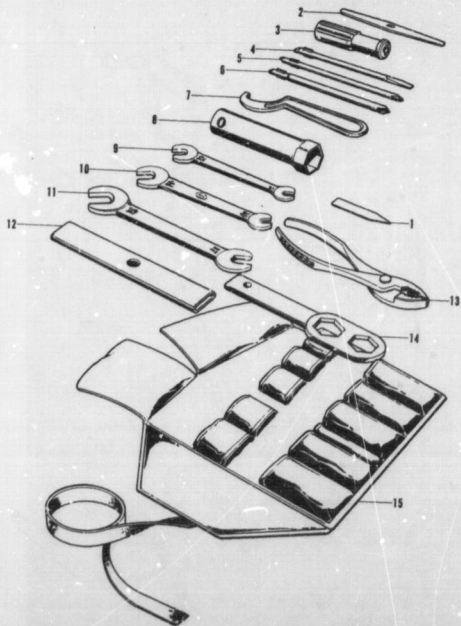

Ref. No.	Part No.	Description	Repl. No. 19 1108 OR 71 11	No. Used on	
				From	To
1	80231-283-010	GAUGE, support clamp, & adjusting	1	1	
2	99003-60000	LATER	1	1	
3	99003-50000	GRIP	1	1	
4	99003-30000	DRIVER, #2 minus	1	1	
5	99003-20000	DRIVER, #3 plus	1	1	
6	99003-10000	DRIVER, #2 plus	1	1	
7	80206-283-000	SPANNER, pin, 45 mm	1	1	
8	80216-283-000	BOX, plug	1	1	
9	99001-08120	SPANNER, 8x12	1	1	
10	99001-10140	SPANNER, 10x14	1	1	
11	99001-17190	SPANNER, 17x19	1	1	
12	80203-283-000	ARM, axle wrench	1	1	
13	99002-15000	PLIERS, 150 mm	1	1	
14	80202-283-000	WRENCH, axle	1	1	
15	80101-283-010	BAG, tool	1	1	
16	80010-292-689	TOOL SET	1	1	

F-14 (1) Winker
(Used in U.S.A., General, France, England & Australia)

F 2

F-14 (1) Winker
(Used in U.S.A., General, France, England & Australia)

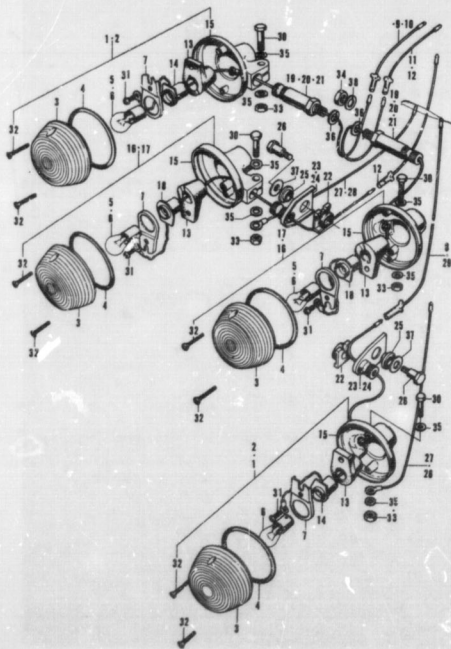

Ref. No.	Part No.	Description	No. Used on	
			11 2428 08 74 II	From To
29	30616-292-303	CORD, sub winker	1	-
30	92000-06008-018	BOLT, hex, 6 x 28	4	4
31	93000-06008-0A	SCREW, pan, 5 x 8	4	4
32	93700-03025-02	SCREW, oval, 3 x 25	8	8
33	94001-06000	NUT, hex., 6 mm	4	4
34	94001-10000-05	NUT, hex., 10 mm	2	2
35	94101-06000	WASHER, plain, 6 mm	8	8
36	94101-10000	WASHER, plain, 10 mm	2	2
37	94101-12000	WASHER, plain, 12 mm	2	2
38	94111-10000	WASHER, spring, 10 mm	2	2

F-14 (2) Winker
(Used in Germany & Sweden)

F 3

F-14 (2) Winker
(Used in Germany & Sweden)

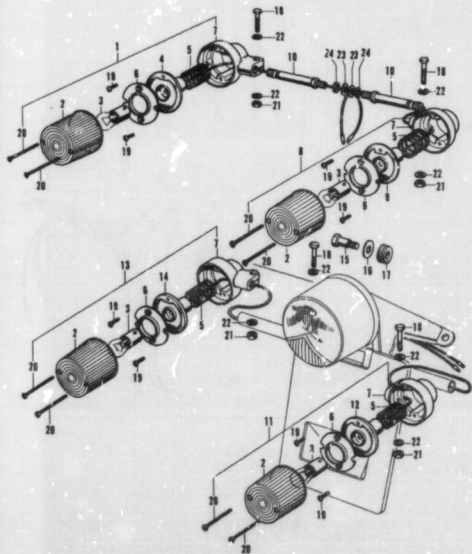

Part No.	Description	Part No.		No. Used on	
		01 010	02 010	From	To
1	3340-292-611 WINKER ASSY., right front	1	-		
2	3340-298-610 LENS, winker	4	-		
3	BULB, winker (12V 18W) (To be locally purchased in Germany & Sweden)	4	-		
4	3340-292-610 SOCKET ASSY., right front winker	1	-		
5	33413-385-000 SPRING, coil	4	-		
6	33411-285-000 RING	4	-		
7	13005-292-610 BASE, winker	4	-		
8	23450-292-611 WINKER ASSY., left front	1	-		
9	33460-292-610 SOCKET ASSY., left front winker	1	-		
10	90154-292-610 BOLT, front winker setting	2	-		
11	33600-292-610 WINKER ASSY., right rear	1	-		
12	33610-292-610 SOCKET ASSY., right rear winker	1	-		
13	33605-292-610 WINKER ASSY., left rear	1	-		
14	33660-292-610 SOCKET ASSY., left rear winker	1	-		
15	90156-292-671 BOLT, rear tender set <i>Deleted from serial No. CB450-300745 for Sweden model.</i>	2	-		
16	90530-286-600 WASHER, 12x32 <i>Deleted from serial No. CB450-300745 for Sweden model.</i>				
17	80102-292-670 RUBBER, rear tender set <i>Deleted from serial No. CB450-300745 for Sweden model.</i>	2	-		
18	52000-00028-02 BOLT, hex., 6x28	4	-		
19	93000-03010-0A SCREW, pan, 3x10	8	-		
20	93700-03045-0B SCREW, oval, 3x45	8	-		
21	9401-06000 NUT, hex., 6 mm	4	-		
22	94101-06200 WASHER, plain, 6 mm	8	-		
23	94101-10200 WASHER, plain, 10 mm	2	-		
24	94111-10200 WASHER, spring, 10 mm	2	-		

W Winker under F-14 (1) Mock for U.S.A. model are commonly used on the model for Sweden from serial No. CB450-300745.

F-15 (1) Tail Light
(Used in U.S.A., France, General & Australia)

F 4

F-15 (1) Tail Light
(Used in U.S.A., France, General & Australia)

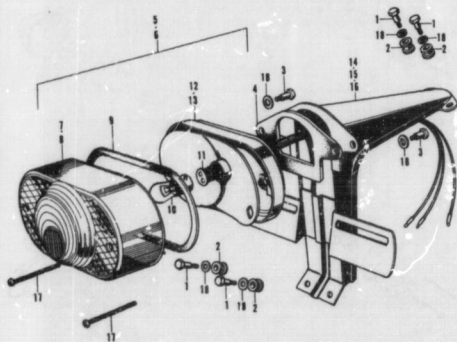

Ref. No.	Part No.	Description	Repl. No.	No. Used on	
			15 1242 06 F4 II	From	To
1	90162-292-000	BOLT, front fender setting	4	-	
2	84705-292-000	RUBBER, number basket cushion	4	-	
3	90165-291-000	BOLT, tail light set	2	-	
4	33719-290-000	PACKING, tail light base	1	-	
5	33700-292-013	LIGHT ASSY, tail	1	-	
6	33700-290-430	LIGHT ASSY, tail (Used in France)	1	-	CB40 -3001800
7	33701-041-671	LENS, tail light	1	-	
8	33701-041-610	LENS, tail light (Used in France)	1	-	CB40 -3001800
9	33709-041-000	PACKING, tail light lens	1	-	
10	94906-298-600	BULB stop & tail light (12V 23/7W)	1	-	
11	33707-292-013	CORD, tail light	1	-	
12	33702-292-003	BASE COMP., tail light	1	-	
13	33702-292-420*	BASE COMP., tail light	1	-	CB40 -3001800
14	84701-292-020B	BRACKET, number plate (Black) (Used in General & Australia)	1	-	
	84701-292-020Z	BRACKET, number plate (Non sanding) (Used in General & Australia)	1	-	
15	84701-292-470B	BRACKET, number plate (Black) (Used in U.S.A.)	1	-	-3000015
	84701-292-470Z	BRACKET, number plate (Non sanding) (Used in U.S.A.)	1	-	-3000015
16	84701-292-790B	BRACKET, number plate (Black) (Used in France)	1	-	
	84701-292-790Z	BRACKET, number plate (Non sanding) (Used in France)	1	-	
17	92600-04045-08	SCREW, pan, 4 x 45	2	-	
18	94101-06200	WASHER, plain, 8 mm	6	-	

* Tail light under F-15 (Z) Mark for U.S.A. model are commonly used on the model from serial No. CB40-300015.

F-1a (2) Tail Light
(Used in U.S.A.)

F 5

F-15 (2) Tail Light
(Used in U.S.A.)

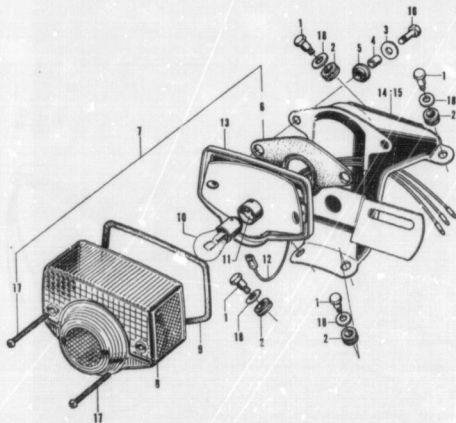

Ref. No.	Part No.	Description	Ref. No.		No. Used on	
			11' 1408	48' 74 g	From	To
1	90163-292-000	BOLT, front fender setting	4	4	CB450	-3000016
2	84705-292-000	RUBBER, number bracket cushion	4	4	CB450	-3000015
3	90581-831-600	WASHER, 18mm	2	2	CB450	-3000016
4	84706-286-000	COLLAR, number bracket set	4	4	CB450	-3000016
5	33719-077-671	PACKING R, tail light base	2	2	CB450	-3000016
6	33719-292-000	PACKING, tail light base	1	1	CB450	-3000016
7	33700-292-671	LIGHT ASSY., tail	1	1	CB450	-3000016
8	33700-077-671	LENS, tail light	1	1	CB450	-3000016
9	33709-077-671	PACKING, tail light lens	1	1	CB450	-3000016
10	34900-358-810	BULB, stop & tail light (12V 21/7W)	1	1	CB450	-3000016
11	33707-292-013	CORD, tail light	1	1	CB450	-3000016
12	33708-292-470	CORD, tail light earth	1	1	CB450	-3000016
13	33703-077-671	BASE COMP., tail light	1	1	CB450	-3000016
14	84701-292-671B	BRACKET, number plate (Black)	1	-	CB450	-3000016
15	84701-292-770A	BRACKET, number plate (White)	-	1	CB450P	-3008554
16	93000-06000-0A	BOLT, hex., 5x20	2	2		
17	93000-04000-0F	SCREW, pan., 4x50	2	2		
18	94101-06300	WASHER, plain, 8mm	4	4		

F-15 (3) Toll Light
(Used in England)

F 6

F-15 (3) Toll Light
(Used in England)

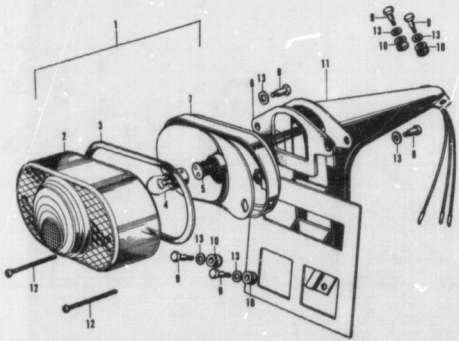

Ref. No.	Part No.	Description	Qtd. No.		No. Used on	
			15 1468	08 15 6	From	To
1	33790-292-000	LIGHT ASSY, tail	1	-		
2	33701-041-001	LENS, tail light	1	-		
3	33709-041-000	PACKING, tail light lens	1	-		
4	34006-208-810	BULB, tail & stop light (12V 23/7W)	1	-		
5	33707-292-013	CORD, tail light	1	-		
6	33719-292-000	PACKING, tail light base	1	-		
7	33702-292-003	BASE COMP., tail light	1	-		
8	90160-292-000	BOLT, tail light setting	2	-		
9	90162-292-000	BOLT, front fender setting	4	-		
10	84705-292-000	RUBBER, number plate bracket	4	-		
11	84701-292-000B	*BRACKET, number plate (Black)	1	-		
	84701-292-000Z	BRACKET, number plate (Non sanding) ...	1	-		
12	30500-04045-03	SCREW, pan, 4 x 45	2	-		
13	94101-08200	WASHER, plain, 8 mm	6	-		

F 7

F-15 (4) Tail Light (Used in Germany & Sweden)

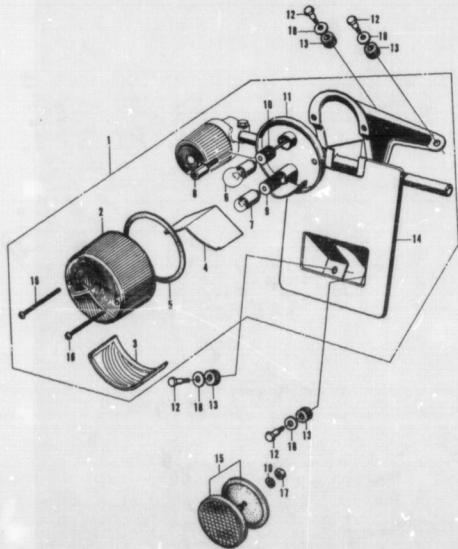

113

F-15 (4) Tail Light (Used in Germany & Sweden)

Ref. No.	Part No.	Description	Quant. Req. in 1000	No. Used on	
				From	To
1	33700-292-610	LIGHT ASSY., tail	1	-	-
2	33701-061-000	LENS, tail & stop light	1	-	-
3	33715-061-000	LENS, license	1	-	-
4	33716-061-000	PLATE, interception	1	-	-
5	33709-061-000	PACKING, tail light	1	-	-
6		BULB, stop (12V 16W) (To be locally purchased in Germany)	1	-	-
7		BULB, tail light (To be locally purchased in Germany)	2	-	-
8	33717-292-610	BOLT, tail light setting	1	-	-
9	33707-292-610	CORD, tail	1	-	-
10	33706-292-610	CORD, stop	1	-	-
11	33710-292-610	SOCKET COMP., tail light	4	-	-
12	90142-292-000	BOLT, front fender setting	1	-	-
13	34705-292-000	RUBBER, number plate bracket	4	-	-
14	84701-292-610B	BRACKET, number plate (Back)	1	-	-
	84701-292-610Z	BRACKET, number plate (Non standing)	1	-	-
15	33741-292-610	REFLECTOR ASSY., reflex	1	-	-
16	93600-00045-00	SCREW, pan, 3x45	2	-	-
17	94000-00000-05	NUT, hex., 5 mm	1	-	-
18	94105-00200	WASHER, plain, 8 mm	4	-	-
19	94111-00000	WASHER, w-ring, 5 mm	1	-	-

112

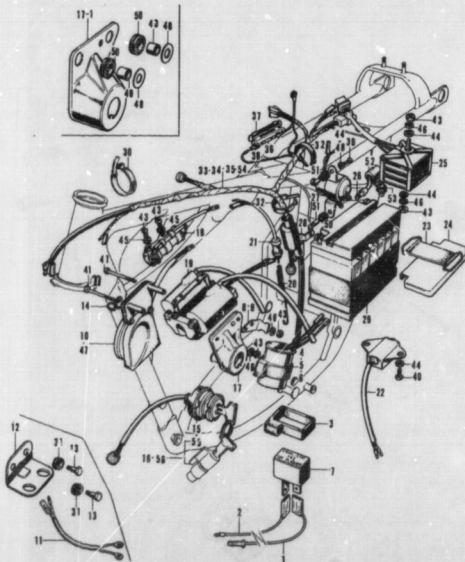

Ref. No.	Qty. No.	Description	Repl. No. 13 1449 28 71 11	No. Used on	
				From	To
1	300-290-670	SUB CORD A, winker relay (Used in U.S.A.)	1 -		300029
	30004-240-670	SUB CORD A, winker relay (Used in U.S.A.)	1	CB450-3000630	
2	30005-290-670	SUB CORD B, winker relay (Used in U.S.A.)	1 -		300029
	30009-243-670	SUB CORD B, winker relay (Used in U.S.A.)	1	CB450-3000630	
3	30006-290-670	SUSPENSION, winker relay (Used in U.S.A.)	1		1
4	30000-290-028	RELAY ASSY, winker (Used in General & France)	1 -		300029
	30000-290-028	RELAY ASSY, winker (Used in General, France & Australia)	1 -	CB450-3000630	
5	30000-290-600	RELAY ASSY, winker (Used in England)	1 -		300029
	30000-290-601	RELAY ASSY, winker (Used in England)	1 -	CB450-3000630	
6	30000-290-610	RELAY ASSY, winker (Used in Germany)	1 -		300029
	30000-290-611	RELAY ASSY, winker (Used in Germany & Sweden)	1 -	CB450-3000630	
		Part No. 30000-290-601 (Ref. No. 5-1) is used on all Sweden export models with serial No. CB450-300776.			
7	30000-290-670	RELAY ASSY, winker (Used in U.S.A.)	1 -		
8	30001-290-000	STAY, winker relay	1 -		300029
	30001-290-010	STAY, winker relay	1 -	CB450-3000630	
9	30001-290-670	STAY, winker relay (Used in U.S.A.)	1 -		300029
	30001-290-671	STAY, winker relay (Used in U.S.A.)	1 -	CB450-3000630-3001133	
	30001-290-672	STAY, winker relay (Used in U.S.A.)	1	CB450-3001174	
10	30100-290-004	HORN ASSY., (MITSUBA)			
		(Superseded by 30100-286-014)			
	30100-286-014	HORN ASSY., (MITSUBA)	1		1
11	30101-283-620	CORD, horn (Used in France)			
		(Discontinue sales)			
12	30102-283-620	STAY, horn (Used in France)			
		(Discontinue sales)			
13	30106-011-621	SCREW, horn setting (Used in France)			
		(Discontinue sales)			
14	50402-283-000	GRIP, tachometer cable	1 -		
15	35100-290-013	SWITCH ASSY., combination (T.E.C.)	1 -		
16	30010-290-013	SWITCH KIT, combination (T.E.C.)	1 -		
17	50375-290-010B	BRACKET, main switch (Black)	1 -		300133
	50375-290-010Z	BRACKET, main switch (Non sending)	1 -		
17-1	50375-290-020B	BRACKET, main switch (Black)	1 -	CB450-3001134	

F-16 Wire Harness - Battery

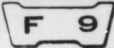

F-16 Wire Harness - Battery

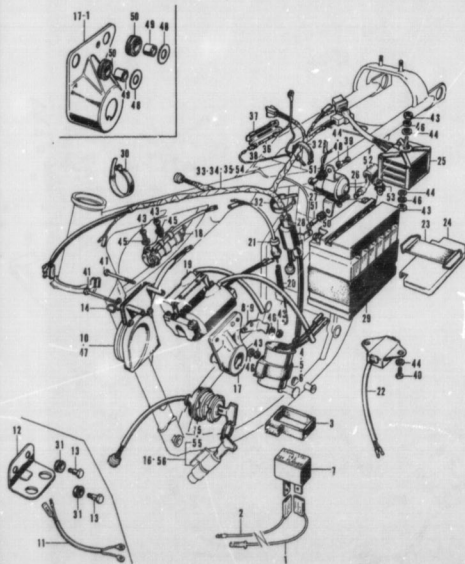

Ref. No.	Part No.	Description	Repl. No. 48 1148 48 71 2	No. Used on	
				From	To
	5075-292-6202	BRACKET, main switch (Non sanding).....	1	-	CB400-3003134
	5075-292-620A	BRACKET, main switch (White).....	1	-	CB450P-300652
18	30380-292-671	CONDENSER COMP. (KOKUSAN).....	1	1	
	30380-292-672	CONDENSER COMP. (T.E.C.).....	1	1	
19	30500-292-670	COIL ASSY., ignition (DENSO).....	1	1	
	(Superseded by 30500-292-671 or 30500-292-672)				
	30500-292-671	COIL ASSY., ignition (KOKUSAN).....	1	1	
	30500-292-672	COIL ASSY., ignition (T.E.C.).....	1	1	
20	36537-292-610	SPRING, stop switch.....	1	1	
21	36580-292-670	SWITCH ASSY., stop.....	1	1	
22	31450-292-670	REGULATOR, poleless.....	1	1	
23	83631-293-610	BAND, battery.....	1	1	
24	31512-292-000	COVER, battery.....	1	-	-3006872
	31512-292-610	COVER, battery.....	1	1	CB400-3006873
25	31790-292-008	RECTIFIER ASSY., selenium (SHINDENGEN) ²	1	1	
26	32401-292-000	CABLE, starter battery.....	1	1	
27	30650-292-007	SWITCH, stop, electromagnetic.....	1	1	
	(Superseded by 30650-292-007)				
	30650-292-017	SWITCH, stop, electromagnetic.....	1	1	
28	30561-292-000	CABLE, battery.....	1	1	
29	31500-292-670	BATTERY ASSY., 12AH.....	1	1	
	(Used in Sweden)				
	31500-292-730	BATTERY ASSY., (Used in Sweden).....	1	-	CB400-3021592
30	32983-298-000	BAND A, wire harness.....	1	1	CB400-3001083-3021591
31	32984-291-620	GROMMET, horn (Used in France).....	1	1	
	(Discontinue sales)				
32	32162-293-000	BAND B, wire harness.....	3	3	
33	32100-292-000	HARNES, wire (Used in General & Australia).....	1	-	
34	32100-292-600	HARNES, wire.....	1	-	
35	32100-292-671	HARNES, wire.....	1	-	
	(Superseded by 32100-292-672)				
	32100-292-672	HARNES, wire (Used in U.S.A.).....	1	-	
36	38201-290-000	FUSE (15A).....	4	4	
	(Including 3 fuses as spare parts)				
37	32111-230-000	CASE, fuse connector.....	1	1	
38	32112-230-000	CONNECTOR, fuse.....	2	2	
39	93300-06008	BOLT, hex., 6x8.....	2	-	

F-20 Optional Part

G 1

F-20 Optional Part

A

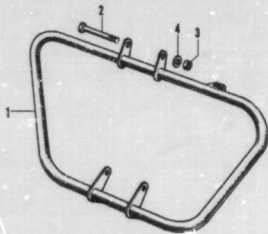

B

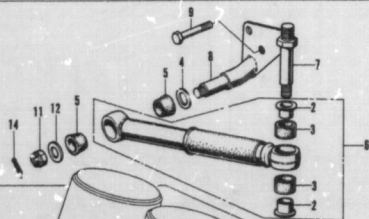

C

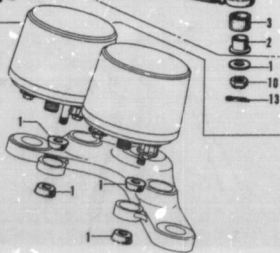

Ref. No.	Part No.	Description	Ref. No.		No. Used on
			81	81B	
A 1	62501-00-810	BUMPER, front	1		-
2	29000-08073-0A	BOLT, hex., 8x72	1		-
3	94001-08000-0S	NUT, hex., 8mm	1		-
4	94101-06200	WASHER, flat, 8mm	1		-
B 1	90221-200-810	WASHER, 6mm	1		-
2	53700-200-810	BUSH, damper rod end	2		-
3	53700-200-810	BUSH, rubber	2		-
4	90219-200-810	WASHER, 11mm	1		-
5	53731-200-810	RUBBER, damper joint	2		-
6	53700-273-000	DAMPER, steering	1		-
7	53004-200-812	PIN, steering damper	1		-
8	53773-204-810	STAY, steering damper	1		-
9	50000-00040	Ex.J.T., hex., 6x40	1		-
10	94011-00000-0S	NUT, slotted, 6mm	1		-
11	94011-08000-0S	NUT, slotted, 8mm	1		-
12	94101-08000	WASHER, plain, 8mm	1		-
13	94301-1.150	PIN, cotter, 1.2x15	1		-
14	94301-20180	PIN, cotter, 2x18	1		-
C 1	53336-200-306	COLLER, meter setting	4		-

F-21 Handle
(Palote Type)

G 2

F-21 Handle
(Palote Type)

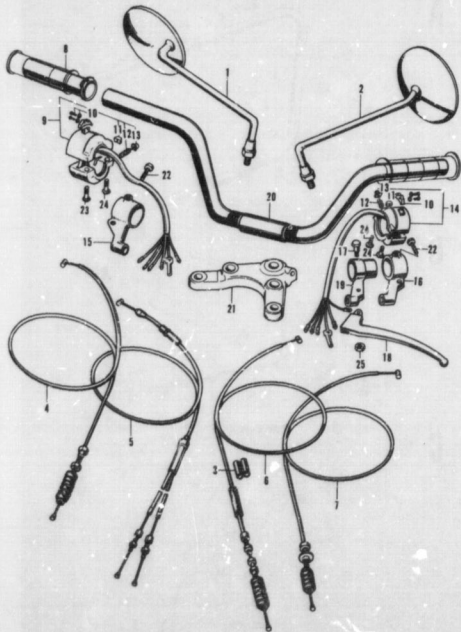

Ref. No.	Part No.	Description	Expl. No.		No. Used on	
			13 1428 26 74 8	From	To	
1	88110-283-010	MIRROR, right back	-	1	CB450P-3008524	
2	88120-283-010	MIRROR, left back	-	2	CB450P-3008524	
3	45455-270-000	CLIP, front brake wire	-	2	CB450P-3008524	
4	45450-292-770	CABLE COMP., front brake	-	1	CB450P-3008524	
5	17910-292-790	CABLE COMP., throttle	-	1	CB450P-3008524-3015399	
	17910-292-731	CABLE COMP., throttle	-	1	CB450P-3015400	
6	22870-292-790	CABLE COMP., clutch	-	1	CB450P-3008524	
7	88460-292-790	CABLE COMP., siren friction drum	-	1	CB450P-3008524	
8	53141-305-000	PIPE, throttle grip	-	1	CB450P-3008524-3015388	
	53141-249-000	PIPE, throttle grip	-	1	CB450P-3015400	
9	30900-292-771	SWITCH ASSY., dimmer starter patrol	-	1	CB450P-3008524-3015399	
	30900-292-771	SWITCH ASSY., dimmer starter patrol	-	1	CB450P-3015400	
10	35316-292-300	KNOB, horn button	-	2	CB450P-3008524	
11	35216-292-790	KNOB, speedometer stop switch	-	2	CB450P-3008524	
12	35315-292-000	SPRING, push button	-	2	CB450P-3008524	
13	35317-292-300	BUTTON, horn button push	-	2	CB450P-3008524	
14	30300-292-771	SWITCH ASSY., horn winker speedometer stop	-	1	CB450P-3008524	
15	53171-283-000	BRACKET, right handle lever (Superseded by 53171-283-010)	-	1	CB450P-3008524	
	53171-283-010	BRACKET, right handle lever	-	1	CB450P-3008524	
16	53172-283-000	BRACKET, left handle lever	-	1	CB450P-3008524	
17	90114-001-000	SCREW, handle lever pivot	-	1	CB450P-3008524	
18	53178-035-000	LEVER, left steering handle (for siren)	-	1	CB450P-3008524-3015399	
	53178-292-790	LEVER, left steering handle (for siren)	-	1	CB450P-3015400	
19	88471-283-010	BRACKET, siren handle lever	-	1	CB450P-3008524	
20	53100-285-000	PIPE, steering handle	-	1	CB450P-3008524	
21	53230-292-790	BRIDGE, fork top	-	1	CB450P-3008524-3008955	
	53230-292-781	BRIDGE, fork top	-	1	CB450P-3008956	
22	93000-06025-08	BOLT, hex, 6x25	-	2		
23	93000-06014-0A	SCREW, pan, 5x14	-	1		
24	93000-06022-0A	SCREW, pan, 5x22	-	3		
25	94001-00000	NUT, hex, 6 mm	-	1		

F-22 Seat - Carrier
(Police Type)

G 3

F-22 Seat - Carrier
(Police Type)

Ref. No.	Part No.	Description	Expl. No.		No. Used on	
			11 1408	08 F2 II	From	To
1	77200-292-770A	SEAT COMP., single (flack)	-	1	CB40F-300634	
2	77104-292-700	RUBBER, wear setting	-	2	CB40F-300634	
3	81300-292-770	CARRIER COMP.	-	1	CB40F-300634	
4	93000-00016-05	BOLT, hex., 8 x 16		4		
5	94001-00000-05	NUT, hex., 7 mm		2		
6	94101-00000	WASHER, plain, 8 mm		6		

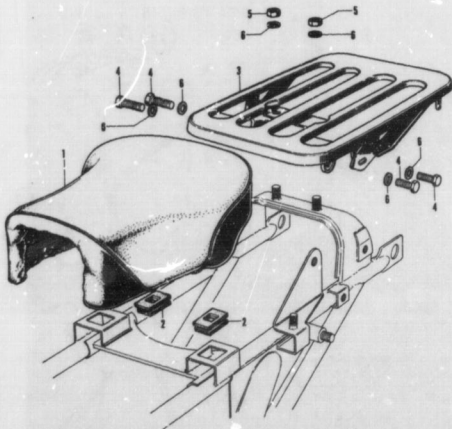

**F-23 Head Light - Speedometer
(Police Type)**

G 4

**F-23 Head Light - Speedometer
(Police Type)**

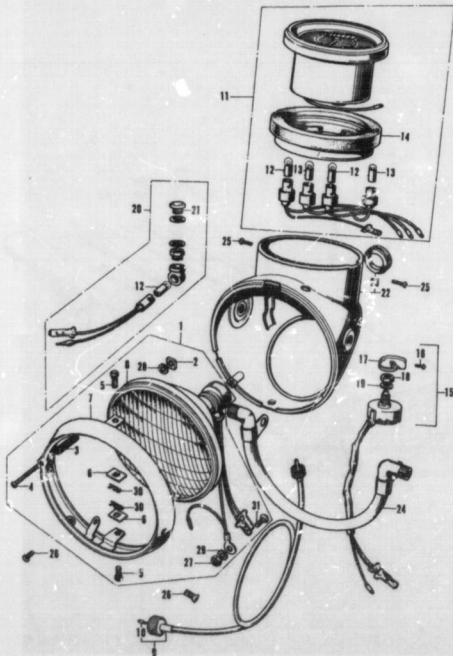

Ref. No.	Part No.	Description	Ecol. No.		No. Used on	
			41	1148	From	To
1	33100-286-672	LIGHT ASSY., head	-	1	CB450P-3008504	
2	33117-292-015	NUT, beam adjust (STANLEY)	-	1	CB450P-3008504	
3	33107-300-051	SPRING, beam adjust (STANLEY)	-	1	CB450P-3008504	
4	33120-292-002	SCREW, beam adjust (STANLEY)	-	1	CB450P-3008504	
5	33125-292-670	SCREW, unit holder, 5 mm	-	2	CB450P-3008504	
6	33128-300-030	NUT, unit holder	-	2	CB450P-3008504	
7	33101-286-670	LEM, head light	-	1	CB450P-3008504	
8	33120-292-673	FRNT, head light	-	1	CB450P-3008504	
9	44830-285-000	CABLE, ASSY., speedometer	-	1	CB450P-3008504	
10	44831-285-000	CABLE, inner	-	1	CB450P-3008504	
11	37205-292-770	SPEEDOMETER ASSY.	-	1	CB450P-3008504	
12	34805-258-000	BULB, dash (12V 3W)	-	2	CB450P-3008504	
13	34805-258-610	BULB, dash (12V 4W)	-	2	CB450P-3008504	
14	37243-292-030	PACKING, speedometer	-	1	CB450P-3008504-3015399	
	37243-292-790	PACKING, speedometer	-	1	CB450P-3015400	
15	30150-292-771	SWITCH ASSY., lighting	-	1	CB450P-3008504	
16	30154-292-751	SCREW, lighting switch setting	-	1	CB450P-3008504	
17	30151-292-751	KNOB, lighting switch	-	1	CB450P-3008504	
18	30152-292-751	NUT, lighting switch	-	1	CB450P-3008504	
19	30151-268-000	WASHER, lighting switch	-	1	CB450P-3008504	
20	37950-286-000	LAMP ASSY., beam pilot	-	1	CB450P-3008504	
21	37551-044-670	LENS, beam pilot	-	1	CB450P-3008504	
22	61301-292-770A	CASE COMP., head light (White)	-	1	CB450P-3008504	
23	61300-368-010	GROMMET, tachometer cable	-	1	CB450P-3008504	
24	86510-292-770	STAY, front winker	-	1	CB450P-3008504	
25	93900-04005-0B	SCREW, pan, 4 x 5	-	2		
26	93700-05010-0B	SCREW, oval, 5 x 10	-	2		
27	94001-03000-0A	NUT, hex, 3 mm	-	1		
28	94301-04000	WASHER, plain, 4 mm	-	1		
29	94111-03000	WASHER, spring, 3 mm	-	1		
30	94251-03000	PIN, lock, 5 mm	-	2		
21	98950-03050-0A	BOLT, slotted, 3 x 6	-	1		

G 5

F-24 Bumper
(Polee Type)

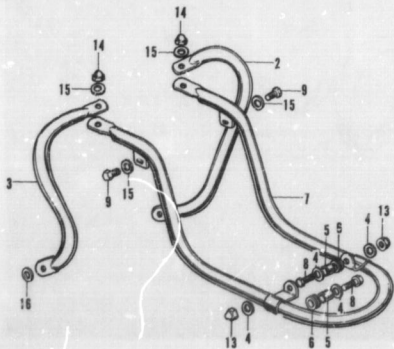
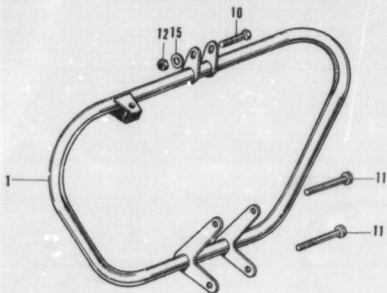

F-24 Bumper
(Polee Type)

Ref. No.	Part No.	Description	Quant. No.		No. Used on	
			41 518	42 518	From	To
1	62501-292-750	BAMPER, front	-	1		CB450P-300834
2	84151-292-751	BAMPER, right side	-	1		CB450P-300834
3	84152-292-751	BAMPER, left side	-	1		CB450P-300834
4	90081-831-600	WASHER, 18 mm	-	4		CB450P-300834
5	64005-285-000	COLLAR, number bracket set	-	2		CB450P-300834
6	84005-292-000	RUBBER, number bracket	-	2		CB450P-300834
7	84101-292-751	BAMPER, rear	-	1		CB450P-300834
8	92000-06000	BOLT, hex., 6x20	-	2		
9	94000-08016-05	BOLT, hex., 8x16	-	2		
10	92000-03072-0A	BOLT, hex., 8x72	-	1		
11	92000-10100-0A	BOLT, hex., 10x100	-	2		
12	94001-08005-05	NUT, hex., 8 mm	-	1		
13	94021-06030	NUT, cap, 6 mm	-	2		
14	94021-08030-05	NUT, cap, 8 mm	-	2		
15	94101-08200	WASHER, plain, 8 mm	-	2		
16	941C1-10300	WASHER, plain, 10 mm	-	2		

F-25 Patrol Light
(Police Type)

G 6

F-25 Patrol Light
(Police Type)

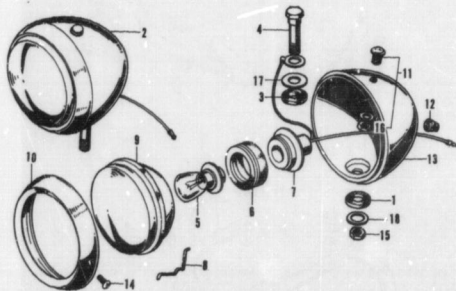

Ref. No.	Part No.	Description	Rev. No.	No. Used on	
			13 0149 09 71 g	From	To
1	34450-280-000	CUSHION B, rubber	- 2	CB450P-3008534	
2	34450-280-750A	LIGHT ASSY., patrol (White)	- 2	CB450P-3008534-3015389	
2-1	34450-280-751A	LIGHT ASSY., patrol (White)	- 2	CB450P-3015400	
3	34457-280-000	CUSHION A, rubber	- 2	CB450P-3008534	
4	34454-280-000	SPECIAL BOLT	- 2	CB450P-3008534	
5	34904-280-000	BULB, patrol light (12V 20W)	- 2	CB450P-3008534	
6	34452-280-700	HOLDER, socket	- 2	CB450P-3008534	
7	34456-280-700	SOCKET, patrol light	- 2	CB450P-3008534	
8	35106-268-000	SPRING, head light set	- 4	CB450P-3008534	
9	34453-280-000	UNIT, patrol light	- 2	CB450P-3008534-3015389	
10	34453-280-781	UNIT, patrol light	- 2	CB450P-3015400	
10	34451-280-010	KIM, patrol light	- 2	CB450P-300874	
11	37551-280-750	LENS, patrol light (jilet)	- 2	CB450P-3008534	
12	34456-280-000	GROMMET, read wire	- 2	CB450P-3008534	
13	34459-280-000A	CASE COMP., patrol light (White)	- 2	CB450P-3008534	
14	35709-05010-0B	SCREW, oval, 5 x 10	- 2		
15	94021-10000-05	NUT, hex., 10 mm	- 2		
16	94002-10000-05	NUT, thin, 10 mm	- 2		
17	94101-13000	WASHER, plain, 12 mm	- 2		
18	94111-10000	WASHER, spring, 10 mm	- 2		

F-26 Siren
(Police Type)

G 7

F-26 Siren
(Police Type)

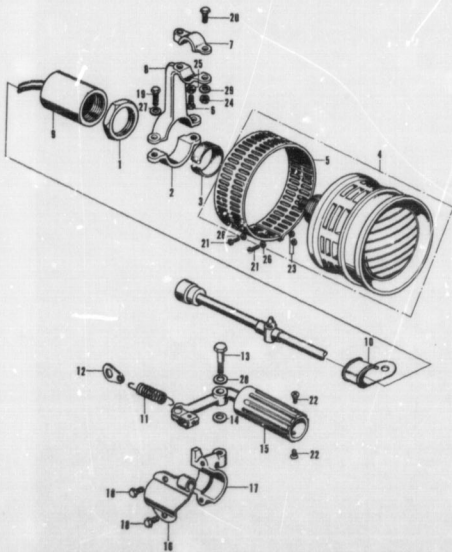

Part No.	Description	No. Used on	
		CB 460P-300834	CB 460P-300834
1 90322-285-000	NUT, siren cable fixing	- 1	CB460P-300834
2 88435-285-300	(Part No. change)		
3 88435-292-750	HOLDER, siren fixing bracket	- 1	CB460P-300834
4 88435-285-000	RUBBER, siren shock mount	- 1	CB460P-300834
5 88435-285-000	SIREN ASSY.	- 1	CB460P-300834
6 88435-235-000	COVER, siren	- 1	CB460P-300834
7 90163-285-000	BOLT, siren fixing piece	- 1	CB460P-300834
8 88431-285-000	PIECE, siren fixing	- 1	CB460P-300834
9 88401-285-300	(Part No. change)		
10 88433-282-750	BRACKET, siren fixing	- 1	CB460P-300834
11 88433-292-750	CABLE COMP., siren	- 1	CB460P-300834
12 88432-285-000	CLAMPER, siren cable	- 1	CB460P-300834
13 88466-292-750	SPRING, friction drum	- 1	CB460P-300834
14 88467-282-750	HOOK, spring	- 1	CB 300-300834
15 90166-292-751	SPECIAL BOLT, 8 mm	- 1	CB460P-300834
16 90485-035-000	WASHER, 16mm	- 1	CB460P-300834
17 88430-292-751	DRUM COMP., siren friction	- 1	CB460P-300834
18 88433-292-750	BRACKET B, friction drum	- 1	CB460P-300834
19 88432-285-700A	BRACKET A, friction drum	- 1	CB460P-300834
20 92000-00016	BOLT, hex, 6x16	- 2	
21 92000-00108	BOLT, hex, 6x18	- 2	
22 92000-00022	BOLT, hex, 6x22	- 1	
23 92000-04008-08	SCREW, pan, 4x8	- 2	
24 92700-00008-0A	SCREW, oval 5x8	- 2	
25 94001-04000-05	NUT, hex, 4 mm	- 2	
26 94001-06000	NUT, hex, 6 mm	- 1	
27 94002-00000	NUT, thin, 6 mm	- 1	
28 94101-04000	WASHER, plain, 4 mm	- 2	
29 94101-06000	WASHER, plain, 6 mm	- 2	
30 94102-10000	WASHER, plain, 10 mm	- 1	
31 94111-06000	WASHER, spring, 6 mm	- 1	